

CHISWICK PARK
#LONDON W4

THE VERY LITTLE

BOOK

OF
BIG B9

BIG IDEAS

BIG AMBITIONS

BIG IMPACT



CULTIVATE YOUR BRIGHTEST + BOLDEST AT

CHISWICK PARK
#LONDON W4

BIG SPACE

BIG YOU



BUILDING 9 – WELCOME TO YOUR NEW HOME

Level 2 and 3 of Building 9 are two of the best floors in the Park. Overlooking the lake, the floors are also situated directly opposite Chiswick Park's event plaza and extensive retail offering.



12

BUILDINGS

10,000

GUESTS

9

**GLOBAL
HEADQUARTERS**

33

ACRES

1.8

MILLION SQ. FT

15

**EUROPEAN
HEADQUARTERS**



PIONEERING AND PERFECTING SUSTAINABLE WORKSPACE



TEAM

ENJOY-WORK ARE COMMITTED TO CONSTANTLY EVOLVING SUSTAINABLE WORKSPACE FOR ALL GUESTS



100%

GREEN WASTE RECYCLED EACH YEAR



ELECTRIC

CAR CHARGING POINTS



WATCH

OUR ESG STORY

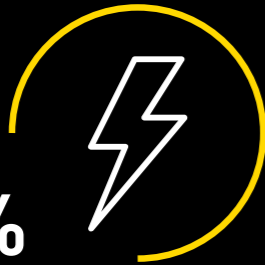

100%

OF ENERGY SOURCED FROM RENEWABLE ENERGY SUPPLIERS



1,071

TREES SAVED THROUGH RECYCLING



33

ACRES OF STUNNING LANDSCAPED GROUNDS WRAPPED AROUND A 2 TIER LAKE



18 TONNES

OF WASTE BROKEN DOWN PER DAY VIA ON-SITE WORMERY

GREAT PLACE TO WORK.
THE PARK SUPPORTS YOUR
WELLBEING, ENABLES YOU TO
LEARN AND KEEP
ACTIVE WHILST AT WORK.

DANONE

CHISWICK PARK #ENJOY-WORK

The on-site Enjoy-Work team organises a wide range of activities that entertain, stimulate and engage:

- Regular events throughout the year including a **music festival**, **famous speakers**, **London's longest zip line** and **food markets**
- A focus on employee well-being including dedicated **well-being events**
- Inter-company sports leagues** including running, cycling, football, netball, basketball and volleyball
- Organised **courses** covering technical and creative skills including painting, photography, music and languages
- Comprehensive **personal development programmes** certified by the University of West London
- Onsite **concierge** service

WATCH 

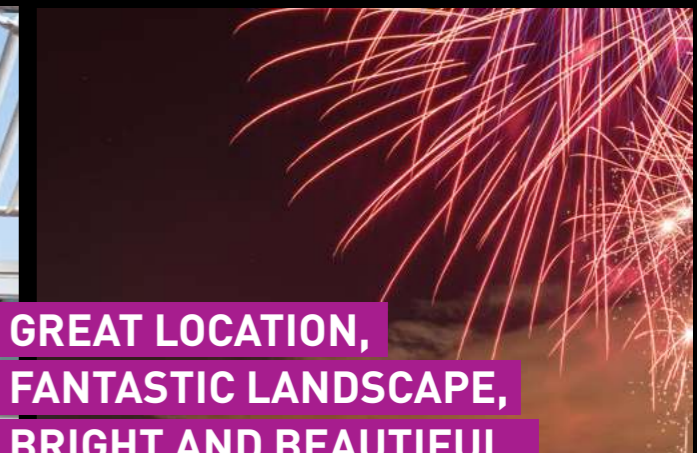

**GREAT LOCATION,
FANTASTIC LANDSCAPE,
BRIGHT AND BEAUTIFUL,
WELCOMING AND FUN
TECHNICOLOR**



**THERE'S BALANCE HERE
BETWEEN LIFESTYLE, WORK,
HOME AND THE ENVIRONMENT
DISCOVERY**



**IN EXTRAORDINARY
COMPANY**

**BECOME PART OF
AN AMAZING
SUCCESS STORY**



BRILLIANTLY CONNECTED

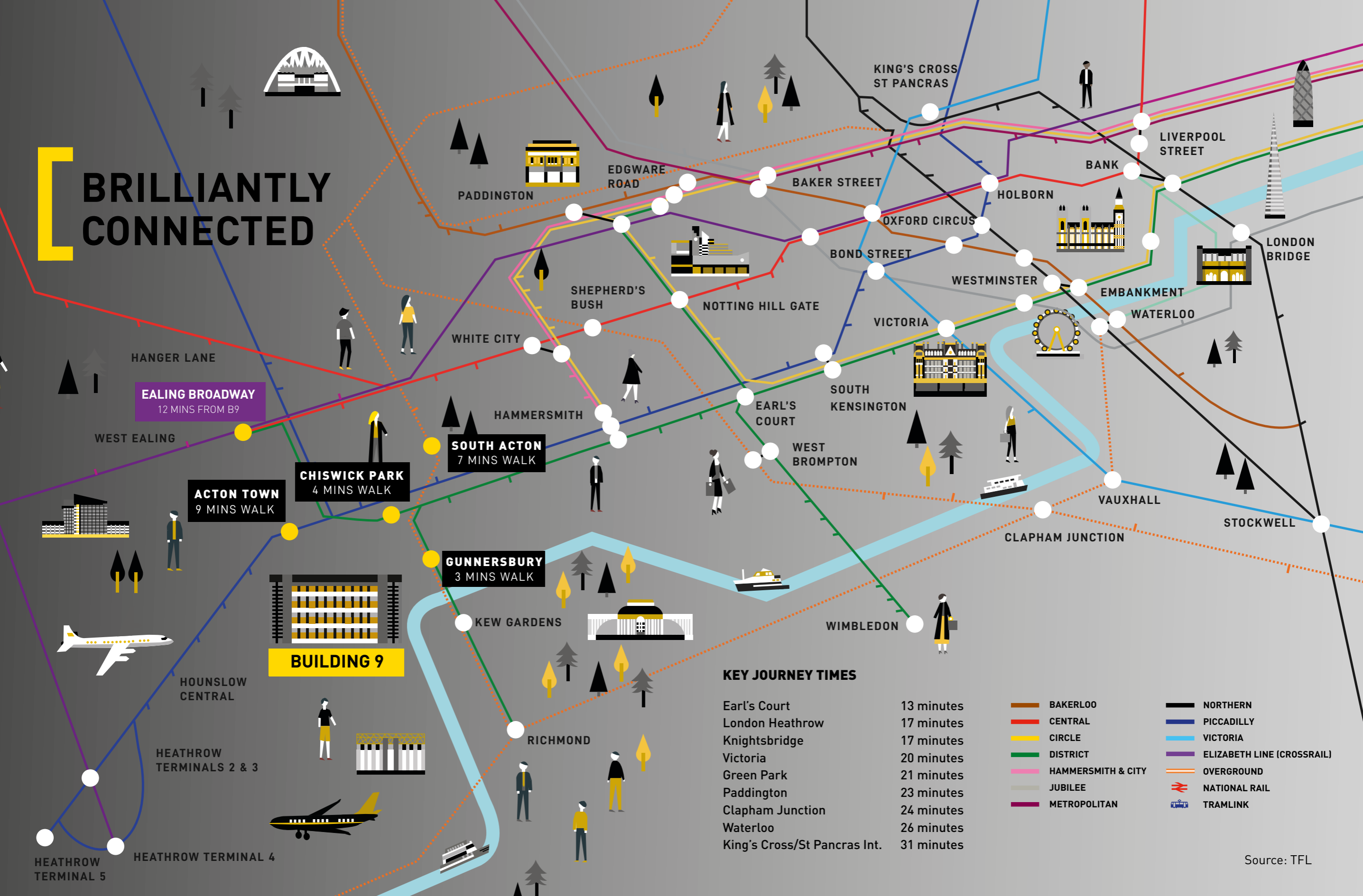

EALING BROADWAY
12 MINS FROM B9

ACTON TOWN
9 MINS WALK

CHISWICK PARK
4 MINS WALK

SOUTH ACTON
7 MINS WALK

GUNNERSBURY
3 MINS WALK

BUILDING 9

KEY JOURNEY TIMES

Earl's Court	13 minutes
London Heathrow	17 minutes
Knightsbridge	17 minutes
Victoria	20 minutes
Green Park	21 minutes
Paddington	23 minutes
Clapham Junction	24 minutes
Waterloo	26 minutes
King's Cross/St Pancras Int.	31 minutes

- BAKERLOO
- CENTRAL
- CIRCLE
- DISTRICT
- HAMMERSMITH & CITY
- JUBILEE
- METROPOLITAN
- NORTHERN
- PICCADILLY
- VICTORIA
- ELIZABETH LINE (CROSSRAIL)
- OVERGROUND
- NATIONAL RAIL
- TRAMLINK

ELIZABETH LINE

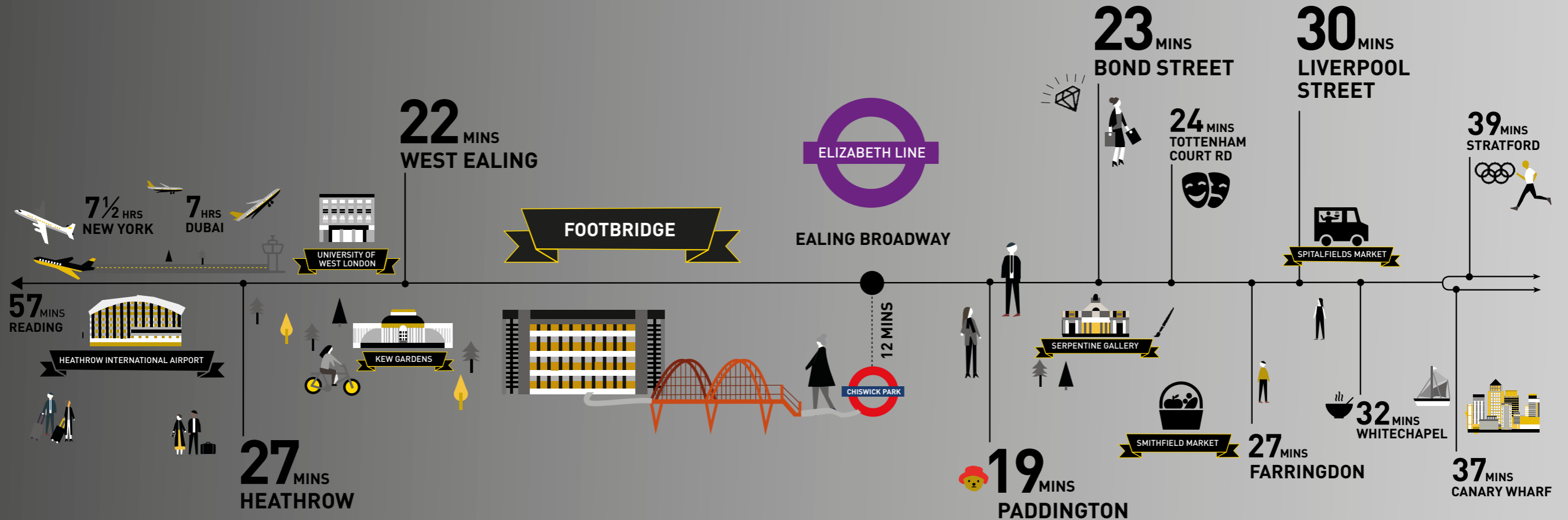

TRAVEL TIMES ARE DOOR-TO-DOOR
FROM B9 CHISWICK PARK

ELIZABETH LINE OPENING 2022

All travel times obtained from TFL, assuming a 12 minute
travel time to Ealing Broadway from Building 9



THE CAMPUS

ONSITE AMENITIES

- A** Starbucks Coffee
- B** Enjoy-Work Office
- C** Virgin Active Health Club
- D** WHSmith
- E** Go Chisou
- F** WOLF
- G** Source Food
- H** Starbucks Coffee
- I** The Union Bar & Grill
- J** ATM Machine
- K** Kafe 23
- L** Events Plaza
- M** Little Cherubs Nursery
- N** Bus Stop

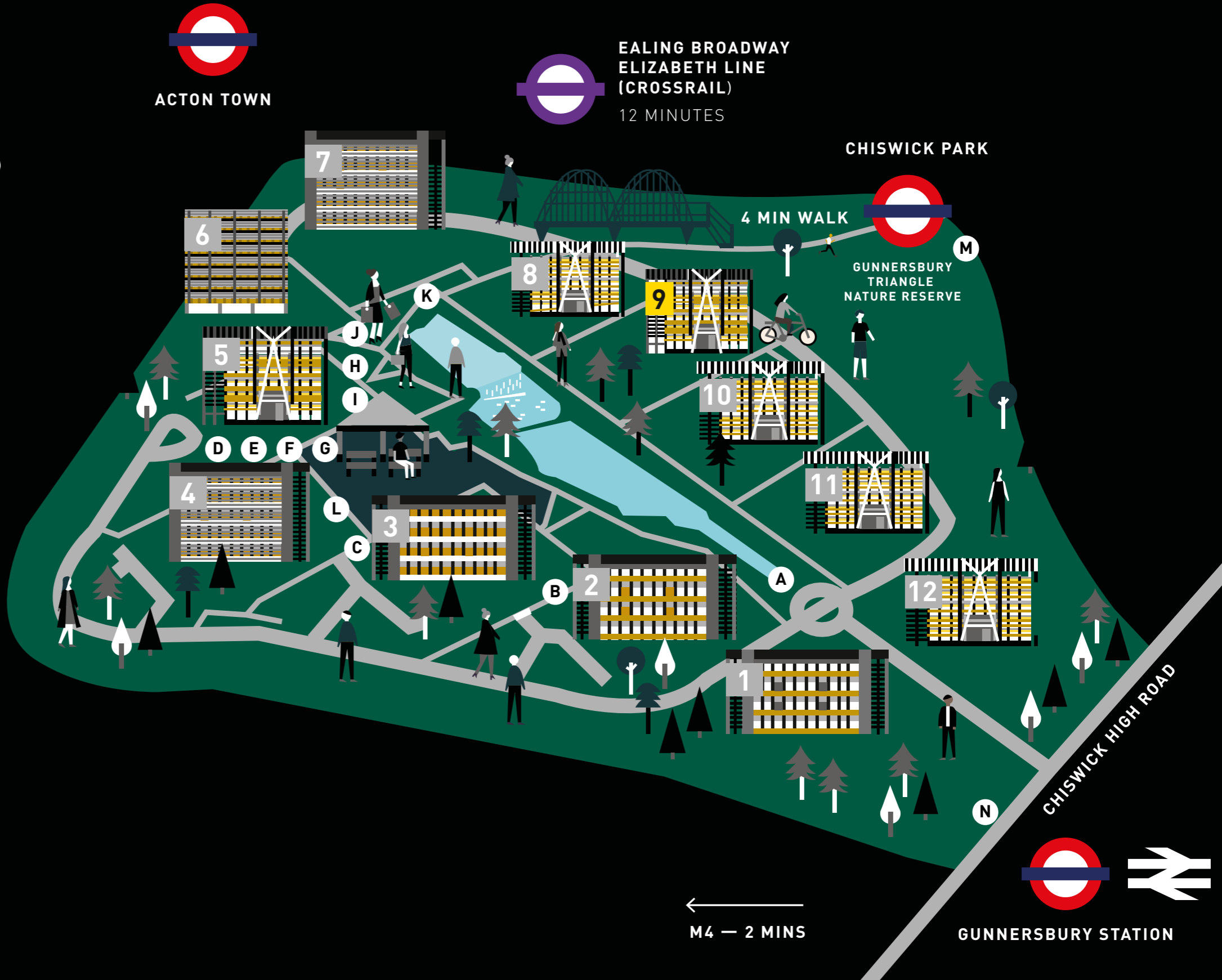

←
M4 — 2 MINS

GUNNERSBURY STATION

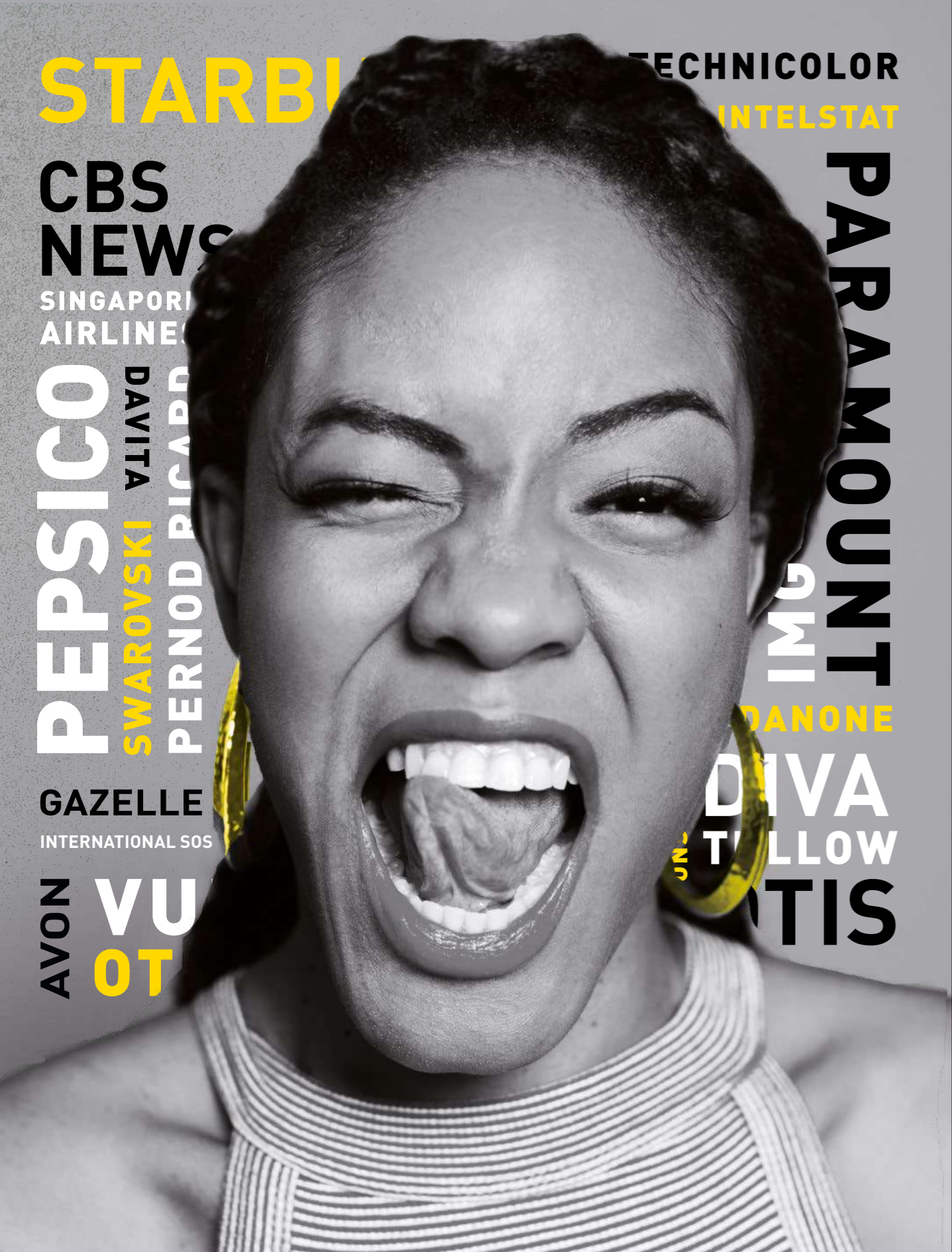

STARBUCKS

TECHNICOLOR
INTELSTAT

CBS
NEWS

SINGAPORE
AIRLINES

PEPSICO
SWAROVSKI
PERNOD RICARDO
DAVITA

GAZELLE
INTERNATIONAL SOS

AVON
VUOTI

PARAMOUNT
IMGI

DANONE

DIVA
TULLOW
TIS

BE APART OF A

BIGGER

STORY.

Chiswick Park is home to some of the world's leading companies; home to **Global, European and National headquarters**; home during the working day to **thousands of people** and to its **all-pervasive belief that if people enjoy work, they do better work** – if they do better work, you have a better business.

33,800

SQ

**PER FLOOR
AVAILABLE NOW**

2 OLYMPIC SIZED POOLS

1,034 GRAND PIANOS

250 KING SIZED BEDS

27,777 MACBOOK PROS

9,375 HAPPY DUCKS

2 PROFESSIONAL ICE HOCKEY RINKS

2,400 BATHTUBS

32.5 HOUSES

WHAT DOES 33,800 SQ FT LOOK LIKE?

2,400 BATHTUBS

11 TENNIS COURTS

1,050 ELEPHANTS

717 BILLBOARDS

75 APPLE TREES IN FULL BLOOM

30,000 12" PIZZAS

30 BOWLING ALLEYS

54 LONDON BUSES

STEP INTO VIRTUAL B9!



CLICK HERE
TO ACTIVATE
IN BROWSER

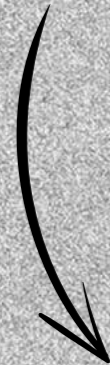



INVITING AND DYNAMIC NEW RECEPTION





**BREAKOUT SPACE
FOR YOU AND
YOUR GUESTS**



**A HIGHLY FLEXIBLE
SPACE TO SUIT
YOUR NEEDS**



BUILDING 9

2ND FLOOR

33,849 SQ FT

Measured on an NIA basis in accordance with the RICS Property Measurement (2nd Edition, January 2018) professional statement.

CAT A
VIRTUAL TOUR

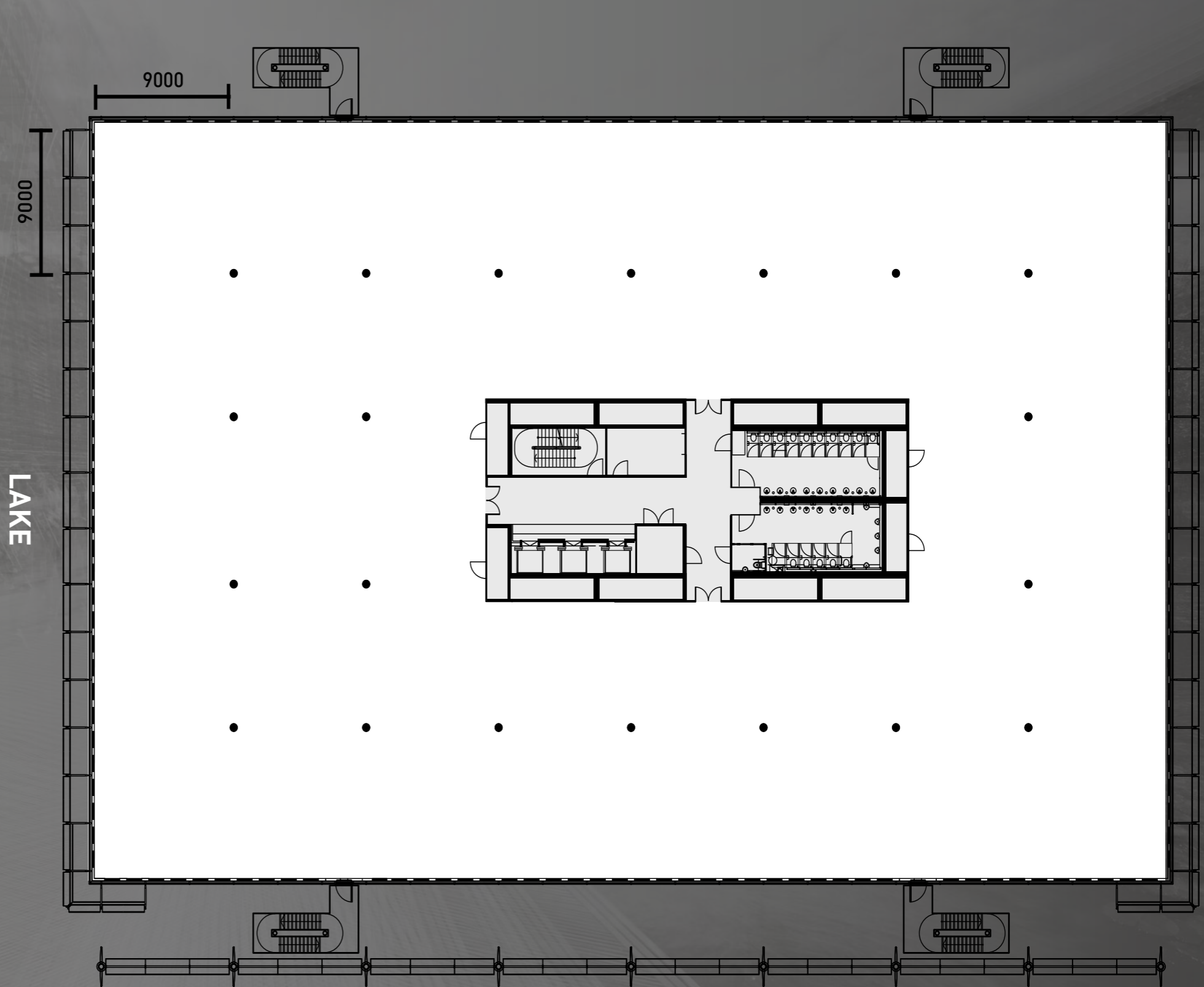



BUILDING 9

3RD FLOOR

33,841 SQ FT

Measured on an NIA basis in accordance with the RICS Property Measurement (2nd Edition, January 2018) professional statement.

CAT A
VIRTUAL TOUR

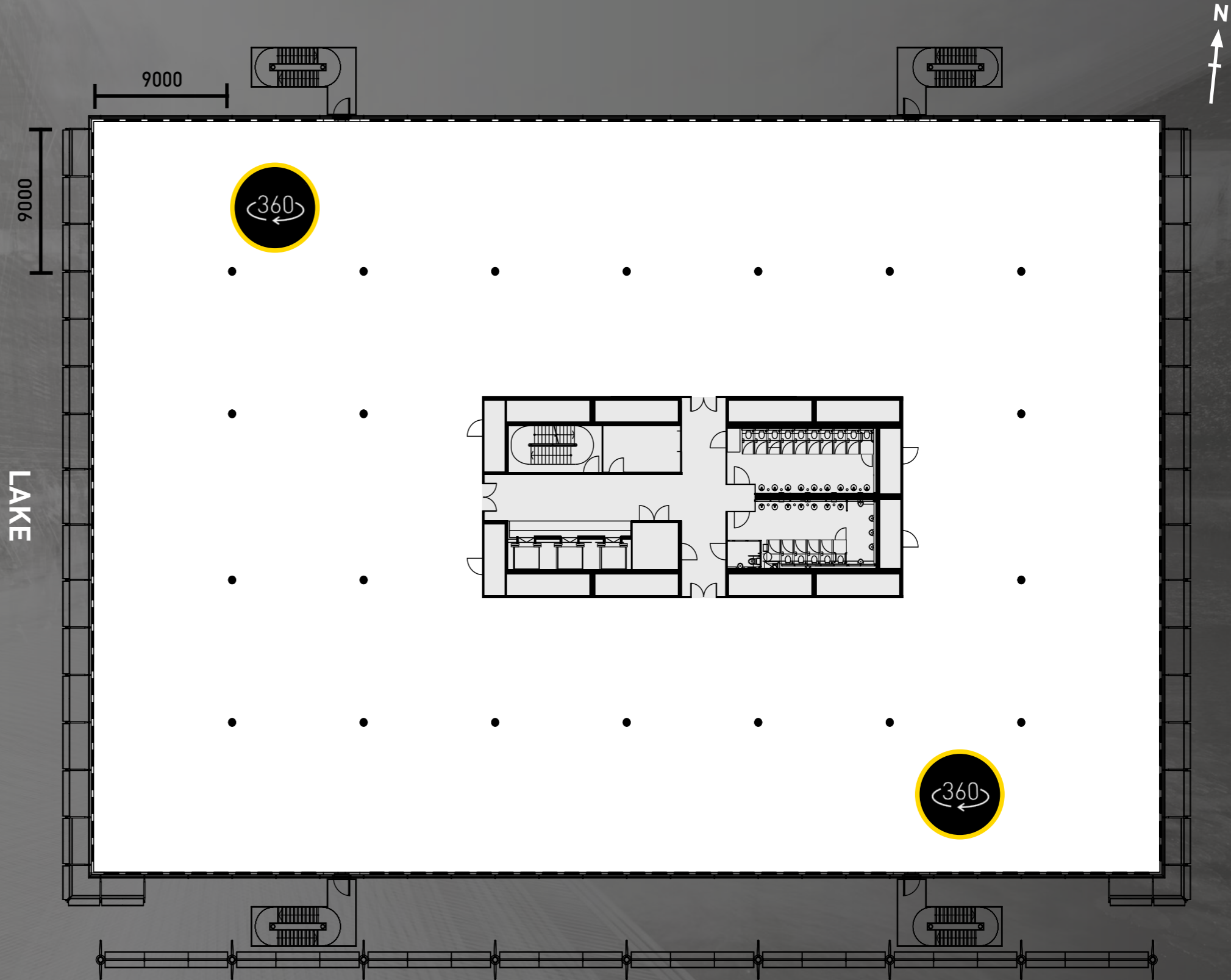

An indicative fit-out view

A wide-angle photograph of a modern office interior. The space is bright and airy, featuring large windows that offer a view of greenery outside. The office is furnished with light-colored wooden desks and white A-frame legs. Several people are seen working at their desks, some using computers. In the foreground, a man in a white shirt is seated at a desk, looking towards the camera. In the background, a man and a woman are standing and talking near a large potted plant. To the right, there is a meeting area with a round table and orange chairs. The ceiling is made of wood and has recessed lighting. The floor is a light-colored carpet with circular vents.

**YOUR SPACE
YOUR FIT-OUT**

STANDARD BUILDING SPECIFICATIONS



FLOOR TO CEILING HEIGHT



RAISED FLOOR VOID



FULL HEIGHT GLAZING



AIR DISPLACEMENT A/C



1:10 SQM OCCUPATION DENSITY



ON SITE CONCIERGE AND 24 HOURS SECURITY

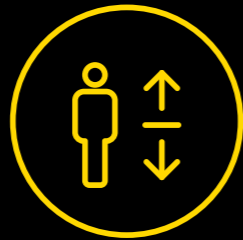

3 X 16 PERSON PASSENGER LIFTS



UNDERCROFT BICYCLE RACKS

CHISWICK PARK
#ENJOY-WORK

YEAR ROUND CALENDAR OF EVENTS



SHOWERS AND CHANGING FACILITIES

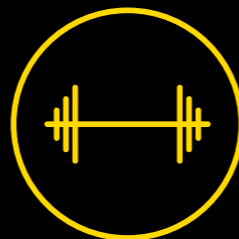

40,000 SQ.FT ON SITE VIRGIN ACTIVE GYM



AWARD WINNING ON SITE MANAGEMENT TEAM



CAR PARKING 1:4,000



EPC RATING B9 - C



WIRED SCORE CERTIFIED GOLD

An indicative fit-out view

**JOIN US FOR
A PRESENTATION**

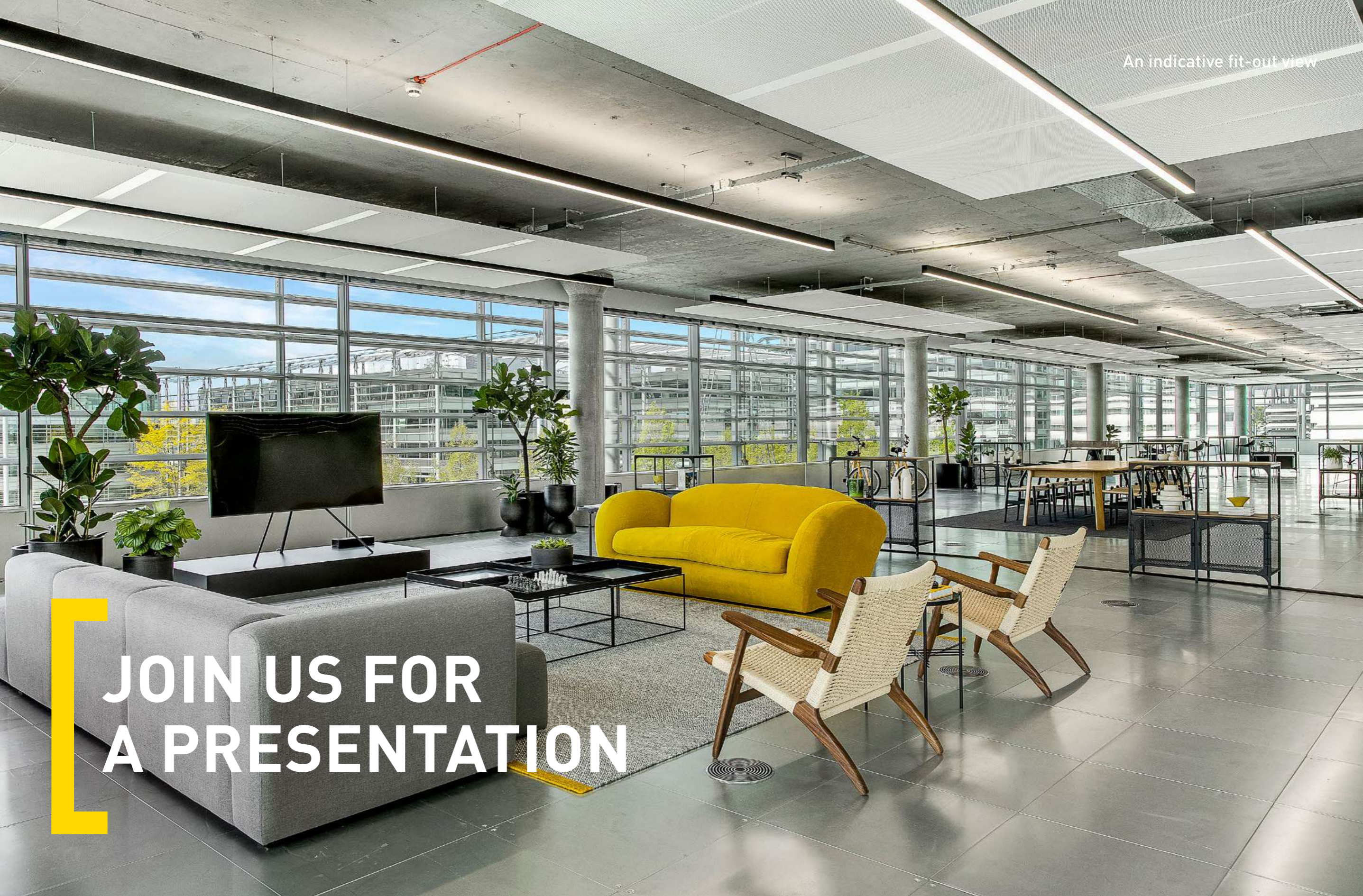



THE CHISWICK PARK TEAM ARE GREAT,
AND HAVE BEEN KEEPING US SAFE
SINCE RETURNING TO WORK.'

A GUEST FROM FOXTONS



B BIG
B BOLD
B BRAVE
B BRIGHT
B BRILLIANT
B BEAUTIFUL
B @ CHISWICK PARK

CHISWICK PARK #LONDON W4

DTRE

JOHNNY BRAY

T: 020 3328 9098
M: 07946 502 907
E: johnny.bray@dtre.eu

HANNAH DAVIES

T: 020 3328 9108
M: 07501 323 734
E: hannah.davies@dtre.eu



EMMA GOODFORD

T: 020 7861 1144
M: 07831 581 258
E: emma.goodford@knightfrank.com

WILLIAM FOSTER

T: 020 7861 1191
M: 07748 985 951
E: william.foster@knightfrank.com

JACK RILEY

T: 020 7861 5375
M: 07867 002 484
E: jack.riley@knightfrank.com

FRANCESCA SKINNER

T: 020 3967 7095
M: 07866 191 140
E: francesca.skinner@knightfrank.com

ENJOY-WORK.COM

The agents advise that these particulars do not form part of an offer or contract and are intended for general guidance purposes only. They have been prepared from information supplied to us and interested parties should satisfy themselves as to the accuracy of the floor plans, tenancy details, etc. and whether the premises are fit for purpose before entering into a contract. All prices and rents are exclusive of VAT and the property is offered subject to contract. Q2 2021.