

Flat 21, St. Andrews Court St.  
Andrews Street  
Northampton  
NN1 2HH

£140,000



OSCAR JAMES

...expect excellence

# FLOOR PLANS

GROUND FLOOR  
557 sq.ft. (51.8 sq.m.) approx.

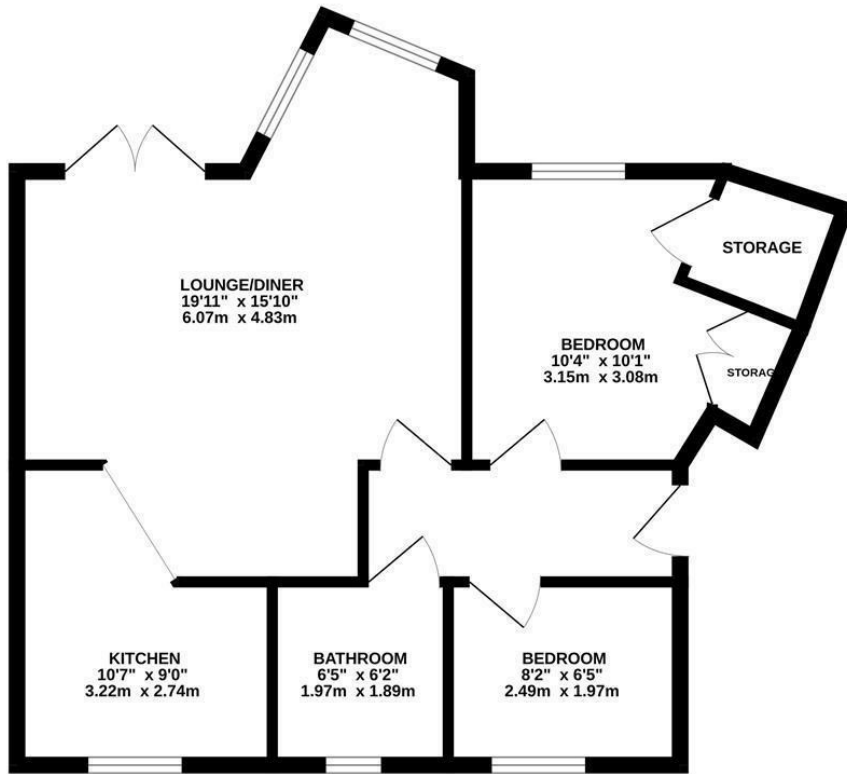

TOTAL FLOOR AREA: 557 sq.ft. (51.8 sq.m.) approx.  
Whilst every attempt has been made to ensure the accuracy of the floorplan contained here, measurements of doors, windows, rooms and any other items are approximate and no responsibility is taken for any error, omission or mis-statement. This plan is for illustrative purposes only and should be used as such by any prospective purchaser. The services, systems and appliances shown have not been tested and no guarantee as to their operability or efficiency can be given.  
Made with Metropix ©2024.



## AT A GLANCE...



custom text 1



custom text 4



custom text 2



custom text 5



custom text 3



custom text 6



# WHAT'S GREAT?

\*\*\*VACANT NO CHAIN\*\*\*

investment.

This ground floor apartment is offered to the market with no upper chain and ideally situated in Northampton town centre within walking distance to the Train Station!

Please call Oscar James today to arrange your viewing on 01604 622722

The secure communal entrance leads through to the flat situated on the ground floor. The entrance hall gives access to all accommodation including an open plan lounge/diner & kitchen.

There are two bedrooms where the master boasts built in wardrobes and a there is also a family bathroom comprising a three piece suite. Another huge bonus with this property is the private rear garden accessed via French doors from the lounge. Further benefits include allocated off road parking within the private car park.

This would make the perfect first time buy or buy to let as it previously served as a great

...expect excellence



# SELLER'S SECRET



*Why we like it....*

# OSCAR JAMES

336 Wellingborough Road | Northampton |  
NN1 4ES  
01604 622722  
[www.oscar-james.com](http://www.oscar-james.com)

*To buy or not to buy....*

---

---

---

---

---