

Willerby Clearwater Lodge 17
Billing Aquadrome Crow Lane
Little Billing
Northampton
NN3 9DA

£125,000



OSCAR JAMES

...expect excellence

FLOOR PLANS

GROUND FLOOR
754 sq.ft. (70.1 sq.m.) approx.

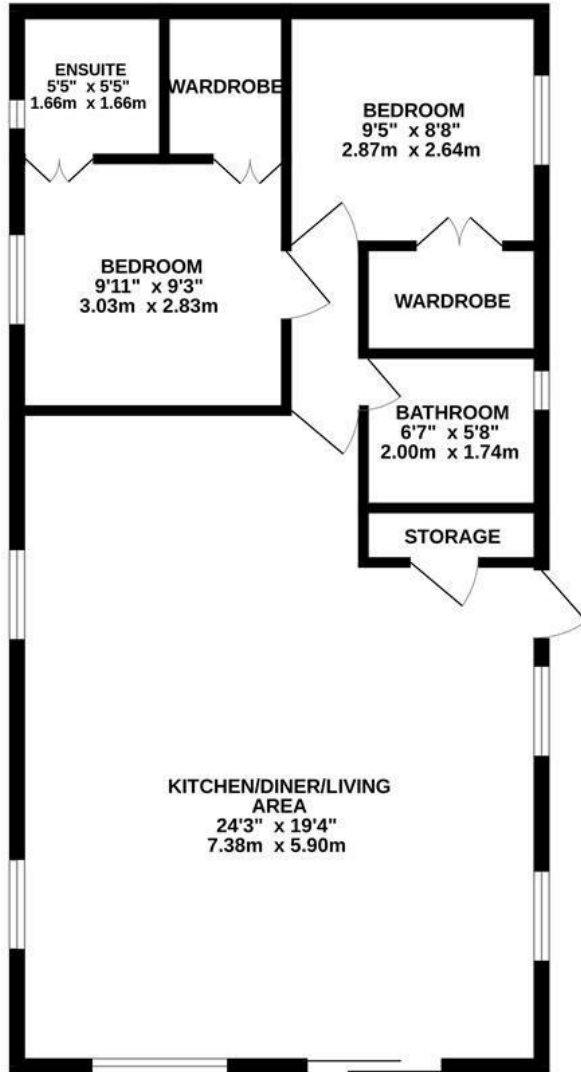

TOTAL FLOOR AREA : 754 sq.ft. (70.1 sq.m.) approx.

Whilst every attempt has been made to ensure the accuracy of the floorplan contained here, measurements of doors, windows, rooms and any other items are approximate and no responsibility is taken for any error, omission or mis-statement. This plan is for illustrative purposes only and should be used as such by any prospective purchaser. The services, systems and appliances shown have not been tested and no guarantee as to their operability or efficiency can be given.
Made with Metropix ©2023



AT A GLANCE...



custom text 1



custom text 4



custom text 2



custom text 5



custom text 3



custom text 6



WHAT'S GREAT?

GATED PRIVATE OWNERS ONLY AREA

Comfortable, elegant and beautifully laid out. At 40ft long and a full 20ft wide, this is a luxury lodge offers fantastic space throughout.

Each of the bedrooms are of great size, whilst the fabulous living area has room for two large, plush sofas, a coffee table, as well as a dining table and chairs that comfortably seat six in a separate area. Throughout the Willerby Clearwater Lodge there's also a vast amount of storage space. It all adds up to a delightfully relaxed, home from home holiday experience. And there's more – this stunning lodge comes with decking

Additional benefits include double glazing and central heating

...expect excellence



SELLER'S SECRET



Why we like it....

To buy or not to buy....

OSCAR JAMES

336 Wellingborough Road | Northampton |
NN1 4ES
01604 622722
www.oscar-james.com
