

HUNTERS[®]

HERE TO GET *you* THERE



Havering Gardens

Romford, RM6 5AL

Asking Price £625,000



Nestled in the charming Havering Gardens, Chadwell Heath, this delightful end-terrace house offers a perfect blend of comfort and convenience. With a generous living space of 1,355 square feet, this property is ideal for families seeking a welcoming home in a vibrant community.

The house boasts five well-proportioned bedrooms, providing ample space for relaxation and privacy. The large living room serves as the heart of the home, perfect for family gatherings or entertaining guests. The property features a well-appointed bathroom, ensuring that daily routines are both comfortable and efficient.

Built in 1930, this residence retains a sense of character while offering modern living conveniences. The exterior includes parking for two vehicles, a valuable asset in this bustling area. Additionally, the property benefits from a garage, providing extra storage or potential for a workshop.

Situated within the London Borough of Redbridge, this home is conveniently located near local amenities, schools, and transport links, making it an excellent choice for those commuting to central London or exploring



- LIVING ROOM 11'8" x 15'6" (3.57 x 4.73)
- DINING ROOM 10'8" x 14'2" (3.26 x 4.33)
- KITCHEN 14'5" x 9'5" (4.41 x 2.88)
- GARAGE 7'6" x 14'0" (2.29 x 4.28)
- PRIMARY BEDROOM (WITH EN-SUITE) 7'0" x 17'0" (2.14 x 5.19)
- BEDROOM 6'2" x 8'5" (1.89 x 2.59)
- BEDROOM 8'9" x 15'3" (2.69 x 4.67)
- BEDROOM 10'11" x 13'9" (3.33 x 4.21)
- BATHROOM 6'2" x 5'3" (1.89 x 1.61)
- BEDROOM (LOFT) 9'10" x 11'5" (3.00 x 3.49)

Area Map



Floor Plans

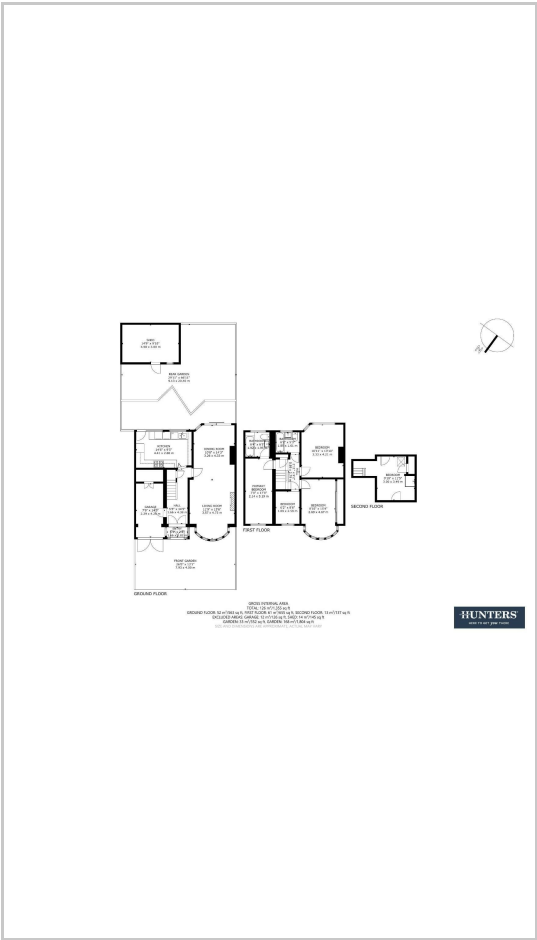

Energy Efficiency Graph

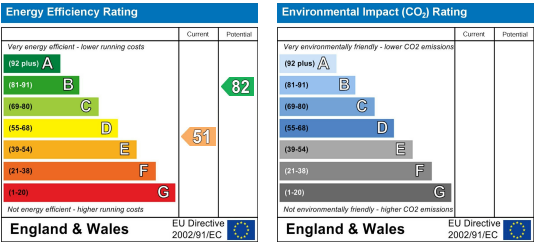

These particulars are intended to give a fair and reliable description of the property but no responsibility for any inaccuracy or error can be accepted and do not constitute an offer or contract. We have not tested any services or appliances (including central heating if fitted) referred to in these particulars and the purchasers are advised to satisfy themselves as to the working order and condition. If a property is unoccupied at any time there may be reconnection charges for any switched off/disconnected or drained services or appliances - All measurements are approximate. **THINKING OF SELLING?** If you are thinking of selling your home or just curious to discover the value of your property, Hunters would be pleased to provide free, no obligation sales and marketing advice. Even if your home is outside the area covered by our local offices we can arrange a Market Appraisal through our national network of Hunters estate agents.