



Capstan Close

Romford, RM6 4PY

£250,000



REDBRIDGE BOROUGH- Located in a much sought after area within the Redbridge Borough is this two bedroom ground floor purpose built flat. Internally the property boasts a spacious lounge, separate kitchen, bathroom and two bedroom. The property does require some internal updating however is offered to the market chain free making it an ideal first time purchase or buy to let investment.



LOUNGE 18'5 x 10'4 (5.61m x 3.15m)

KITCHEN 8'3 x 7'8 (2.51m x 2.34m)

BEDROOM ONE 11'2 x 8'4 (3.40m x 2.54m)

BEDROOM TWO 11'2 x 5'11 (3.40m x 1.80m)

BATHROOM 7'11 x 6'11 (2.41m x 2.11m)

Area Map



Floor Plans

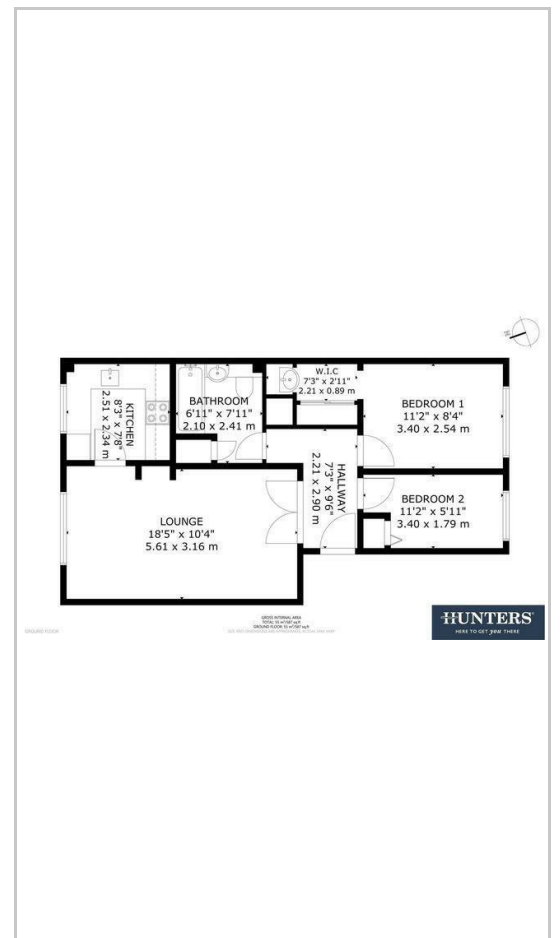

Energy Efficiency Graph

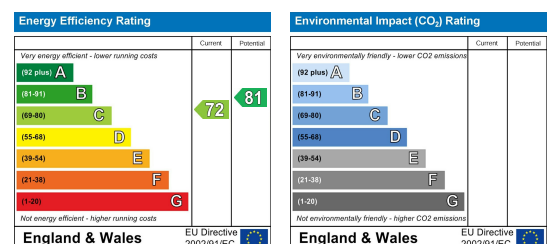

These particulars are intended to give a fair and reliable description of the property but no responsibility for any inaccuracy or error can be accepted and do not constitute an offer or contract. We have not tested any services or appliances (including central heating if fitted) referred to in these particulars and the purchasers are advised to satisfy themselves as to the working order and condition. If a property is unoccupied at any time there may be reconnection charges for any switched off/disconnected or drained services or appliances - All measurements are approximate. **THINKING OF SELLING?** If you are thinking of selling your home or just curious to discover the value of your property, Hunters would be pleased to provide free, no obligation sales and marketing advice. Even if your home is outside the area covered by our local offices we can arrange a Market Appraisal through our national network of Hunters estate agents.

6 Tudor Parade, Chadwell Heath, RM6 6PS

Tel: 020 8150 6001 Email: chadwell.heath@hunters.com <https://www.hunters.com>