



Campsey Road

Dagenham, RM9 4DR

£2,200 Per Month



Located in a much sought after area offering easy access to Becontree & Upney train stations is this well presented three bedroom extended mid terrace house. Internally the property boasts a spacious reception room, extended modern fitted kitchen, ground floor bathroom, utility room and three good size bedrooms. The property further benefits from a good size garden with summer house and off street parking. An internal viewing is highly recommended.



Porch

Reception 19'11 x 14'10 (6.07m x 4.52m)

Kitchen 10'7 x 8'11 (3.23m x 2.72m)

Utility Room 8'8 x 6'5 (2.64m x 1.96m)

Bathroom 10'0 x 5'4 (3.05m x 1.63m)

Garden 31'8 (9.65m)

Summer House 14'9 x 8'2 (4.50m x 2.49m)

Bedroom One 11'2 x 9'2 (3.40m x 2.79m)

Bedroom Two 10'9 x 8'11 (3.28m x 2.72m)

Bedroom Three 8'6 x 7'7 (2.59m x 2.31m)

Area Map



Floor Plans

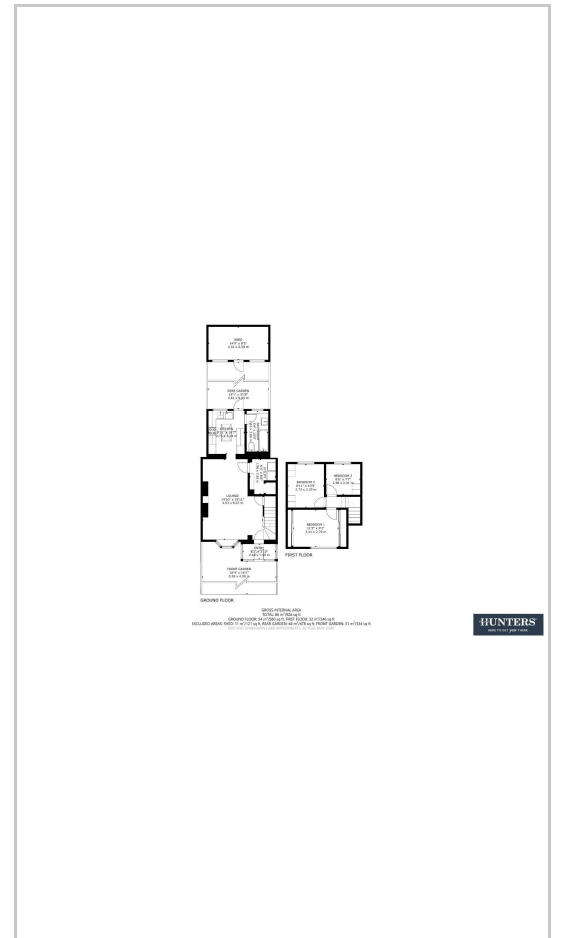

Energy Efficiency Graph

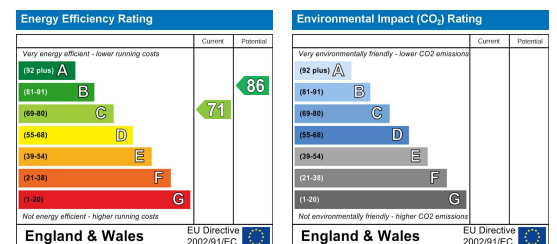

These particulars are intended to give a fair and reliable description of the property but no responsibility for any inaccuracy or error can be accepted and do not constitute an offer or contract. We have not tested any services or appliances (including central heating if fitted) referred to in these particulars and the purchasers are advised to satisfy themselves as to the working order and condition. If a property is unoccupied at any time there may be reconnection charges for any switched off/disconnected or drained services or appliances - All measurements are approximate. **THINKING OF SELLING?** If you are thinking of selling your home or just curious to discover the value of your property, Hunters would be pleased to provide free, no obligation sales and marketing advice. Even if your home is outside the area covered by our local offices we can arrange a Market Appraisal through our national network of Hunters estate agents.

6 Tudor Parade, Chadwell Heath, RM6 6PS

Tel: 020 8150 6001 Email: chadwell.heath@hunters.com <https://www.hunters.com>