



Portland Close

Romford, RM6 5UE

£250,000



CHAIN FREE- Located in a much sought after area in a quite turning is this well presented two bedroom first floor purpose built flat. Internally the property boasts a spacious living room, separate kitchen, two bedrooms and bathroom. The property further benefits from secure allocated parking, CCTV, access to loft space, on site managing agent/officer and communal gardens. The property is offered to the market chain free making it an ideal first time purchase or buy to let investment.



Hallway

Living Room 18'6 x 9'8 (5.64m x 2.95m)

Kitchen 8'2 x 5'5 (2.49m x 1.65m)

Bathroom 6'4 x 5'5 (1.93m x 1.65m)

Bedroom 11'8 x 7'3 (3.56m x 2.21m)

Bedroom 14'4 x 8'9 (4.37m x 2.67m)

Area Map



Floor Plans

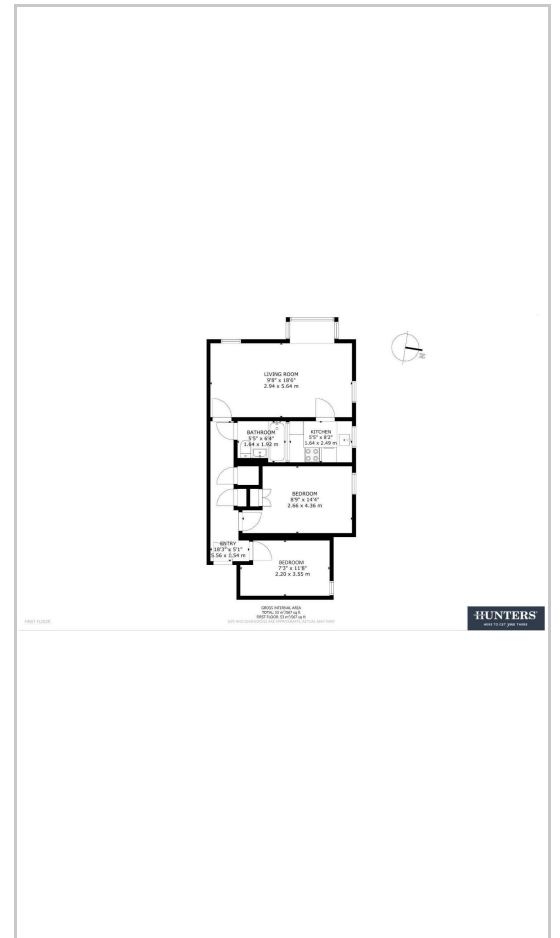

Energy Efficiency Graph

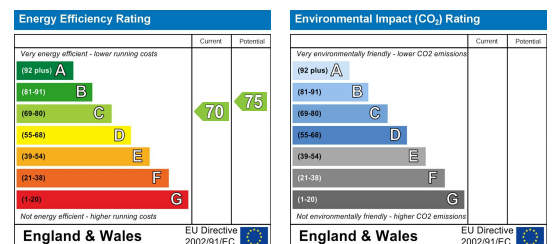

These particulars are intended to give a fair and reliable description of the property but no responsibility for any inaccuracy or error can be accepted and do not constitute an offer or contract. We have not tested any services or appliances (including central heating if fitted) referred to in these particulars and the purchasers are advised to satisfy themselves as to the working order and condition. If a property is unoccupied at any time there may be reconnection charges for any switched off/disconnected or drained services or appliances - All measurements are approximate. **THINKING OF SELLING?** If you are thinking of selling your home or just curious to discover the value of your property, Hunters would be pleased to provide free, no obligation sales and marketing advice. Even if your home is outside the area covered by our local offices we can arrange a Market Appraisal through our national network of Hunters estate agents.

6 Tudor Parade, Chadwell Heath, RM6 6PS

Tel: 020 8150 6001 Email: chadwell.heath@hunters.com <https://www.hunters.com>