



Crucible Close

Romford, RM6 4PZ

£200,000



CHAIN FREE- Located in a much sought after location offering easy access to King George Hospital and local amenities is this well presented one bedroom flat. The property boasts a bright and airy open plan kitchen and lounge, modern bathroom and a well sized bedroom. You will further benefit from your very own car parking space and is offered to the market chain free making it an ideal first time purchase or buy to let investment.



Hallway

Lounge/Kitchen 15'11" x 13'1" (4.85m x 3.99m)

Bedroom One 10'11" x 9'1" (3.33m x 2.77m)

Bathroom 7'2" x 5'10" (2.18m x 1.78m)

Area Map



Floor Plans

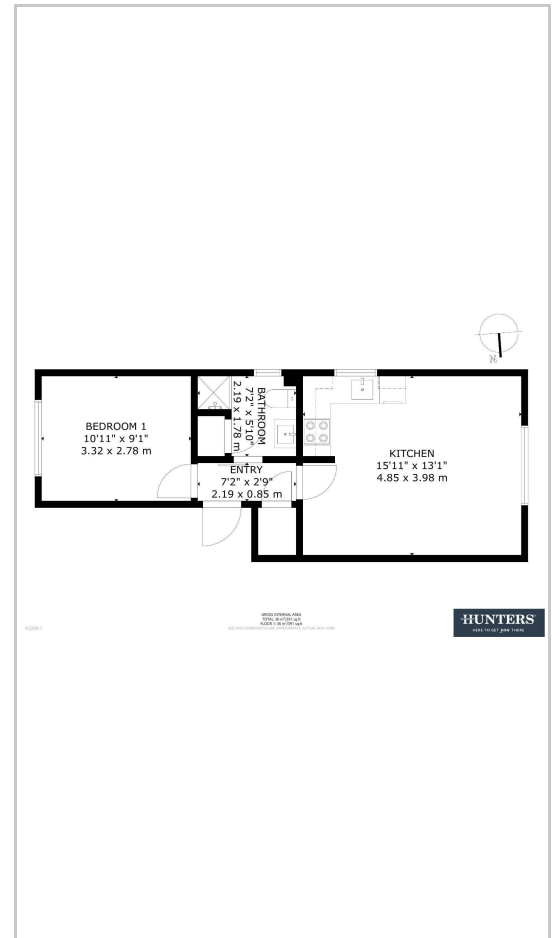

Energy Efficiency Graph

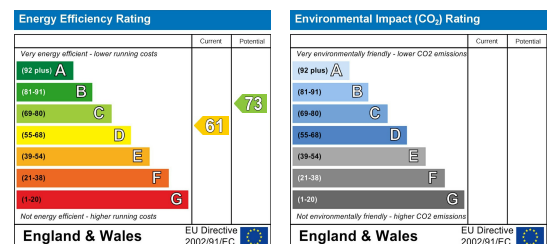

These particulars are intended to give a fair and reliable description of the property but no responsibility for any inaccuracy or error can be accepted and do not constitute an offer or contract. We have not tested any services or appliances (including central heating if fitted) referred to in these particulars and the purchasers are advised to satisfy themselves as to the working order and condition. If a property is unoccupied at any time there may be reconnection charges for any switched off/disconnected or drained services or appliances - All measurements are approximate. **THINKING OF SELLING?** If you are thinking of selling your home or just curious to discover the value of your property, Hunters would be pleased to provide free, no obligation sales and marketing advice. Even if your home is outside the area covered by our local offices we can arrange a Market Appraisal through our national network of Hunters estate agents.

6 Tudor Parade, Chadwell Heath, RM6 6PS

Tel: 02081506001 Email: chadwell.heath@hunters.com <https://www.hunters.com>