



West End, Farndon Newark NG24 3SG

welcome to

West End, Farndon Newark

This beautifully presented three bedroom semi-detached character family home is ideally located in the sought after village of Farndon with excellent access to the A46. Briefly comprising of breakfast kitchen, two reception rooms, utility/WC, storage room, three double bedrooms and family bathroom.



Entrance Porch

Leading through a part glazed door into the entrance porch with glazed windows to the side and access into the kitchen.

Breakfast Kitchen

13' 1" x 14' 4" (3.99m x 4.37m)

A range of low level country style units with solid wood work surfaces, tiled splashback, tiled flooring, inset butler style sink and drainer, space for recessed range cooker, full length storage cupboard and radiator. The kitchen also offers a central island with seating ideal for entertaining and families. Access into the rear porch and door into the dining room.

Dining Room

17' 8" max into recess x 16' 6" (5.38m max into recess x 5.03m)

Leading off the kitchen with patio doors out to the rear patio/garden, two radiators and single glazed window to the front looking into the entrance porch. The dining room also has stunning Inglenook fireplace with recessed log burner and brick surround.

Living Room

16' 9" x 15' 6" (5.11m x 4.72m)

A generous dual aspect living room with single glazed windows to the front and rear, feature fireplace with marble hearth and recessed cupboards to the side and radiator.

Storage Room

7' 6" x 7' 8" (2.29m x 2.34m)

Leading off the dining room with single glazed window to the side and radiator.

Utility/Wc

8' 3" x 7' 4" (2.51m x 2.24m)

A fantastic dual use utility/WC with a range of low level storage with plumbing for washing machine, WC, wash hand basin with under sink storage cupboard, radiator, generous storage cupboard and single glazed window to the side.

Rear Porch

Leading off the breakfast kitchen with single glazed windows all around, door to the rear courtyard ideal for entertaining.

First Floor Landing

First floor landing offering a single glazed window to the front, radiator and access into all three bedrooms and family bathroom.

Master bedroom

14' 5" excluding wardrobes x 10' 11" (4.39m excluding wardrobes x 3.33m)

A generously sized master bedroom with wooden floors, double doors to the Juliette balcony, radiator and an extensive range of bespoke built in wardrobes.

Bedroom Two

12' 10" max x 16' 6" max (3.91m max x 5.03m max)

Another DOUBLE bedroom with single glazed sash window to the rear, radiator and wash hand basin recessed into alcove. In addition, this bedroom has loft hatch access.

Bedroom Three

13' x 7' (3.96m x 2.13m)

A further DOUBLE bedroom with single glazed window to the front and radiator.

Family Bathroom

10' x 10' excluding shower (3.05m x 3.05m excluding shower)

A four piece family bathroom with wooden floors, part paneled walls, WC, wash hand basin, shower cubicle, freestanding roll top bath with mixer tap, shower attachment and radiator. In addition, there is a part obscured single glazed sash window to the rear.

Outside Front Garden

The front of the property offers block paved parking with access to the garage and side gate access to the garden. There is also a low level brick wall with gate creating a secure courtyard with borders for plants/shrubs.

Rear Garden

The rear of the property offers a sunny and private courtyard seating area which has access off the rear porch of the house and leads into a generous lawned area and cottage style garden. Pathways lead to the external office and reveal a further private seating area to the rear of the cottage. The garden opens up with greenhouse, summer house and timber shed with reinforced floor. The garden also offers mature hedges, trees, power, lighting and an outside tap. At the bottom of the garden a gate opens up into the paddock and field shelter. Ideal for livestock, horticultural pursuits and the like.

Paddock

A fantastic enclosed paddock to the rear of the property which is gated with fencing and an open field shelter for livestock and offers a generous slice of rural living.

Garage

21' 3" x 12' 8" (6.48m x 3.86m)

Detached garage with double doors to the front, wooden pedestrian door and power/lighting.

Timber Office

13' 3" x 9' 2" (4.04m x 2.79m)

A ideal space for a home office/games room with single glazed windows and single glazed double doors to the front with power, lighting, insulation, heating and a reinforced floor.



view this property online williamhbrown.co.uk/Property/NWK105865





Ground Floor

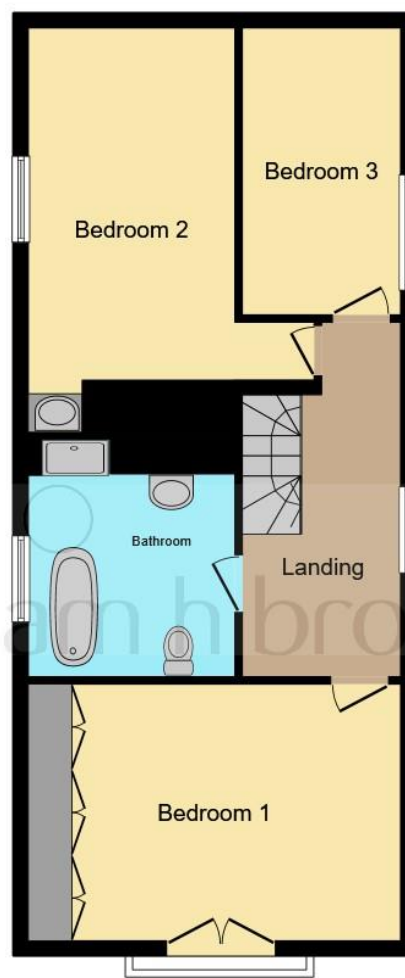

First Floor

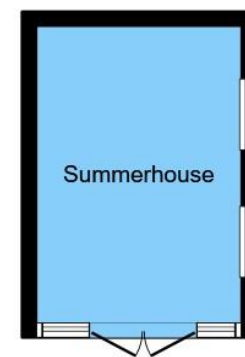
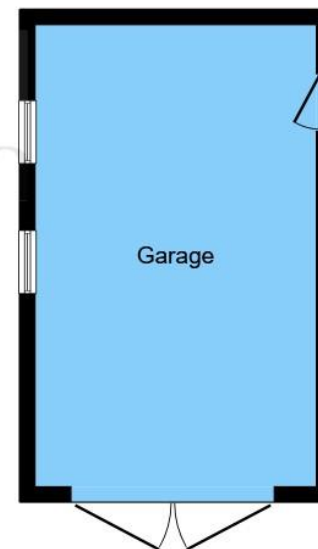

Outbuilding

This floor plan is for illustrative purposes only. It is not drawn to scale. Any measurements, floor areas (including any total floor area), openings and orientation are approximate. No details are guaranteed, they cannot be relied upon for any purpose and they do not form part of any agreement. No liability is taken for any error, omission or misstatement. A party must rely upon its own inspection(s). Powered by www.focalagent.com

welcome to

West End, Farndon Newark

- SEMI-DETACHED CHARACTER PROPERTY
- THREE DOUBLE BEDROOMS
- SPACIOUS BREAKFAST KITCHEN
- LIVING & DINING ROOM
- UTILITY/WC

Tenure: Freehold EPC Rating: E

£525,000



Please note the marker reflects the postcode not the actual property

view this property online williamhbrown.co.uk/Property/NWK105865



Property Ref:
NWK105865 - 0004

1. MONEY LAUNDERING REGULATIONS Intending purchasers will be asked to produce identification documentation at a later stage and we would ask for your co-operation in order that there is no delay in agreeing the sale. 2. These particulars do not constitute part or all of an offer or contract. 3. The measurements indicated are supplied for guidance only and as such must be considered incorrect. Potential buyers are advised to recheck measurements before committing to any expense. 4. We have not tested any apparatus, equipment, fixtures or services and it is in the buyers interest to check the working condition of any appliances. 5. Where an EPC, or a Home Report (Scotland only) is held for this property, it is available for inspection at the branch by appointment. If you require a printed version of a Home Report, you will need to pay a reasonable production charge reflecting printing and other costs. 6. We are not able to offer an opinion either written or verbal on the content of these reports and this must be obtained from your legal representative. 7. Whilst we take care in preparing these reports, a buyer should ensure that his/her legal representative confirms as soon as possible all matters relating to title including the extent and boundaries of the property and other important matters before exchange of contracts.

William H Brown is a trading name of Sequence (UK) Limited which is registered in England and Wales under company number 4268443, Registered Office is Cumbria House, 16-20 Hockliffe Street, Leighton Buzzard, Bedfordshire, LU7 1GN. VAT Registration Number is 500 2481 05.



william h brown



01636 640473



newark@williamhbrown.co.uk



47-48 Market Place, NEWARK,
Nottinghamshire, NG24 1EG



williamhbrown.co.uk