



**Connells**

Lymington Court  
Watford





### Property Description

A superb one bedroom upper floor apartment located in this popular development. As you walk in the front door the large entrance leads to the bright and airy lounge, the modern bathroom in straight ahead and the double bedroom to the left. The modern fitted kitchen is to the left and is well appointed with the sink overlooking the grounds. Well placed for the North Orbital Road your viewing is highly recommended.

### Auctioneer's Comments

This property is offered through Modern Method of Auction. Should you view, offer or bid your data will be shared with the Auctioneer, iamsold Limited. This method requires both parties to complete the transaction within 56 days, allowing buyers to proceed with mortgage finance (subject to lending criteria, affordability and survey).

The buyer is required to sign a reservation agreement and make payment of a non-refundable Reservation Fee of 4.5% of the purchase price including VAT, subject to a minimum of £6600.00 including VAT. This fee is paid in addition to purchase price and will be considered as part of the chargeable consideration for the property in the calculation for stamp duty liability. Buyers will be required to complete an identification process with iamsold and provide proof of how the purchase would be funded.

The property has a Buyer Information Pack containing documents about the property. The documents may not tell you everything you

need to know, so you must complete your own due diligence before bidding. A sample of the Reservation Agreement and terms and conditions are contained within this pack. The buyer will also make payment of no more than £349 inc. VAT towards the preparation cost of the pack. Please confirm exact costs with the auctioneer.

The estate agent and auctioneer may recommend the services of other providers to you, in which they will be paid for the referral. These services are optional, and you will be advised of any payment, in writing before any services are accepted. Listing is subject to a start price and undisclosed reserve price that can change.

## Entrance Hall

Front door.

## Lounge

12' 1" max x 11' 9" max ( 3.68m max x 3.58m max )

Window to front, electric heater.

## Kitchen

12' 9" max x 5' 1" max ( 3.89m max x 1.55m max )

Sink with drainer, window, electric heater, work surfaces, range of wall and base units, sink with drainer, cooker point,

## Bedroom 1

10' 11" max x 10' 1" max ( 3.33m max x 3.07m max )

Window, carpet.

## Bathroom

Bath, window, wash hand basin in vanity unit, tiled walls, WC.

## Outside

## Communal Grounds

## Residents Parking













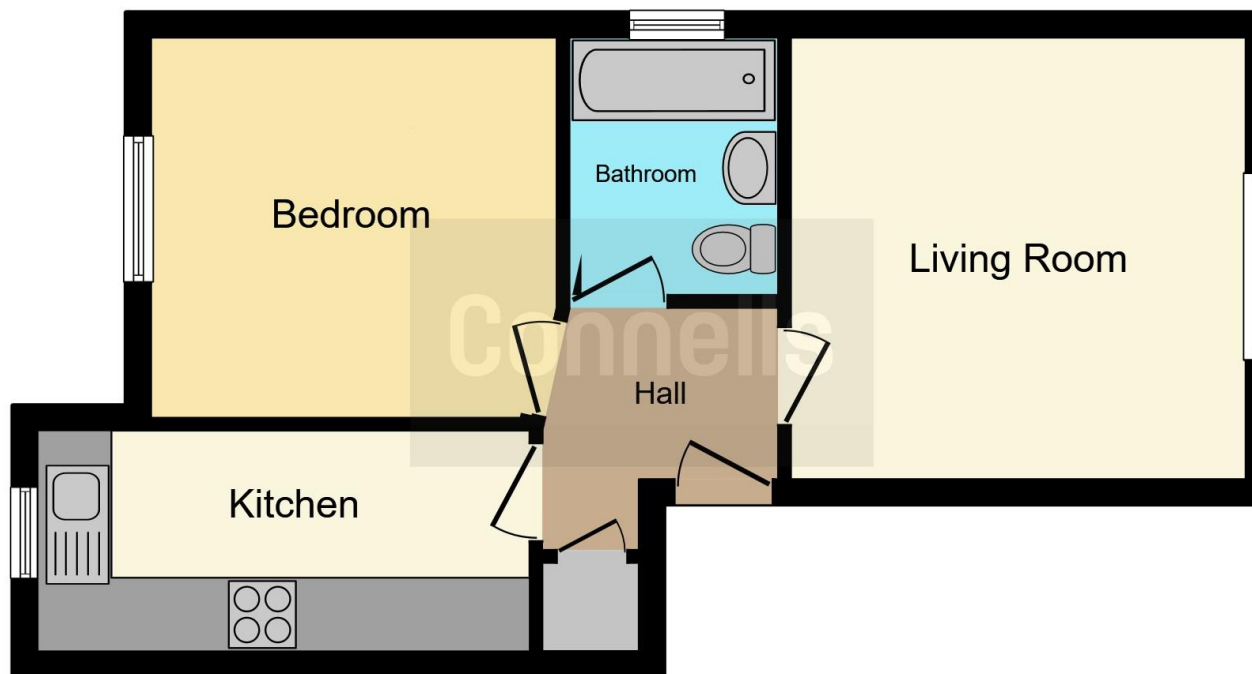

This floor plan is for illustrative purposes only. It is not drawn to scale. Any measurements, floor areas (including any total floor area), openings and orientation are approximate. No details are guaranteed, they cannot be relied upon for any purpose and they do not form part of any agreement. No liability is taken for any error, omission or misstatement. A party must rely upon its own inspection(s). Powered by [www.focalagent.com](http://www.focalagent.com)

To view this property please contact Connells on

**T 01923 674504**  
**E [leavesden@connells.co.uk](mailto:leavesden@connells.co.uk)**

1 Cunningham Way Leavesden  
 Abbots Langley WD25 7NG

**EPC Rating: D**

Tenure: Leasehold

**view this property online [connells.co.uk/Property/LEA103108](http://connells.co.uk/Property/LEA103108)**

This is a Leasehold property. We are awaiting further details about the Term of the lease. For further information please contact the branch. Please note additional fees could be incurred for items such as Leasehold packs.



1. MONEY LAUNDERING REGULATIONS Intending purchasers will be asked to produce identification documentation at a later stage and we would ask for your co-operation in order that there will be no delay in agreeing the sale. 2. These particulars do not constitute part or all of an offer or contract. 3. The measurements indicated are supplied for guidance only and as such must be considered incorrect. Potential buyers are advised to recheck measurements before committing to any expense. 4. We have not tested any apparatus, equipment, fixtures, fittings or services and it is in the buyers interest to check the working condition of any appliances.

Connells Residential is registered in England and Wales under company number 1489613, Registered Office is Cumbria House, 16-20 Hockliffe Street, Leighton Buzzard, Bedfordshire, LU7 1GN. VAT Registration Number is 500 2481 05.

**See all our properties at [www.connells.co.uk](http://www.connells.co.uk) | [www.rightmove.co.uk](http://www.rightmove.co.uk) | [www.zoopla.co.uk](http://www.zoopla.co.uk)**

Property Ref: LEA103108 - 0005