

Disclaimer:
Subject to survey.

Notes:

- KEY**
- Image Business Park
 - Boundary line

AREA SCHEDULE (GIA)

UNIT 1(GIA)	20,150ft²
Warehouse (Incl. GF Undercroft)	18,400ft ²
Office (FF Only)	1,750ft ²
Car parking spaces	35
UNIT 2(GIA)	26,600ft²
Warehouse (Incl. GF Undercroft)	24,150ft ²
Office (FF Only)	2,450ft ²
Car parking spaces	46
UNIT 3(GIA)	13,400ft²
Warehouse (Incl. GF Undercroft)	12,150ft ²
Office (FF Only)	1,250ft ²
Car parking spaces	17
UNIT 4(GIA)	19,100ft²
Warehouse (Incl. GF Undercroft)	17,250ft ²
Office (FF Only)	1,850ft ²
Car parking spaces	23
UNIT 5(GIA)	38,850ft²
Warehouse (Incl. GF Undercroft)	36,100ft ²
Office (FF Only)	2,750ft ²
Car parking spaces	75
Total	118,100ft²
Total Car Parking	196

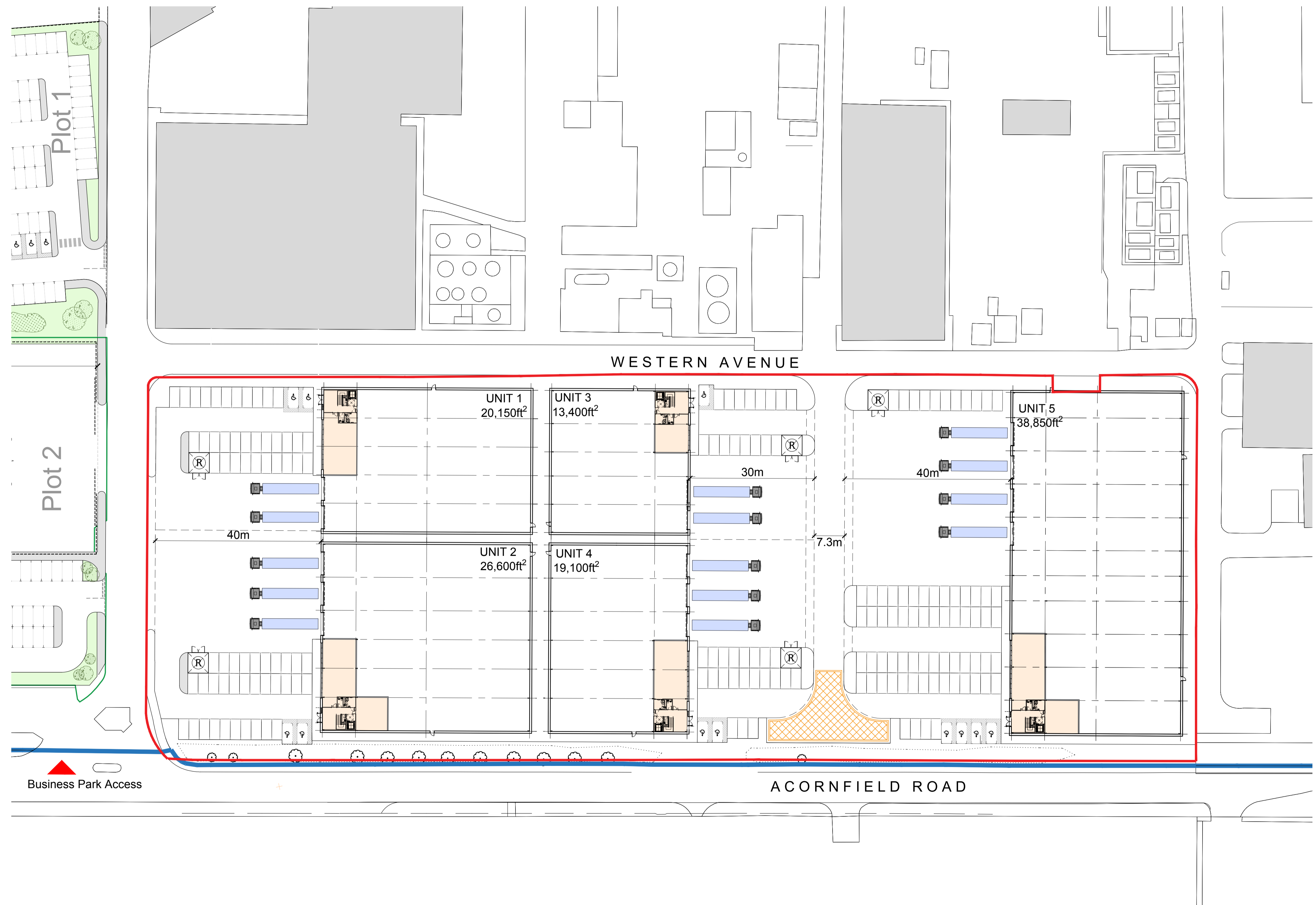

01 Plot C
1:500 @ A1 / 1:1000 @ A3

A	Unit Amendments	16.12.2020	HT	HA
-	First Issue	15.12.2020	HT	HA

Rev: Notes: Date: Dwn: Iss:

Client:

hale
ARCHITECTURE | DESIGN MANAGEMENT
198a Providence Square, Jacob Street, London, SE1 2DZ

Project:

Drawing Title:
**Plot 3
Proposed Site Plan**

Project No: Scale @ A1/A3:
1:500 / 1:1000

Drawing No: Revision:
SK2042 **A**