

DO NOT SCALE

NOTE: CONTRACTOR MUST ALLOW FOR ALL NECESSARY TEMPORARY PROPPING & NEEDLES TO EXISTING WALL CONSTRUCTION PRIOR TO REMOVING EXISTING MASONRY & INSTALLMENT OF NEW BEAM AND STANCHIONS.
WHERE THERE ARE ALTERATIONS TO LOAD BEARING MASONRY, THE FOUNDATIONS ARE TO BE CHECKED AND APPROVED PRIOR TO THE INSTALLATION OF STEELWORK UNLESS SPECIFICALLY INSTRUCTED BY THE ENGINEER IN WRITING.

ONLY PDF/DWG ISSUES OF THIS DRAWING ARE CONTROLLED. ALL OTHER FORMATS (e.g. DWG AUTOCAD FILES) ARE UN-CONTROLLED AND ARE USED AT YOUR OWN RISK.

NOTE FOR CONTRACTORS

THIS ADS DRAWING SHOULD BE CONSIDERED ALONG WITH THE RISK INFORMATION CONTAINED IN THE CDM PRE CONSTRUCTION INFORMATION. THIS INFORMATION WILL INCLUDE DETAILS OF THE SIGNIFICANT RISK WHICH ADS HAVE IDENTIFIED WHICH MAY ARISE FROM CONSTRUCTING THE DESIGNS SHOWN ON THIS DRAWING. A COMPETENT CONTRACTOR SHOULD BE AWARE OF THE TYPICAL RISKS ASSOCIATED WITH DOING THIS WORK.

NOTE FOR WORKERS

DO NOT START YOUR WORK UNLESS YOU KNOW THE RISK AND CONTROLS RELATING TO THE WORK ON THIS DRAWING (INCLUDING SAFE SEQUENCES OF WORK AND EQUIPMENT)



DO NOT ISSUE COPIES OR PARTS OF THIS DRAWING WITHOUT THE ABOVE NOTE FOR WORKERS (UNLESS YOU ARE SURE THAT THE WORKERS CAN UNDERTAKE THE WORK SAFELY).

GENERAL NOTES

- THIS DRAWING IS TO BE READ IN CONNECTION WITH ALL RELEVANT ARCHITECTS AND ENGINEERS DRAWINGS AND SPECIFICATIONS.
- DO NOT SCALE FROM THIS DRAWING. ALL SETTING OUT DIMENSIONS ARE TO BE CHECKED AND VERIFIED ON SITE PRIOR TO COMMENCEMENT OF ANY BUILDING WORKS & FABRICATION OF MATERIALS. ANY DISCREPANCIES ARE TO BE REPORTED TO THE ENGINEER.
- ALL WORKMANSHIP AND MATERIALS ARE TO COMPLY WITH THE CURRENT BUILDING REGULATIONS, BRITISH STANDARDS AND CODES OF PRACTICE. ALL MATERIALS SHALL BE FIXED OR APPLIED IN ACCORDANCE WITH THE MANUFACTURERS RECOMMENDATIONS. THE CONTRACTOR IS TO TAKE INTO ACCOUNT EVERYTHING DEEMED NECESSARY FOR THE PROPER EXECUTION OF THE WORKS WHETHER INDICATED ON THE DRAWINGS OR NOT TO THE COMPLETE SATISFACTION OF THE LOCAL AUTHORITY.
- FOR FINAL SETTING OUT INFORMATION RELATING TO WALL POSITIONS REFER TO ARCHITECTS DRAWINGS.

STEELWORK NOTES

- ALL STEELWORK FABRICATORS GENERAL ARRANGEMENT AND SECTIONAL DRAWINGS AND DETAILS ARE TO BE FORWARDED TO THE ENGINEER AND ARCHITECT FOR COMMENTS PRIOR TO COMMENCEMENT OF FABRICATION. THE STEELWORK SHALL BE FABRICATED, DELIVERED AND ERECTED STRICTLY IN ACCORDANCE WITH THE B.C.S.A. / S.C.I. NATIONAL STRUCTURAL STEELWORK SPECIFICATION FOR BUILDING CONSTRUCTION. 5TH ED. CE MARKING VERSION (PUBLICATION NO. 52/10).
- ALL STEELWORK SHALL BE FABRICATED AND ERECTED BY A SPECIALIST STEELWORK CONTRACTOR WITH SUITABLE EXPERIENCE AND COMPETENCE, CONFIRMING TO CE EXECUTION CLASS 2 AS A MINIMUM.
- ALL HOT ROLLED STRUCTURAL STEELWORK SHALL BE GRADE S275 TO BS EN 10 025: 1993 U.N.O.
- ALL BOLTS SHALL BE SPUN GALVANISED GRADED 8.8 IN ACCORDANCE WITH BS 3692 UNLESS NOTED OTHERWISE.
- MATERIALS AND WORKMANSHIP FOR ALL WELDING IS TO BE IN ACCORDANCE WITH THE RELEVANT SECTIONS OF B.C.S.A. / S.C.I. NATIONAL STRUCTURAL STEELWORK SPECIFICATION FOR BUILDING CONSTRUCTION. 5th ED. CE MARKING VERSION (PUBLICATION NO. 52/10).
- ALL CONNECTIONS SHALL BE DESIGNED FOR THE MOMENTS AND SHEAR FORCES INDICATED ON THIS DRAWING. ALL BOLTED CONNECTIONS TO HAVE A MINIMUM OF 4 No. M16 GRADE 8.8 BOLTS (EACH END) U.N.O.
- FABRICATOR TO SUPPLY AND INSTALL ALL NECESSARY SHELF ANGLES AT COLUMN POSITIONS ETC. TO SUPPORT THE FLOOR DECKING.
- THE STEELWORK SUB-CONTRACTOR IS TO CARRY OUT A FOUNDATION SURVEY AT LEAST THREE DAYS PRIOR TO COMMENCEMENT OF ERECTION.
- ALL COLUMNS OVER 6.0m IN LENGTH ARE TO BE FITTED WITH EYE HOLES AND GUYED DURING ERECTION PRIOR TO BEING CONNECTED TO THE MAIN BRACED FRAMES.
- CONCRETE FOR ENCASING STEELWORK IS TO BE GRADE C30 WITH A MINIMUM COMPRESSIVE STRENGTH OF 30N/mm² AT 28 DAYS. MINIMUM CEMENT RATIO IS TO BE 0.55. MAXIMUM AGGREGATE SIZE IS TO BE 20mm NOMINAL. D98 WRAPPING MESH IS TO BE PROVIDED IN THE CONCRETE CENTRALLY BETWEEN OUTER FACES OF THE CONCRETE AND THE STEELWORK.
- WHERE STEELWORK IS SEATED ON PADSTONES THEY SHALL BE OF GRADE C50 CONCRETE AND UNREINFORCED UNLESS NOTED OTHERWISE. ALL STEEL BEAMS SHALL BE FIXED ONTO THE PADSTONES WITH 2 No. 16mm DIA. ANCHOR BOLTS (1 No. EACH END).
- ALL STEELWORK BELOW GROUND TO BE ENCASED IN GRADE 35 CONCRETE WITH MINIMUM 100mm COVER.

NOTE: THE MAXIMUM WEIGHT OF STEEL TO BE LIFTED; INSERT BEAM SIZE IS INSERT WEIGHT kg & APPROX. INSERT LENGTH INCLUDING BEARINGS METRES LONG

NOTE: CONTRACTOR MUST ALLOW FOR ALL NECESSARY TEMPORARY PROPPING & NEEDLES TO EXISTING WALL CONSTRUCTION PRIOR TO REMOVING EXISTING MASONRY & INSTALLMENT OF NEW BEAM AND STANCHIONS.

WHERE THERE ARE ALTERATIONS TO LOAD BEARING MASONRY, THE FOUNDATIONS ARE TO BE CHECKED AND APPROVED PRIOR TO THE INSTALLATION OF STEELWORK UNLESS SPECIFICALLY INSTRUCTED BY THE ENGINEER IN WRITING.

EXISTING FLOOR SPAN DIRECTION HAS NOT BEEN CONFIRMED. DISCREPANCIES BETWEEN FLOOR SPANS AS SHOWN ON THIS DRAWING AND ON SITE ARE TO BE REPORTED TO THE ENGINEER PRIOR TO THE COMMENCEMENT OF WORKS.

REV	DATE	REVISION DETAILS	DRAWN	CHKD	APPRO
P4	06.07.20	FENCING HEIGHT ADDED	PB	SH	ADS
P3	01.07.20	FENCING & KERB REVISED	PB	SH	ADS
P2	25.06.20	DETAILS ADDED	PB	SH	ADS
P1	19.06.20	FIRST ISSUE	PB	SH	ADS

CLIENT: **ROCKMOUNT**

PROJECT: **2-6 FOUNDRY LANE**

DRAWING TITLE: **SITE PLAN**

DRAWING STATUS: **PRELIMINARY**

Alexandra Business Park
4th Floor, The Tower
Prescot Road, St Helens
WA10 3TP
Tel: 0151 541 4000
info@adsstructural.co.uk

SCALE	DOCUMENT NUMBER	REV
1:200 @ A1	20-4993-100A	P4

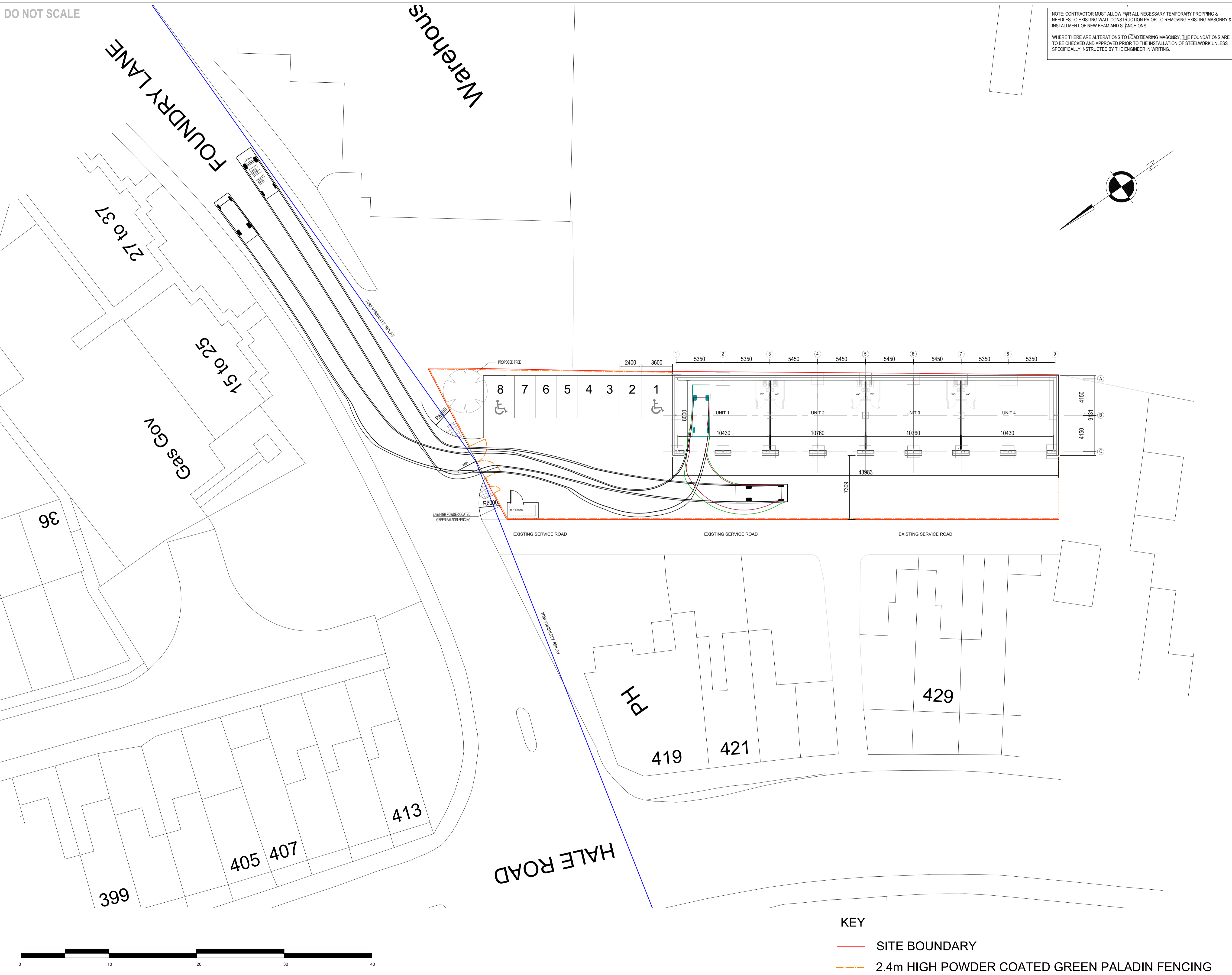

- KEY**
- SITE BOUNDARY
 - 2.4m HIGH POWDER COATED GREEN PALADIN FENCING
 - VISIBILITY SPLAY

