



HW

ESTATE AGENTS

Somerset Court, Wilbury Villas  
£230,000





## Somerset Court, Hove

An exceptional one-bedroom flat with stylish interiors, private garden, and off-road parking in a desirable area close to amenities and transport links, offering contemporary living with indoor-outdoor appeal.

Council Tax band: B

Tenure: Leasehold

EPC Energy Efficiency Rating: C

EPC Environmental Impact Rating: C

- Private garden
- Patio area
- Open plan living area
- Modern kitchen
- Abundant natural light
- Sliding doors to garden
- Off-road parking
- Wooden flooring
- Modern bathroom
- Built-in shelving







# Wilbury Villas

Approx. Gross Internal Area:- 41.59 sq.m. 447.67 sq.ft.



HAWKINS WATTS WINNARD

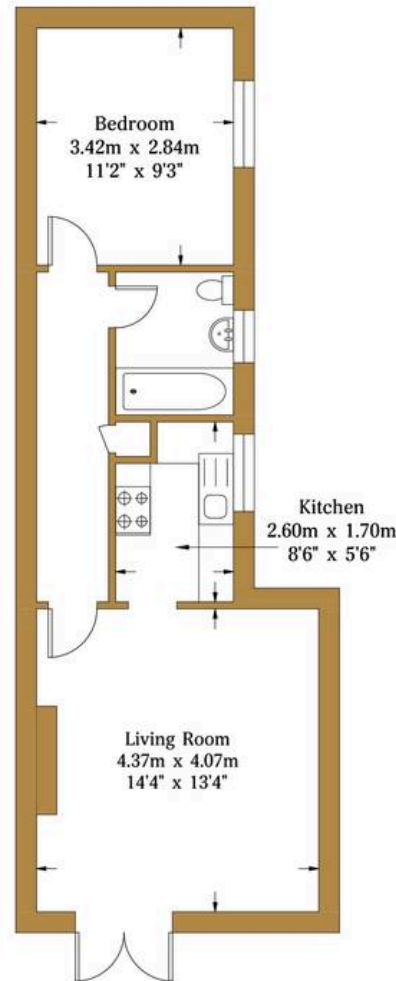

**Lower Ground Floor**  
**Approximate Floor Area**  
**447.67 sq ft**  
**(41.59 sq m)**

Illustration for identification purposes only, measurements are approximate, not to scale.

© hwestateagents





## HW Estate Agents

HW Estate Agents, 80 Goldstone Villas, Hove - BN3 3RU

01273 359000 · [hove@hwestateagents.co.uk](mailto:hove@hwestateagents.co.uk) · [www.hwestateagents.co.uk](http://www.hwestateagents.co.uk)

HW

ESTATE AGENTS