

Property ref: 134767



St Anns Court, Crowthorne, RG45 6DN

£1,625 PCM



Located in Crowthorne is this delightful two bedroom apartment in a converted period building. Entrance hallway, open plan kitchen with appliances/living room/dining room, Two good size bedrooms, Shower room, well maintained communal gardens, parking, Gas central heating. EPC band C. Bracknell Forest Council tax band B. Unfurnished.

Available 26/01/2026

- Period property
- Two good size bedrooms
- Modern kitchen
- Modern shower room
- Communal gardens
- Unfurnished

*Fees For Assured Shorthold Tenancies: when you rent a property from us you will be required to pay a sum equivalent to one weeks' rent for a holding deposit. Upon successful application, this amount will be off set against your first months' rent. You will also be required to pay a security deposit equivalent to 5 weeks' rent which will be held and protected in line with Deposit legislation. For more information about our fees please visit: www.michael-hardy.co.uk
Fees for all other tenancies (Non Housing Act Tenancies / Company Lets): when you rent a property from us we will charge you a one-off fee per property. This charge is the equivalent of 15 days of the monthly rental charge (+VAT) with a minimum fee of £450 (inc.VAT) up to a maximum of £650 (inc.VAT). Other fees may apply depending on your circumstances.

0118 9776 776

lettings@michael-hardy.co.uk www.michael-hardy.co.uk

Michael Hardy Lettings, 9 Broad Street, Wokingham, , RG40 1AU

Heating Type : Gas

Water supply; Mains

Drainage info: Mains

Electricity supply: Mains

Gas supply: Mains

Broadband/Mobile Info: Connections available. For an indication of specific speeds and supply of Broadband and Mobile, we advise applicants go to the Ofcom website Broadband and Mobile Coverage Checker.





Dukes Ride, Crowthorne

Approximate Area = 501 sq ft / 46.5 sq m

For identification only - Not to scale

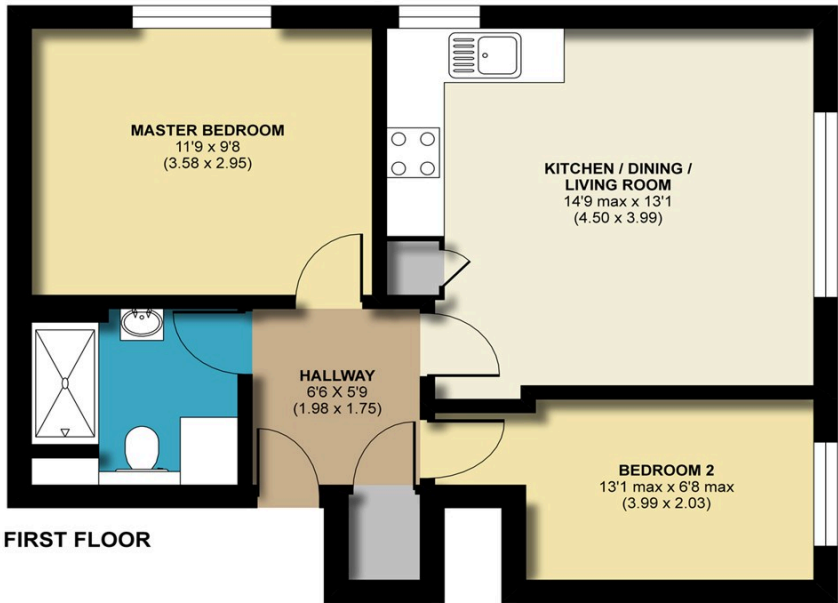

FIRST FLOOR



Floor plan produced in accordance with RICS Property Measurement Standards incorporating International Property Measurement Standards (IPMS2 Residential). © richcom 2021. Produced for Michael Hardy. REF: 698167