



Daniels End, Willingham Cambridge
£200,000 Leasehold

**Sharman
Quinney**

Key Features

2

1

B

C



75% Shared Ownership
£292.32 Rent pcm

125 Years remaining as of 01 Jan 2017

£Ask Agent Ground Rent pcm

Review due: Ask Agent

£Ask Agent Service Charge pcm

Review due: 04/2026

- 75% shared ownership
- Naturally light living room
- Modern kitchen / diner
- Downstairs WC
- Two generously sized bedrooms

Set in a quiet cul-de-sac in the charming village of Willingham, this spacious, light, and airy family home is offered with 75% shared ownership. Perfectly suited for modern family living, this



property combines comfort with a peaceful village setting.

This delightful property features an entrance hall with a built-in wardrobe, providing convenient storage for coats and shoes, and a handy downstairs WC. The modern, spacious kitchen/diner enjoys the sun in the afternoon, while the naturally light living room boasts understairs storage and double doors that open onto the garden, perfect for indoor-outdoor living.

Upstairs, the galleried landing includes a double-door shelved wardrobe. The exceptionally spacious main bedroom offers a built-in wardrobe, while the second bedroom is also a double and includes its own built-in wardrobe. A modern three-piece bathroom suite completes the upper floor.

The rear garden is perfect for families, mainly laid to lawn with a large patio area ideal for entertaining or relaxing. At the front, there is off-road parking for two vehicles, adding convenience to this beautiful family home

Entrance hall

WC

Kitchen / diner - 3.55m x 3.25m (11'8 x 10'8)

Living room - 6.24m max x 3.35m (20'6 max x 11')

First floor landing

Bedroom one - 4.97m x 2.73m (16'4 x 8'11)





Ground Floor

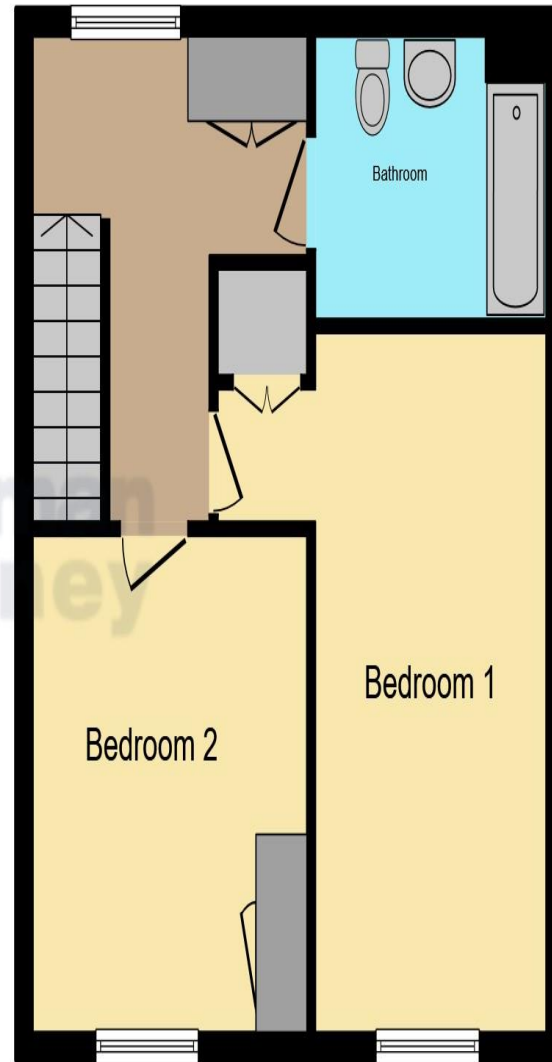

First Floor

Bedroom two - 3.56m x 3.39m (11'8 x 11'1)
Bathroom

This floor plan is for illustrative purposes only. It is not drawn to scale. Any measurements, floor areas (including any total floor area), openings and orientation are approximate. No details are guaranteed, they cannot be relied upon for any purpose and they do not form part of any agreement. No liability is taken for any error, omission or misstatement. A party must rely upon its own inspection(s). Powered by www.focalagent.com

To view this property call Sharman Quinney on:
01954 710620

Selling your property?

**Contact us to arrange a FREE
home valuation.**

01954 710620

Unit 5 Orchard House Unwin Square, Orchard
Park, CAMBRIDGE, Cambridgeshire, CB4 2AD

cambourne@sharmanquinney.co.uk

www.sharmanquinney.co.uk



Sharman Quinney Holdings Limited is registered in England and Wales under company number 4174227, Registered Office is Cumbria House, 16-20 Hockliffe Street, Leighton Buzzard, Bedfordshire, LU7 1GN. VAT Registration Number is 500 2481 05.

1: These particulars do not constitute part or all of an offer or contract. 2: The measurements indicated are supplied for guidance only and as such must be considered incorrect. 3: Potential buyers are advised to recheck the measurements before committing to any expense. 4: Sharman Quinney has not tested any apparatus, equipment, fixtures, fittings or services and it is the buyers interests to check the working condition of any appliances. 5: Sharman Quinney has not sought to verify the legal title of the property and buyers must obtain verification from their legal representative. 6: Intending purchasers will be asked to produce identification documentation at a later stage and we would ask your co-operation in order that there will be no delay in agreeing the sale. Ref:ORP101545 -

0008