

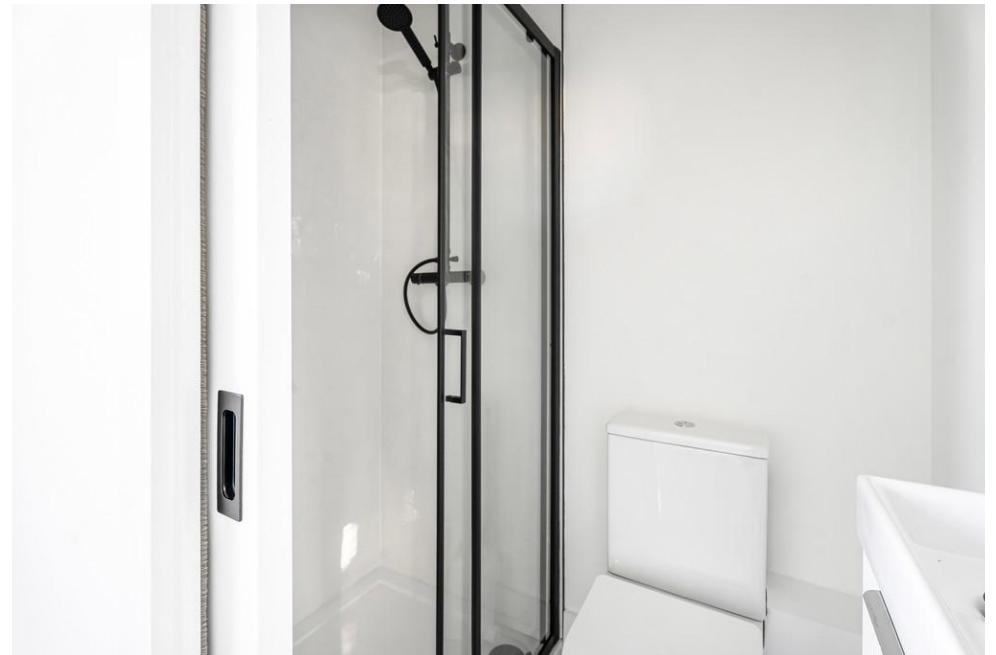

This beautifully refurbished three-bedroom semi-detached tunnel linked family home, offering spacious and versatile living throughout. The property boasts a brand newly fitted kitchen/diner with double doors to the garden, bright and airy living room, a brand new high spec ground floor shower room. The first floor comprises of three generous double bedrooms and a luxury en-suite to the principal bedroom. Ideally situated within walking distance of local amenities, the town centre and train station, this property makes the ideal family home - early viewing is highly recommended! Unfurnished and available now.







Approximate Gross Internal Area 807 sq ft - 75 sq m
Ground Floor Area 435 sq ft – 40 sq m
First Floor Area 372 sq ft – 35 sq m



Ground Floor

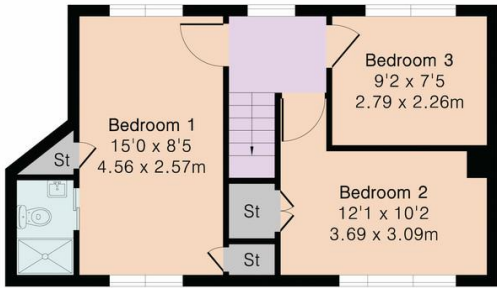

First Floor

Score	Energy rating	Current	Potential
92+	A		
81-91	B		87 B
69-80	C		
55-68	D	60 D	
39-54	E		
21-38	F		
1-20	G		



Floor plan produced in accordance with RICS Property Measurement 2nd Edition. Although Pink Plan Ltd ensures the highest level of accuracy, measurements of doors, windows and rooms are approximate and no responsibility is taken for error, omission or misstatement. These plans are for representation purposes only and no guarantee is given on the total square footage of the property within this plan. The figure icon is for initial guidance only and should not be relied on as a basis of valuation.





Whilst we endeavour to make our sales particulars fair, accurate and reliable, they are only intended as a general guide to the property. Measurements and distances are approximate. These particulars do not form part of any offer or contract. If there are important matters that are likely to affect your decision to buy, please contact us before viewing the property. Please note that we have not tested the services, equipment or appliances in this property, accordingly, we advise prospective buyers to commission their own survey or service reports before finalising any offer to purchase.