



 Steven Oates

Cublands, Hertford  
**£1,750 pcm**



Steven Oates are pleased to offer for rental this well presented three bedroom end of terrace house located on the popular Foxholes Development. The property features a good sized lounge, kitchen diner, three bedrooms with en suite to master and family bathroom. Externally the property offers a rear garden and allocated parking. The property is available September, unfurnished.



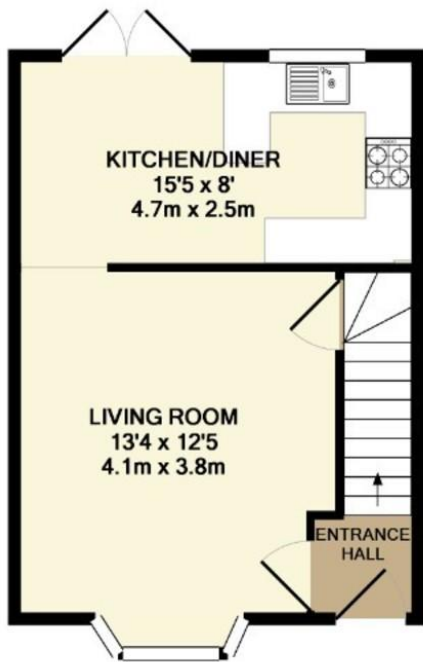

GROUND FLOOR  
APPROX. FLOOR  
AREA 336 SQ.FT.  
(31.2 SQ.M.)

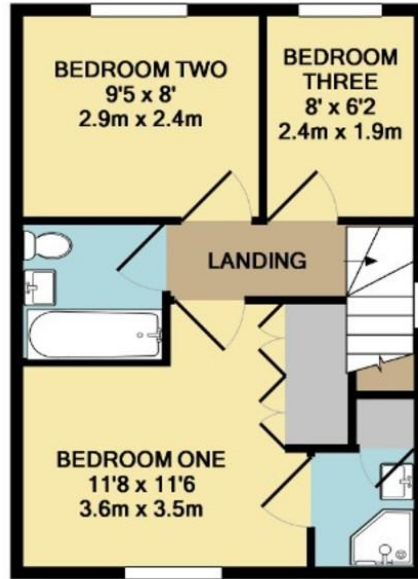

1ST FLOOR  
APPROX. FLOOR  
AREA 329 SQ.FT.  
(30.6 SQ.M.)

Whilst every attempt has been made to ensure the accuracy of the floor plan contained here, measurements of doors, windows, rooms and any other items are approximate and no responsibility is taken for any error, omission, or mis-statement. This plan is for illustrative purposes only and should be used as such by any prospective purchaser. The services, systems and appliances shown have not been tested and no guarantee as to their operability or efficiency can be given.  
Made with Metapix ©2015

Energy Efficiency Rating		Current	Potential
Very energy efficient - lower running costs			
(92-100)	<b>A</b>		
(81-91)	<b>B</b>		89
(69-80)	<b>C</b>		
(55-68)	<b>D</b>	69	
(39-54)	<b>E</b>		
(21-38)	<b>F</b>		
(1-20)	<b>G</b>		
Not energy efficient - higher running costs			
England, Scotland & Wales			
		EU Directive 2002/91/EC	







Whilst we endeavour to make our sales particulars fair, accurate and reliable, they are only intended as a general guide to the property. Measurements and distances are approximate. These particulars do not form part of any offer or contract. If there are important matters that are likely to affect your decision to buy, please contact us before viewing the property. Please note that we have not tested the services, equipment or appliances in this property, accordingly, we advise prospective buyers to commission their own survey or service reports before finalising any offer to purchase.