



13 Benwick Court Croydon Road

London, SE20 7SS

Asking Price £240,000

Set on the second floor, this well-proportioned flat offers 525 sq ft (48.8 sq m) of bright and comfortable living space — ideal for first-time buyers or investors.

The property comprises a generous living room, double bedroom, separate kitchen, and bathroom. Residents also enjoy access to communal gardens and unallocated off-street parking.

Conveniently located on Croydon Road, Benwick Court is close to Crystal Palace Park, local shops, and the vibrant amenities of Penge and Anerley. Anerley and Birkbeck stations are both nearby, offering excellent links to London Bridge, Victoria, and the Overground network.

With growing demand in the area, this apartment represents a great opportunity in one of South East London's most up-and-coming neighborhoods.

Tenure: Leasehold (98yrs remaining)

Service Charge: £918.00 p/a

Ground Rent: £19.90 p/a

Council Tax: Band B

Viewing

Please contact our Galloways Penge Office on 020 8778 1120 if you wish to arrange a viewing appointment for this property or require further information.

- ONE BEDROOM APARTMENT
- BRIGHT AND AIRY THROUGHOUT
- TOTAL SQUARE FOOTAGE 525 sq ft / 48.8 sq m
- COMMUNAL PARKING
- COMMUNAL GARDENS
- GOOD SIZE FITTED KITCHEN
- 11 MINUTES WALK TO BIRKBECK STATION
- 12 MINUTES WALK TO ANERLEY STATION
- 1 MINUTE WALK TO WINSFORD GARDEN OPEN SPACE
- (WALKING TIMES ESTIMATED BY GOOGLE MAPS)

Floor Plan

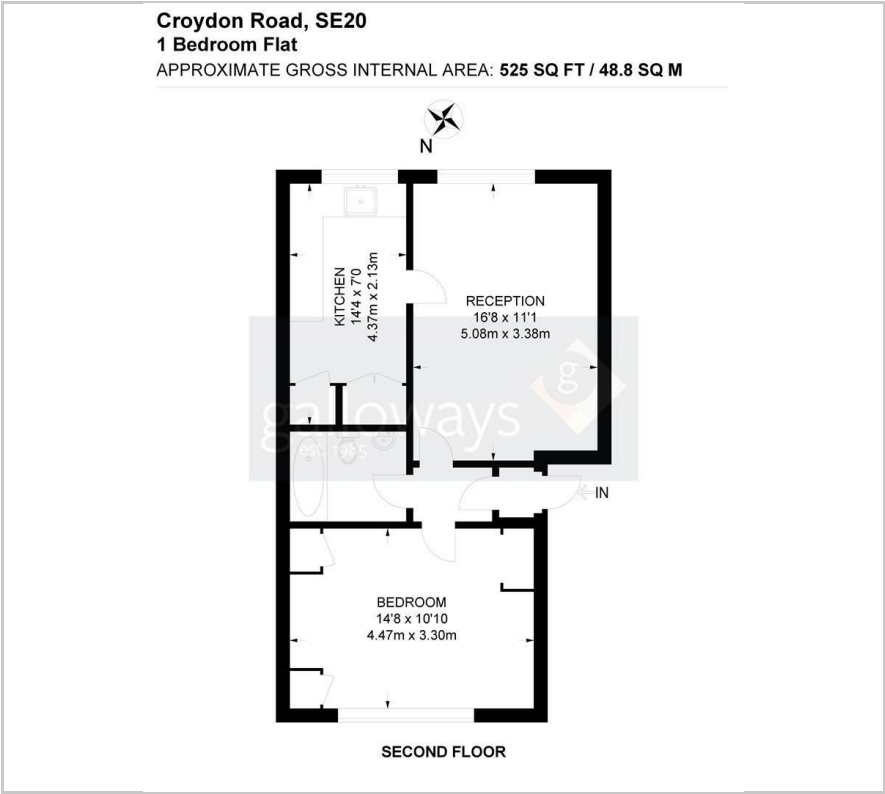

Area Map



Energy Efficiency Graph

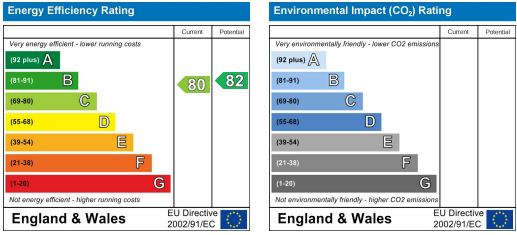

These particulars, whilst believed to be accurate are set out as a general outline only for guidance and do not constitute any part of an offer or contract. Intending purchasers should not rely on them as statements of representation of fact, but must satisfy themselves by inspection or otherwise as to their accuracy. No person in this firms employment has the authority to make or give any representation or warranty in respect of the property.