



7 Kendal House Derwent Road

London, SE20 7YR

£1,500 Per Month

This beautifully presented two-bedroom apartment offers stylish and contemporary living in the heart of Anerley. Situated within a modern apartment block, the property boasts a sleek, fully fitted kitchen, a well-appointed bathroom, and spacious living area, making it an ideal home for professionals.

The apartment is conveniently located near excellent transport links, with Anerley, Birkbeck, and Elmers End stations all within easy reach, providing direct access to Central London and beyond. For those who enjoy green spaces, Crystal Palace Park and Betts Park are nearby, offering plenty of outdoor leisure opportunities.

Don't miss out on this fantastic rental opportunity, contact us today to arrange a viewing!

Council Tax Band C £1544.00pa

Viewing

Please contact our Galloways Penge Office on 020 8778 1120 if you wish to arrange a viewing appointment for this property or require further information.

- TWO BEDROOMS
- AVAILABLE 23RD MAY 2025
- NEUTRALLY DECORATED
- CLOSE TO AMENITIES
- MODERN KITCHEN AND BATHROOM
- GOOD TRANSPORT LINKS
- PURPOSE BUILT
- 0.6 MILES TO ANERLEY STATION
- 0.7 MILES TO NORWOOD JUNCTION
- DISTANCES CALCULATED VIA GOOGLE MAPS



2



1



1



C

Floor Plan

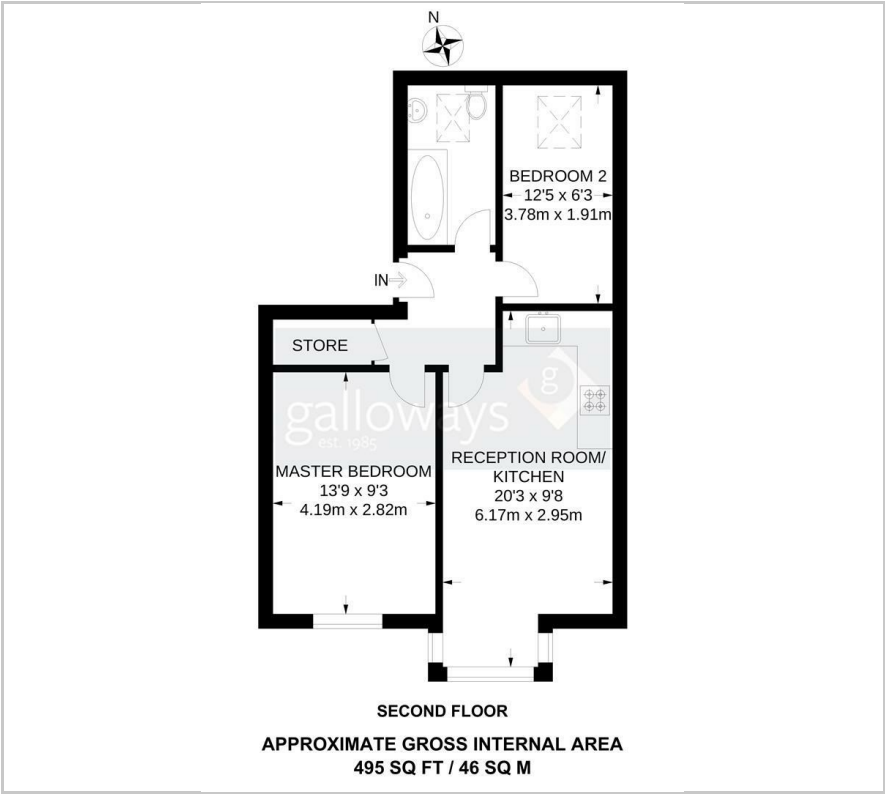

Area Map



Energy Efficiency Graph

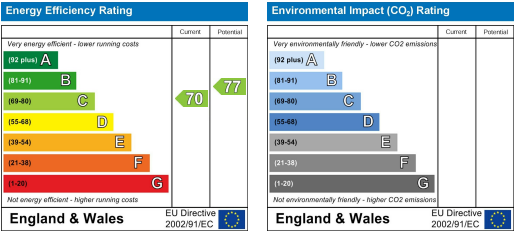

These particulars, whilst believed to be accurate are set out as a general outline only for guidance and do not constitute any part of an offer or contract. Intending purchasers should not rely on them as statements of representation of fact, but must satisfy themselves by inspection or otherwise as to their accuracy. No person in this firms employment has the authority to make or give any representation or warranty in respect of the property.