



## 5 Wordsworth Road

London, SE20 7JF

**Asking Price £360,000**

Galloways are pleased to present this fantastic one bedroom period conversion flat to the market. The living room is a standout feature, with large windows that flood the space with natural light, making it a bright and inviting place to relax. The separate kitchen is well-equipped and provides a practical space for preparing meals, while also offering plenty of room for storage and cooking. One of the unique advantages of this property is the private garden, a tranquil outdoor area that offers the perfect retreat for enjoying some fresh air, whether you're gardening, entertaining, or simply relaxing.

The flat also benefits from gas central heating, ensuring a warm and comfortable environment all year round. Its prime location provides excellent transport links and easy access to a wide range of local amenities, making it an ideal choice for those seeking convenience and accessibility in one of London's desirable areas.

Tenure: Share of Freehold  
Lease Length: 116 years remaining  
Local Authority: Bromley (Council Tax Band B)  
Service Charge: £60.00 p/a (For communal electric)  
Building Insurance - £250.59 p/a

### Viewing

Please contact our Galloways Penge Office on 020 8778 1120 if you wish to arrange a viewing appointment for this property or require further information.

- ONE BEDROOM FLAT
- HIGH CEILINGS
- PRIVATE GARDEN
- VICTORIAN CONVERSION
- LARGE WINDOWS
- GAS CENTRAL HEATING
- PRIME LOCATION
- 6 MINUTE WALK TO PENGE EAST STATION
- 11 MINUTE WALK TO PENGE WEST STATION
- (ALL DISTANCES ESTIMATED VIA GOOGLE MAPS)



Floor Plan

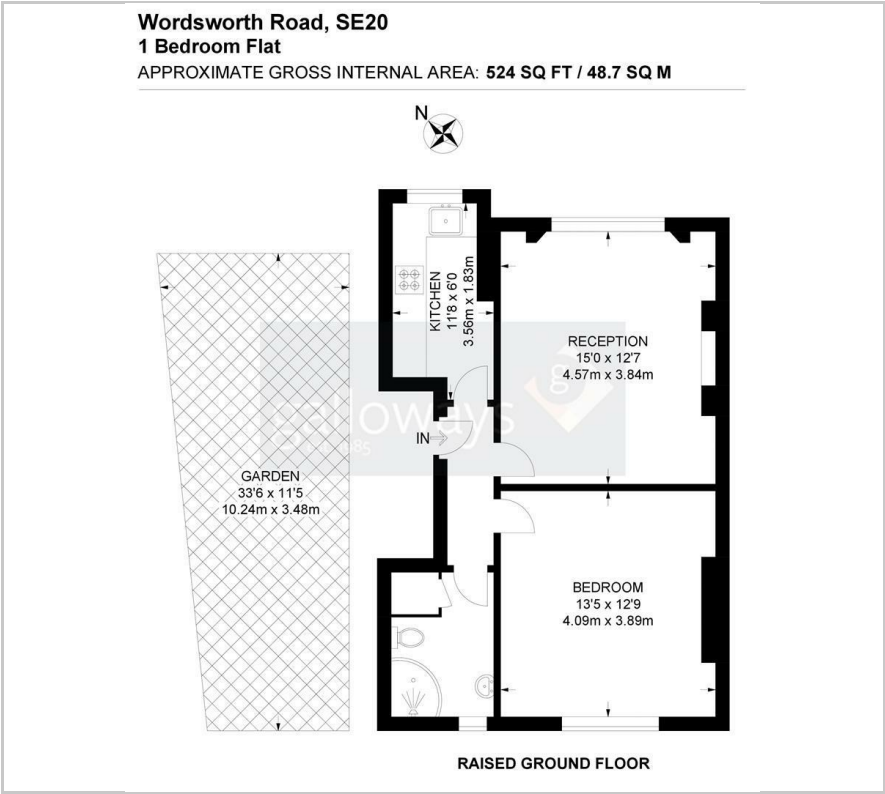

Area Map



Energy Efficiency Graph

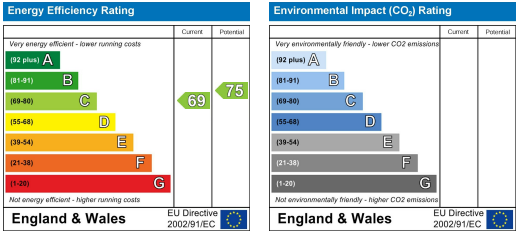

These particulars, whilst believed to be accurate are set out as a general outline only for guidance and do not constitute any part of an offer or contract. Intending purchasers should not rely on them as statements of representation of fact, but must satisfy themselves by inspection or otherwise as to their accuracy. No person in this firms employment has the authority to make or give any representation or warranty in respect of the property.