



15a Kangley Bridge Road

London, SE26 5BA

Asking Price £325,000

This delightful property offers two generously sized double bedrooms, perfect for those seeking comfort and convenience. The flat is chain-free, making it an ideal opportunity for first-time buyers or investors looking to move quickly.

One of the standout features of this property is its private section of the rear garden, providing a tranquil outdoor space to relax or entertain. The flat benefits from gas central heating throughout, ensuring warmth and comfort in every season.

The master bedroom comes equipped with built-in wardrobes, offering ample storage space and enhancing the flat's overall functionality. The spacious bathroom adds to the appeal, providing a comfortable and relaxing environment.

Tenure: Leasehold
Lease Length: 90 Years
Service Charge: 40%
Ground Rent: £250
Lewisham Council Band B £1585.00pa

The vendor has provided the above information in good faith. Galloways have not yet had this information verified. Any buyer should seek their own independent legal advice before proceeding.

Viewing

Please contact our Galloways Penge Office on 020 8778 1120 if you wish to arrange a viewing appointment for this property or require further information.

- TWO DOUBLE BEDROOM FLAT
- CHAIN FREE
- GROUND FLOOR
- SECTION OF REAR GARDEN
- SEPERATE KITCHEN
- OFF STREET PARKING
- BUILT IN WARDROBES
- SPACIOUS BATHROOM
- 4 MINUTE WALK TO LOWER SYDENHAM STATION
- (ALL WALKING DISTANCES ARE ESTIMATED VIA GOOGLE MAPS)



2



1



1



D

Floor Plan

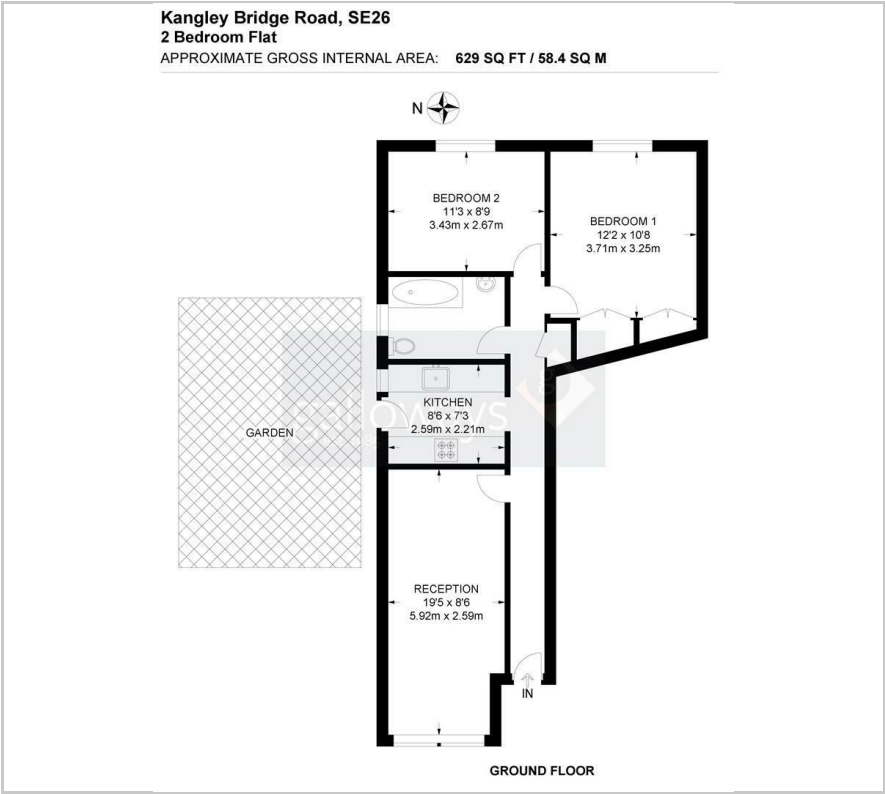

Area Map



Energy Efficiency Graph

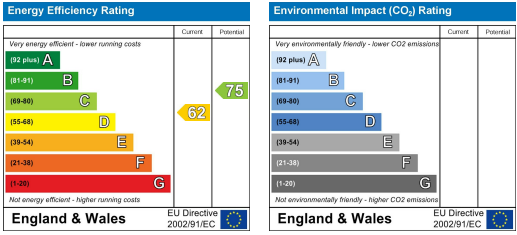

These particulars, whilst believed to be accurate are set out as a general outline only for guidance and do not constitute any part of an offer or contract. Intending purchasers should not rely on them as statements of representation of fact, but must satisfy themselves by inspection or otherwise as to their accuracy. No person in this firms employment has the authority to make or give any representation or warranty in respect of the property.