



Flat 3, 17 Eldon Park

London, SE25 4JQ

£1,750 Per Month

We are pleased to present a stunning and spacious 2-bedroom top floor flat located in the desirable area of Eldon Park, SE25 4JQ. Situated within a charming period building, this property offers a delightful blend of modern comforts and classic architectural features, making it a perfect place to call home.

Croydon Council
Council Tax Band C £1991

The deposit is 5 weeks rent £2019.20 (based on the asking rent)

Viewing

Please contact our Galloways Penge Office on 020 8778 1120 if you wish to arrange a viewing appointment for this property or require further information.

- 2 BEDROOM FLAT
- TOP FLOOR
- GARDEN
- 2 STORAGE ROOMS ON UPPER LEVEL INCLUDED
- MODERN BATHROOM
- MODERN KITCHEN
- STUDY ROOM
- DOUBLE GLAZED
- 8 MINUTE WALK TO NORWOOD JUNCTION
- (ALL WALKING TIMES CALCULATED VIA GOOGLE MAPS)

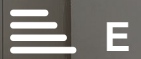

Floor Plan

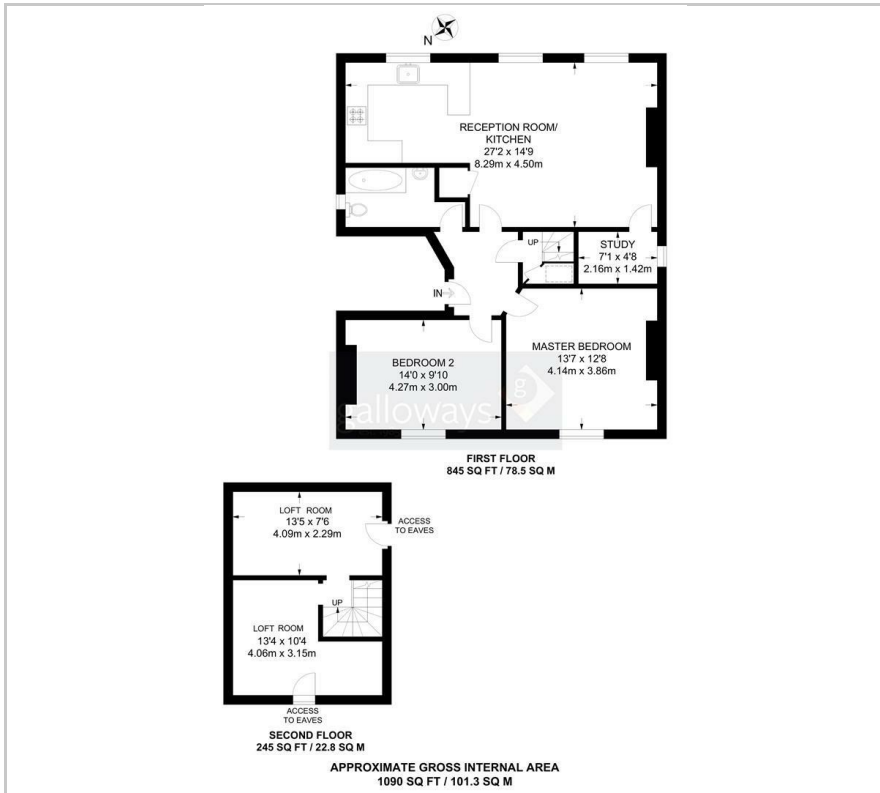

Area Map

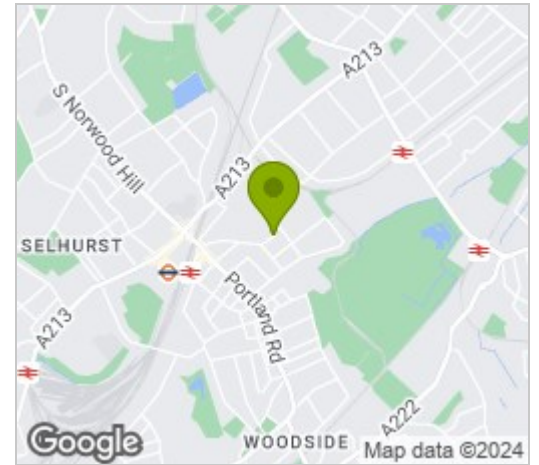

Energy Efficiency Graph

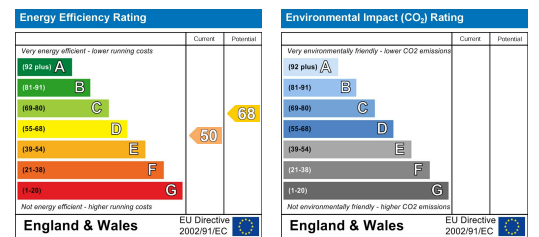

These particulars, whilst believed to be accurate are set out as a general outline only for guidance and do not constitute any part of an offer or contract. Intending purchasers should not rely on them as statements of representation of fact, but must satisfy themselves by inspection or otherwise as to their accuracy. No person in this firm's employment has the authority to make or give any representation or warranty in respect of the property.