



# 33A Worbeck Road

London, SE20 7SW

**Asking Price £450,000**

Welcome to this charming Victorian maisonette located on the sought-after Worbeck Road in London. This delightful property boasts a perfect blend of modern comfort and classic elegance, making it a truly special find.

As you step inside, you are greeted by four cosy bedrooms, there is plenty of room for everyone to enjoy their own private sanctuary. The property features one bathroom, ensuring convenience for all residents.

Dating back to 1900, this Victorian gem exudes character and history. The original period features add a touch of sophistication, while the log burner creates a warm and inviting atmosphere on chilly evenings.

One of the highlights of this property is the 72-foot garden with direct access, providing a tranquil outdoor space perfect for al fresco dining or simply unwinding amidst nature. Situated on the top floor, you can enjoy lovely views and a sense of privacy.

Located on a tree-lined residential street, this maisonette offers a peaceful retreat from the hustle and bustle of city life while still being conveniently close to all amenities. Don't miss the opportunity to make this Victorian beauty your new home sweet home.

Tenure: Leasehold  
Lease Length: 99 Years From 19 April 2004, Lease renewed 30th Sept 2022, 169 years approx remaining

## Viewing

Please contact our Galloways Penge Office on 020 8778 1120 if you wish to arrange a viewing appointment for this property or require further information.

- THREE BEDROOM
- VICTORIAN
- FIRST FLOOR
- DIRECT ACCESS TO GARDEN
- TREE LINED RESIDENTIAL ROAD
- LONG LEASE
- HIGH CEILINGS
- 8 MINUTE WALK TO BIRBECK TRAM STATION
- 12 MINUTE WALK TO ANERLEY STATION
- (ALL WALKING DISTANCES ARE ESTIMATED VIA GOOGLE MAPS)

## Floor Plan

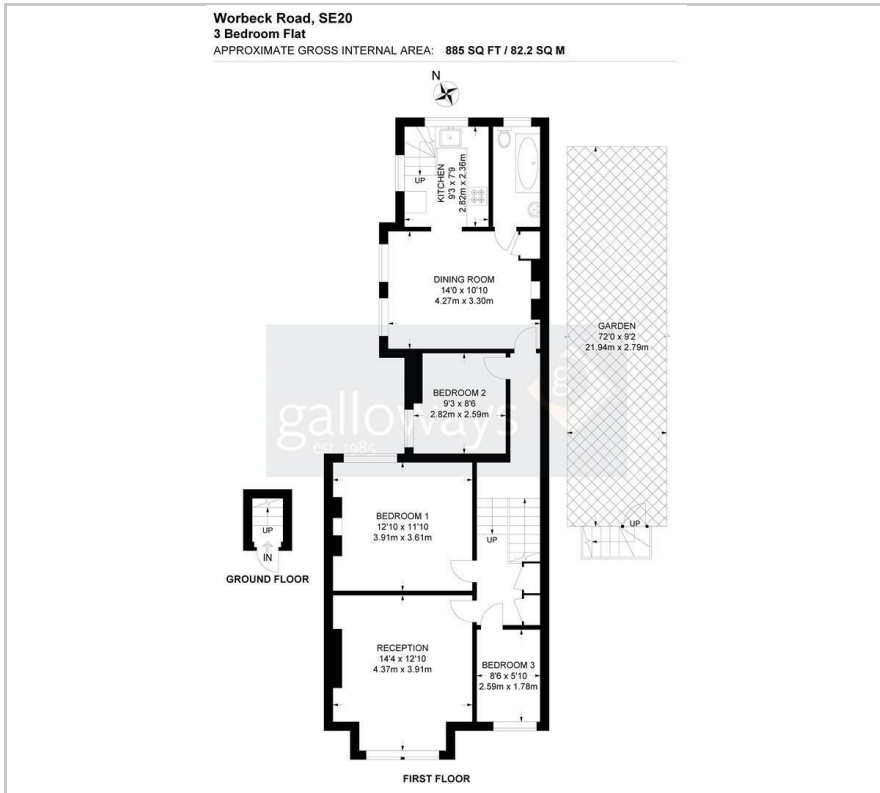

## Area Map



## Energy Efficiency Graph

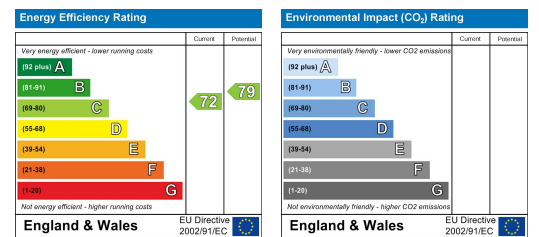

These particulars, whilst believed to be accurate are set out as a general outline only for guidance and do not constitute any part of an offer or contract. Intending purchasers should not rely on them as statements of representation of fact, but must satisfy themselves by inspection or otherwise as to their accuracy. No person in this firm's employment has the authority to make or give any representation or warranty in respect of the property.