



Tall Elms Close

Bromley South, BR2 0TT

Asking Price £650,000

This delightful property is peacefully tucked away within a quiet cul de sac in Bromley South. Offering well-presented accommodation, the family home has some impressive features, not least the four generously proportioned bedrooms all located on the first floor. The modern family bathroom is also on the first floor. Downstairs the bright living areas have a sociable feel, and include a fitted kitchen and a lounge/diner which overlooks the pleasant rear garden. A cloakroom can also be found on the ground floor with the benefit of an attached garage, this superb property is well worth viewing. Offered completely CHAIN FREE.

Council Tax Band F £2509.00

Viewing

Please contact our Galloways Penge Office on 020 8778 1120 if you wish to arrange a viewing appointment for this property or require further information.

- FOUR BEDROOM DETACHED HOUSE
- TWO RECEPTION ROOMS
- IN NEED OF MODERNISATION
- CHAIN FREE
- ATTACHED GARAGE
- OFF STREET PARKING
- 16 MINUTES WALK TO BROMLEY SOUTH STATION
- 5 MINUTES WALK TO SOUTH HILL WOOD
- 19 MINUTES WALK TO LANGLEY PARK GOLF CLUB
- (WALKING TIMES ESTIMATED BY GOOGLE MAPS)

Floor Plan

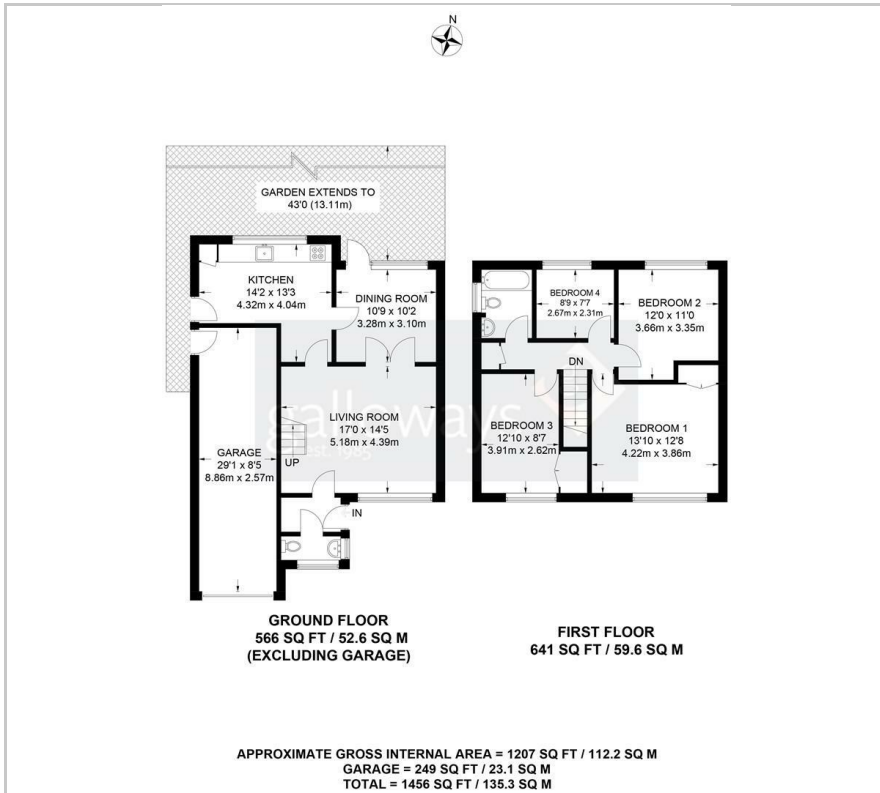

Area Map



Energy Efficiency Graph

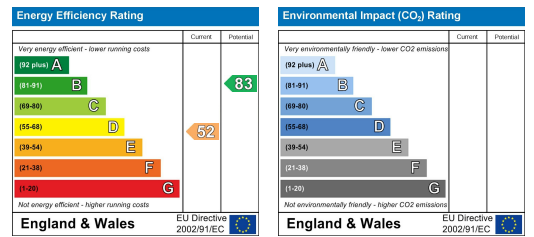

These particulars, whilst believed to be accurate are set out as a general outline only for guidance and do not constitute any part of an offer or contract. Intending purchasers should not rely on them as statements of representation of fact, but must satisfy themselves by inspection or otherwise as to their accuracy. No person in this firm's employment has the authority to make or give any representation or warranty in respect of the property.