



## 35 Kenilworth Road

London, SE20 7QG

**Asking Price £550,000**

A delightful three-bedroom period end-of-terrace house located in the sought-after area of Penge, SE20. This property offers a fantastic opportunity for those looking to create their dream home, with potential for modernisation throughout.

Situated in the heart of Penge, SE20, this property benefits from excellent transport links, local amenities, and reputable schools. Penge East and West stations are within easy reach, providing convenient access to Central London. The surrounding area offers a variety of shops, cafes, and green spaces for residents to enjoy.

Kenilworth Road presents a unique opportunity for buyers to put their stamp on a character-filled property. With a vision for modernisation, this house has the potential to become a stunning and comfortable family home.

Bromley Council Tax Band D £1842.00pa  
Tenure: Freehold

The vendor has provided the above information in good faith. Galloways has not yet had this information verified. Any buyer should seek their independent legal advice before proceeding.

### Viewing

Please contact our Galloways Penge Office on 020 8778 1120 if you wish to arrange a viewing appointment for this property or require further information.

- THREE BEDROOMS
- END OF TERRACE PERIOD HOUSE
- DOUBLE GLAZED WINDOWS
- CENTRAL HEATING
- IN NEED OF MODERNISATION
- NO ONGOING CHAIN
- POTENTIAL TO CONVERT AND EXTEND (SUBJECT TO PLANNING PERMISSIONS)
- 8 MINUTE WALK TO KENT HOUSE STATION
- 13 MINUTE WALK TO CLOCK HOUSE STATION
- (WALKING TIMES ESTIMATED BY GOOGLE MAPS)



## Floor Plan

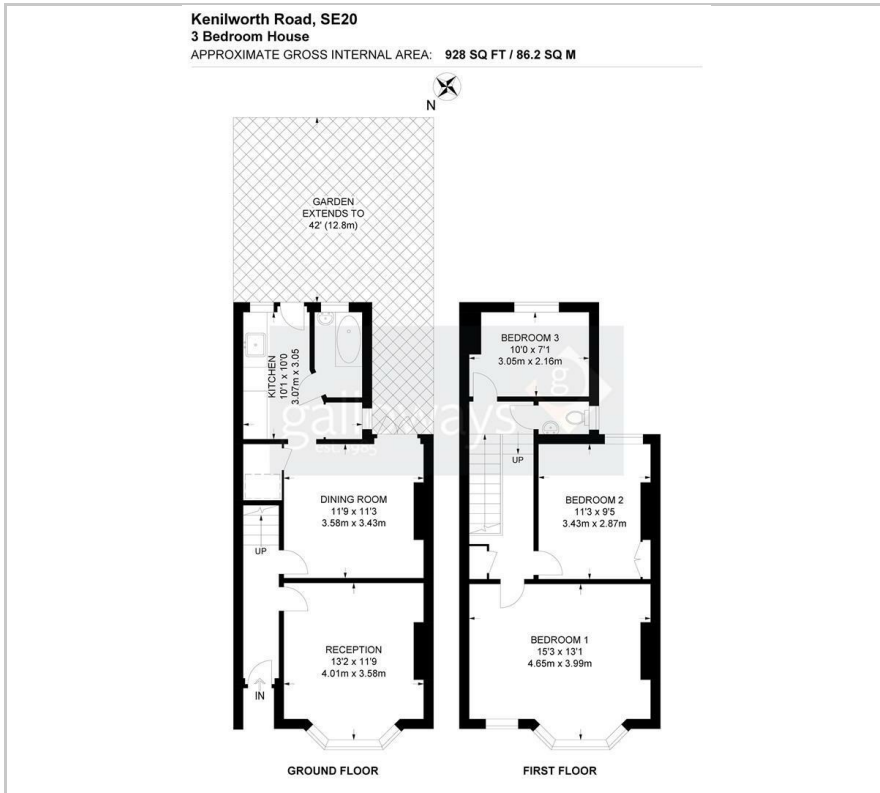

## Area Map



## Energy Efficiency Graph

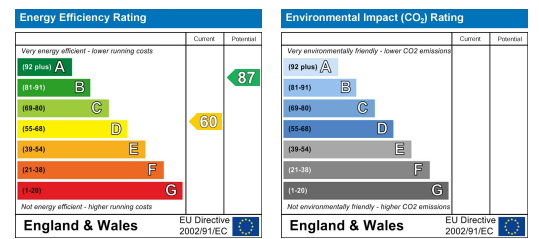

These particulars, whilst believed to be accurate are set out as a general outline only for guidance and do not constitute any part of an offer or contract. Intending purchasers should not rely on them as statements of representation of fact, but must satisfy themselves by inspection or otherwise as to their accuracy. No person in this firm's employment has the authority to make or give any representation or warranty in respect of the property.