



## Flat 11, 6 Eldon Park

London, SE25 4JQ

**Asking Price £260,000**

Situated on the second floor of an impressive building is this two bedroom apartment. With double glazing throughout, neutrally decorated with modern fitted kitchen and bathroom. The flat is being sold with no onward chain is in a residential location with South Norwood Country Park less than half a mile away. The property is ideal for any first time buyer or someone looking for an investment.

Croydon Council Tax Band B £1742.00pa

Tenure: Leasehold

Lease: 992years remaining

Service Charge: £1200.00

Ground Rent: £0.00

The vendor has provided the above information in good faith. Galloways have not yet had this information verified. Any buyer should seek their own independent legal advice before proceeding.

### Viewing

Please contact our Galloways Penge Office on 020 8778 1120 if you wish to arrange a viewing appointment for this property or require further information.

- TOP FLOOR
- TWO DOUBLE BEDROOMS
- MODERN BATHROOM
- MODERN FITTED KITCHEN
- LONG LEASE
- CHAIN FREE
- COMMUNAL GARDEN
- SHARED CAR PARK
- 8 MINUTE WALK TO NORWOOD JUNCTION
- (TIMES ESTIMATED VIA GOOGLE MAPS)



## Floor Plan

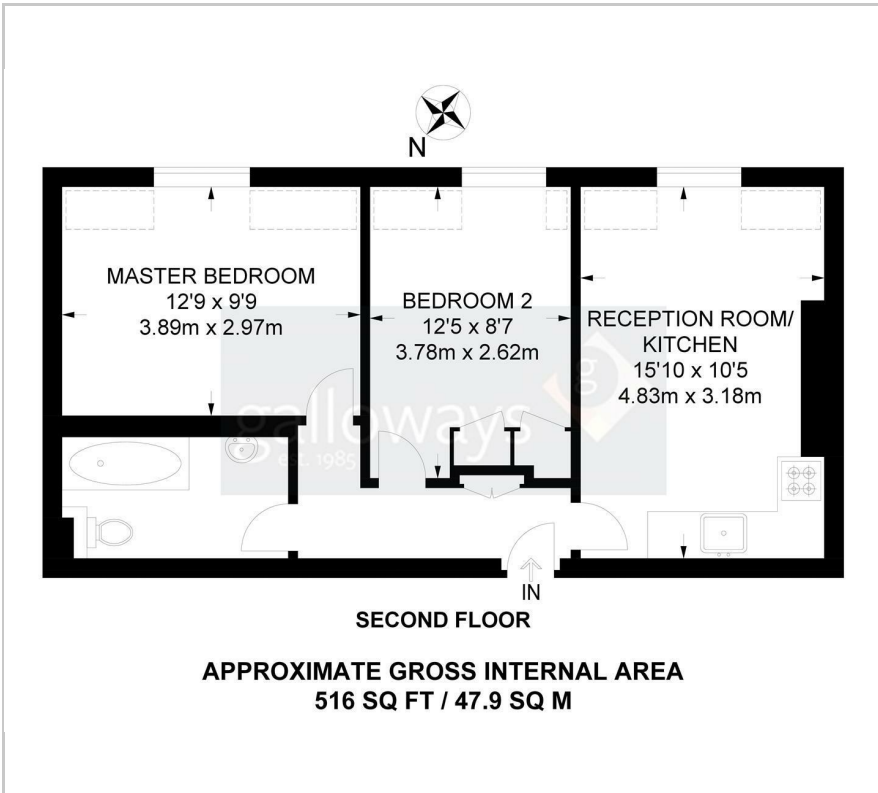

## Area Map



## Energy Efficiency Graph

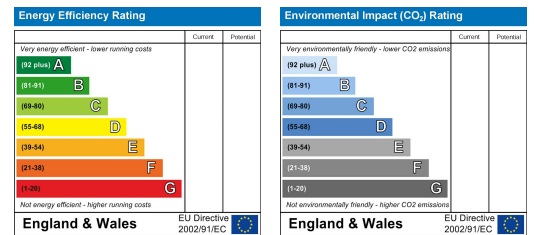

These particulars, whilst believed to be accurate are set out as a general outline only for guidance and do not constitute any part of an offer or contract. Intending purchasers should not rely on them as statements of representation of fact, but must satisfy themselves by inspection or otherwise as to their accuracy. No person in this firm's employment has the authority to make or give any representation or warranty in respect of the property.