



# CROFTS ESTATE AGENTS

PASSIONATE ABOUT PROPERTY

CLEETHORPES  
01472 200666

IMMINGHAM  
01469 564294

LOUTH  
01507 601550

SALES LETTINGS NEW HOME SALES LAND PROPERTY MANAGEMENT AUCTIONS FINANCIAL ADVICE AND MORTGAGES ENERGY PERFORMANCE PROVIDER



**High Holme Road**

**Louth  
LN11 0HE**

**£140,000**

This attractive mid terrace home is an ideal first time buy, located within easy reach of Louth town centre and its many amenities. Internal viewings are highly recommended which will reveal well presented living accommodation throughout, which is briefly comprising of lounge dining room, fitted kitchen dining room, ground floor bathroom suite and two double bedrooms to the first floor. The property benefits from full uPVC double glazing, gas central heating and low maintenance private garden to the rear.

CLEETHORPES: 62 St Peters Avenue, Cleethorpes, DN35 8HP

IMMINGHAM: 21 Kennedy Way, Immingham, DN40 2AB

LOUTH: 3 Market Place, Louth, LN11 9NR

Email: Cleethorpes:

Email: Immingham :

Email: Louth :

info@croftsestateagents.co.uk

immingham@croftsestateagents.co.uk

louth@croftsestateagents.co.uk

[www.croftsestateagents.co.uk](http://www.croftsestateagents.co.uk)





#### Entrance

uPVC door to front opens into lounge dining room

#### Lounge dining room

20' 2" x 11' 11" (6.151m x 3.628m)

uPVC window to front, built in storage cupboard, door to rear opens into kitchen,, radiator

#### Kitchen dining room

13' 3" x 9' 4" (4.041m x 2.840m)

uPVC door to rear leading to rear garden. uPVC window to rear, range of fitted units, incorporating stainless steel sink with draining board, connections for cooker, plumbing for a washing machine, radiator, door to side leads into inner hallway

#### Inner hallway

Door to rear leads into bathroom. Stairs leading to first floor landing

#### Bathroom

7' 7" x 4' 11" (2.305m x 1.497m)

Opaque uPVC window to rear, panelled bath with shower over, close coupled w/c, pedestal wash basin. Tiled walls, radiator

#### First Floor Landing

leads to both bedrooms

#### Bedroom 1

9' 4" x 12' 1" (2.850m x 3.678m)

uPVC window to front, radiator

#### Bedroom 2

10' 1" x 9' 1" (3.065m x 2.771m)

uPVC window to rear, radiator, built in fitted cupboard

#### Outside

The front of the property is approached by a low maintenance garden, enclosed by low level brick walls. The rear garden is private and low maintenance, with wooden storage shed, enclosed by tall wood panel fencing, g

### Tenure

Believed to be Freehold, awaiting solicitors' formal confirmation. All interested parties are advised to make their own enquiries.

### Services

All mains services are understood to be connected, however Crofts have not inspected or tested any of the services or service installations & purchasers should rely on their own survey.

### Viewings

Please contact the relevant marketing office, all viewings are strictly by appointment only please.

### Council Tax Information

Band A: To confirm council tax banding for this property please view the website [www.voa.gov.uk/cti](http://www.voa.gov.uk/cti)

### Free Valuations

We offer a free valuation with no obligation, just call the relevant office or visit [www.croftsestateagents.co.uk](http://www.croftsestateagents.co.uk) seven days a week to arrange for your free valuation.

### Property Management

We offer a full property management service, offering full and comprehensive credit and referencing checks detailed photographic inventories and regular property inspections to name just a few of our services.

### Mortgage and Financial Advice

With access to the whole of the mortgage markets, Crofts Estate Agents in connection with The Mortgage Advice Bureau will help you find the best mortgage to suit your needs. The Mortgage Advice Bureau will act on your behalf in advising you on mortgages and other financial matters

**STATUTORY NOTICE: YOUR HOMES IS AT RISK IF YOU DO NOT KEEP UP REPAYMENTS ON A MORTGAGE OR OTHER LOAN SECURED ON IT.**

Energy Efficiency Rating		
	Current	Potential
Very energy efficient - lower running costs		
(92+) A		
(81-91) B		88
(69-80) C		
(55-68) D	64	
(39-54) E		
(21-38) F		
(1-20) G		
Not energy efficient - higher running costs		
England & Wales		EU Directive 2002/91/EC
WWW.EPC4U.COM		





GROUND FLOOR  
36.2 sq.m. (390 sq.ft.) approx.

1ST FLOOR  
20.3 sq.m. (218 sq.ft.) approx.

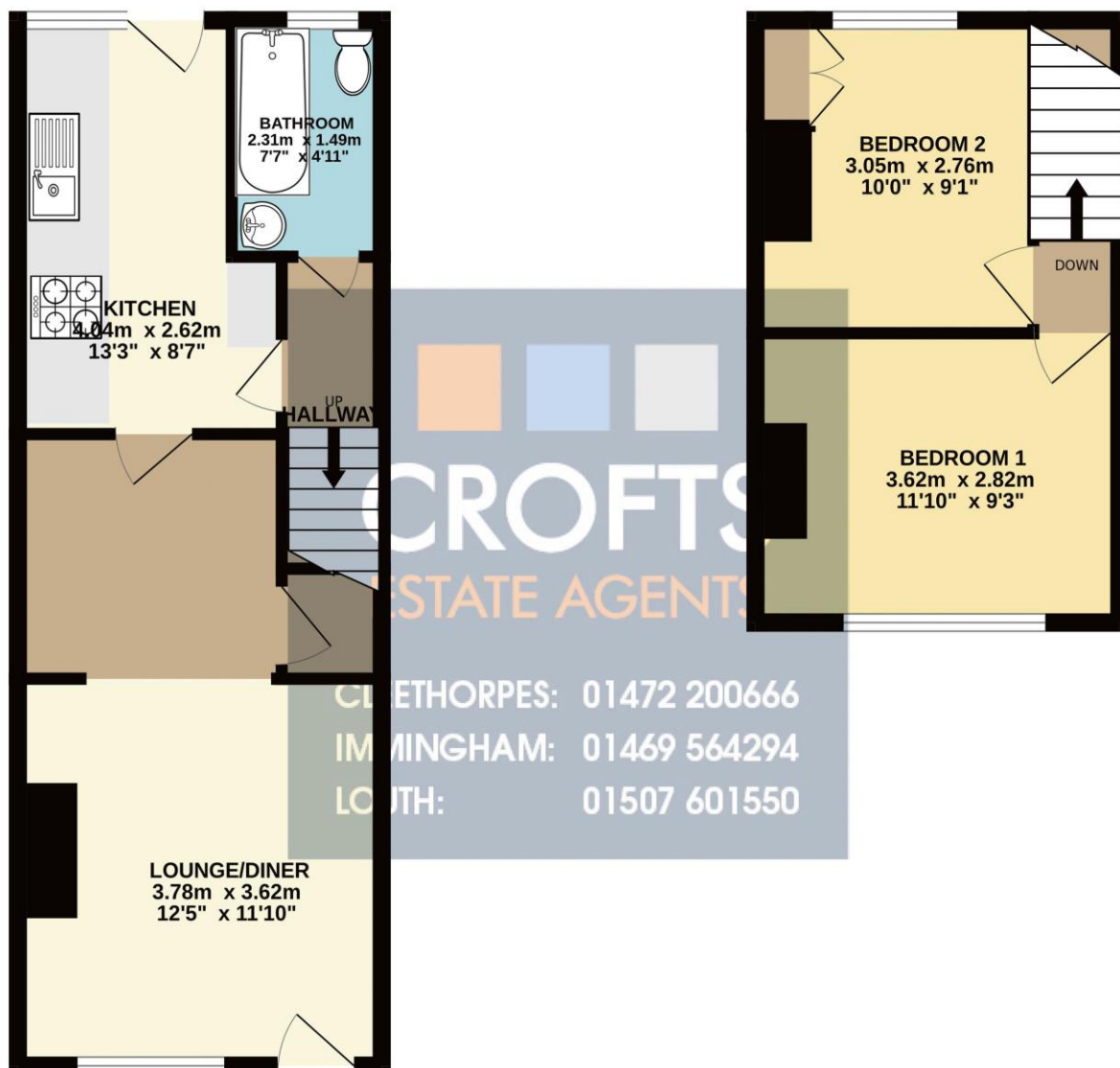

TOTAL FLOOR AREA : 56.5 sq.m. (608 sq.ft.) approx.

Whilst every attempt has been made to ensure the accuracy of the floorplan contained here, measurements of doors, windows, rooms and any other items are approximate and no responsibility is taken for any error, omission or mis-statement. This plan is for illustrative purposes only and should be used as such by any prospective purchaser. The services, systems and appliances shown have not been tested and no guarantee as to their operability or efficiency can be given.  
Made with Metropix ©2025

**DISCLAIMER - IMPORTANT NOTICE REGARDING SALES PARTICULARS** Although we have taken great care to insure the accuracy of the information contained in these particulars, we specifically deny liability for any mistakes, omissions or errors and strongly advise that all proposed purchasers should satisfy themselves by inspection or otherwise, as to their correctness, prior to entering into any commitment to purchase. In particular any information provided in respect of tenure, council tax, rateable values etc has been given in good faith and whilst believed to be correct, may be subject to amendment. Any references to the condition, use or appearance of the property are made for guidance only, and no warranties are given or implied by this information. It is not Crofts policy to check the position with regards to any planning permission or building regulation matters and as such all interested parties are advised to make their own enquires, in order to ensure that any necessary consents have been obtained. All measurements are approximate and are for guidance only and cannot be relied upon. Measurements are taken from wall to wall unless otherwise stated, with the metric conversion shown in brackets. Any plans or maps contained are for identification purpose only, and are not for any other use but guidance & illustration. Crofts have not tested any apparatus, equipment, fixtures, fittings or services including central heating systems and cannot therefore verify that they are in working order, or fit for their intended purpose. These details do not form any part of any contract, and unless specifically stated otherwise, furnishings and contents are not included within this sale.