



Montaigne Close, SW1P

£995,000

Situated in the heart of Westminster, this beautifully presented two-bedroom apartment has been newly renovated to a high standard, offering modern living in one of London's most prestigious locations.

Montaigne Close is conveniently located for the fashionable shops and restaurants in Pimlico and Victoria Street. Transport facilities are excellent with Victoria Station, Pimlico, St James's Park and Westminster Underground Stations within easy reach.

Features

- 24-Hour Concierge
- Private Balcony
- Secure Parking
- Residents Gym
- Two Bedroom
- Third Floor

Montaigne Close, London, SW1P

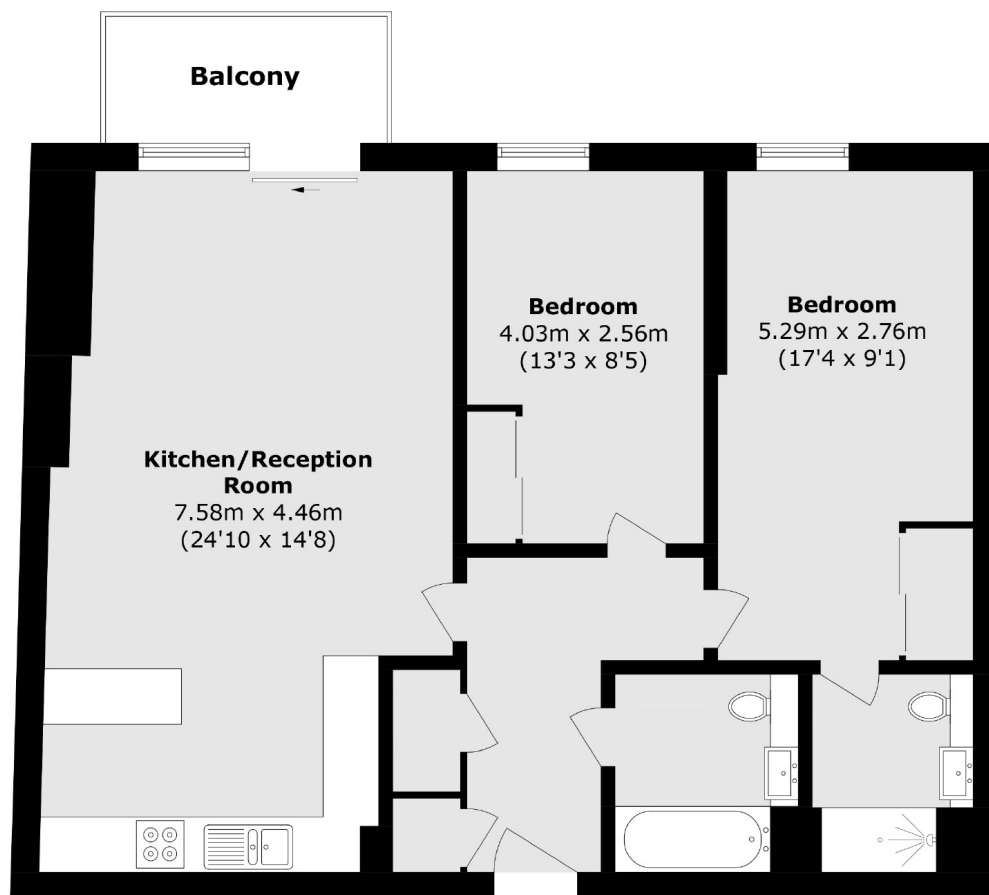

Total area (approx.): 75.6 sq. m (813.7 sq. ft)
Balcony area (approx.): 4.1 q. m (44.1 sq. ft)

Dexters

Westminster
50 Churton Street
London
SW1V 2LP
Sales
020 7590 9570

Energy Rating: C. We aim to make our particulars both accurate and reliable. However they are not guaranteed; nor do they form part of an offer or contract. If you require clarification on any points then please contact us, especially if you're traveling some distance to view. Please note that appliances and heating systems have not been tested and therefore no warranties can be given as to their good working order.

 **RICS** | Regulated
Estate Agent
and Letting Agent

[dexters.co.uk](https://www.dexters.co.uk)