



Ambrosden Avenue, SW1P

£450,000

This bright and spacious lower ground floor apartment is situated in a well-run purpose-built block, with high ceilings, large windows and good storage, this is a delightful property in a wonderful location.

Ambrosden Avenue is positioned within the Westminster Cathedral Conservation Area, minutes from Victoria Street. Transport links are excellent with Victoria transport hub nearby with trains to the South East and the Gatwick Express.

Features

- High Ceilings
- Large Windows
- Purpose Built Block
- Share of Freehold
- Superb Location
- Conservation Area

Ambrosden Avenue, London, SW1P

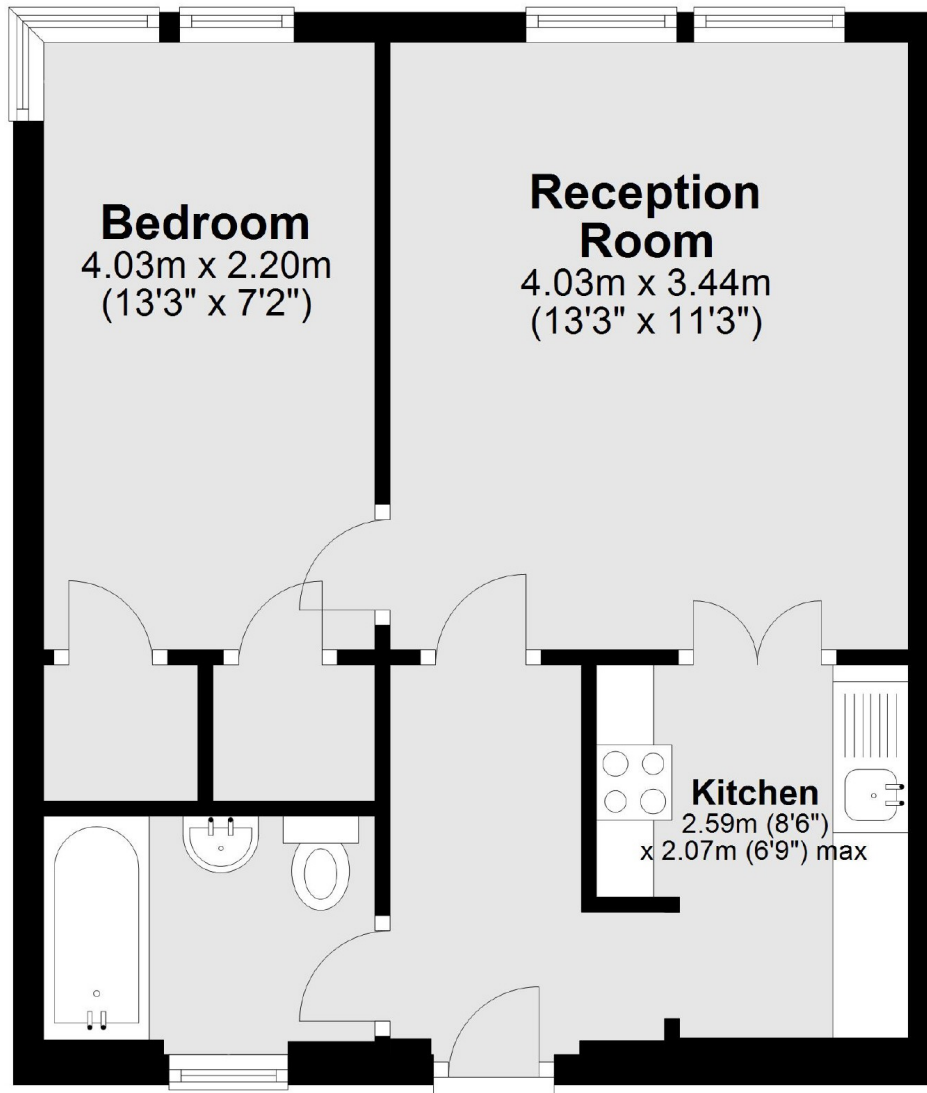

Total area: approx. 38.5 sq. metres (414.4 sq. feet)

Dexters

Westminster
50 Churton Street
London
SW1V 2LP
Sales
020 7590 9570

Energy Rating: E. We aim to make our particulars both accurate and reliable. However they are not guaranteed; nor do they form part of an offer or contract. If you require clarification on any points then please contact us, especially if you're traveling some distance to view. Please note that appliances and heating systems have not been tested and therefore no warranties can be given as to their good working order.

 **RICS** | Regulated
Estate Agent
and Letting Agent

[dexters.co.uk](https://www.dexters.co.uk)