

John Islip Street, SW1P

£460,000

This well presented one-bedroom apartment is located within a sought-after purpose-built development near the iconic Tate Britain and the River Thames. The property offers a spacious double bedroom and an array of amenities, including a 24-hour concierge, lift access, and the convenience of communal hot water and heating.

Residents can also enjoy a stunning communal rooftop terrace.

Millbank Court is positioned on John Islip Street. Ideally located, it offers easy access to the shops, restaurants, and amenities of Marsham Street, Horseferry Road, and Victoria Street. With excellent transport connections just a short walk away, it provides both convenience and a peaceful atmosphere in a central London location.

Features

- Communal Roof Terrace
- One Double Bedroom
- No Onward Chain
- 24 Hour Porter
- Eighth Floor
- Lift

**John Islip Street,
London, SW1P**

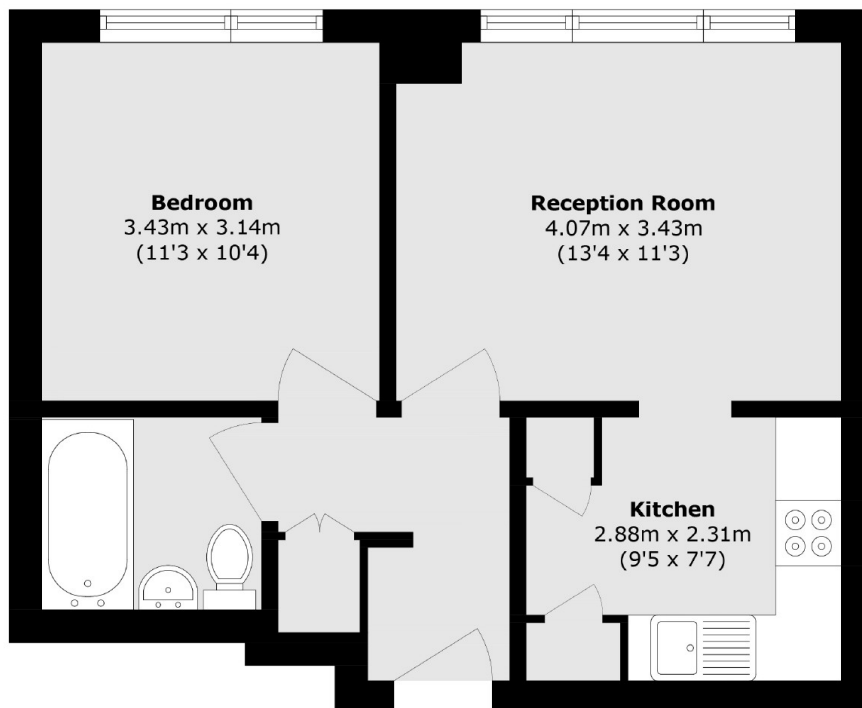

Total area (approx.): 41.0 sq. m (441.3 sq. ft)

Dexters

Westminster
50 Churton Street
London
SW1V 2LP
Sales
020 7590 9570

Energy Rating: C. We aim to make our particulars both accurate and reliable. However they are not guaranteed; nor do they form part of an offer or contract. If you require clarification on any points then please contact us, especially if you're traveling some distance to view. Please note that appliances and heating systems have not been tested and therefore no warranties can be given as to their good working order.

 **RICS** | Regulated
Estate Agent
and Letting Agent

dexters.co.uk