



Belgrave Road, SW1V

£650,000

A fantastic two-bedroom apartment, within a stucco-fronted building in the heart of Pimlico. This property benefits from an open-plan kitchen and reception room, offering an ample amount of natural light. Presented to the market with no onward chain.

Belgrave Road is located in the heart of Pimlico, featuring a variety of shops and restaurants right on the doorstep. Transport links are excellent, with Pimlico tube station and the Victoria transport hub nearby.

Features

- Close To Transport Links
- Stucco Fronted Building
- No Onward Chain
- Two Bedrooms
- Fourth Floor
- Lift

Belgrave Road, London, SW1V

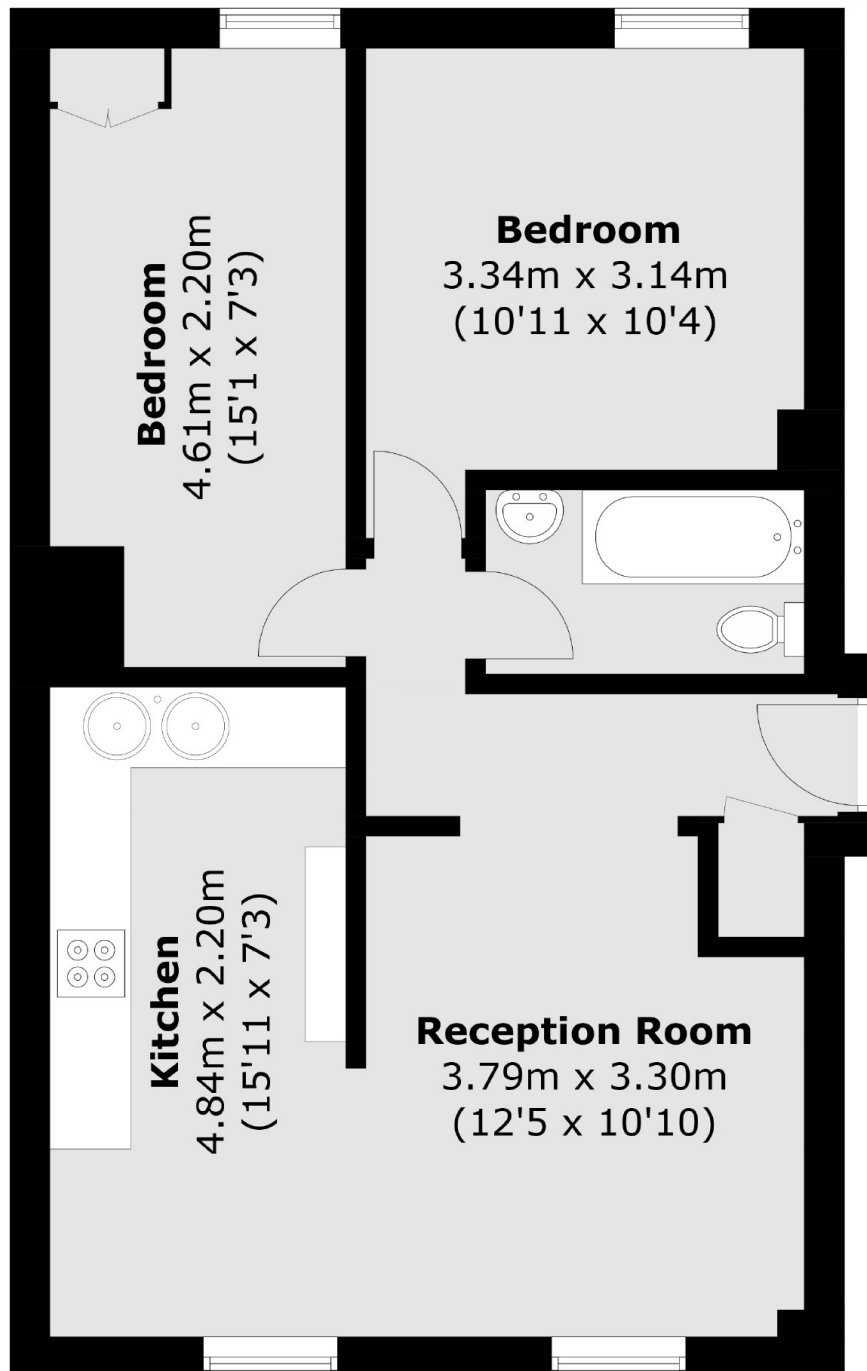

Total area (approx.): 54.2 sq. m (583.4 sq. ft)

Dexters

Westminster
50 Churton Street
London
SW1V 2LP
Sales
020 7590 9570

Energy Rating: C. We aim to make our particulars both accurate and reliable. However they are not guaranteed; nor do they form part of an offer or contract. If you require clarification on any points then please contact us, especially if you're traveling some distance to view. Please note that appliances and heating systems have not been tested and therefore no warranties can be given as to their good working order.

 **RICS** | Regulated
Estate Agent
and Letting Agent

[dexters.co.uk](https://www.dexters.co.uk)