



Gloucester Street, SW1V

£575,000

This charming two-bedroom apartment is situated on the third floor of a beautiful period building. The property features a spacious reception room, a separate kitchen, and two generously sized double bedrooms.

Gloucester Street is situated on the desirable "Pimlico Grid" and has excellent local shopping facilities. Victoria and Pimlico stations are located nearby.

Features

- Two Double Bedrooms
- Third Floor
- Share Of Freehold
- No Chain
- Period Building
- Pimlico Grid

Gloucester Street, London, SW1V

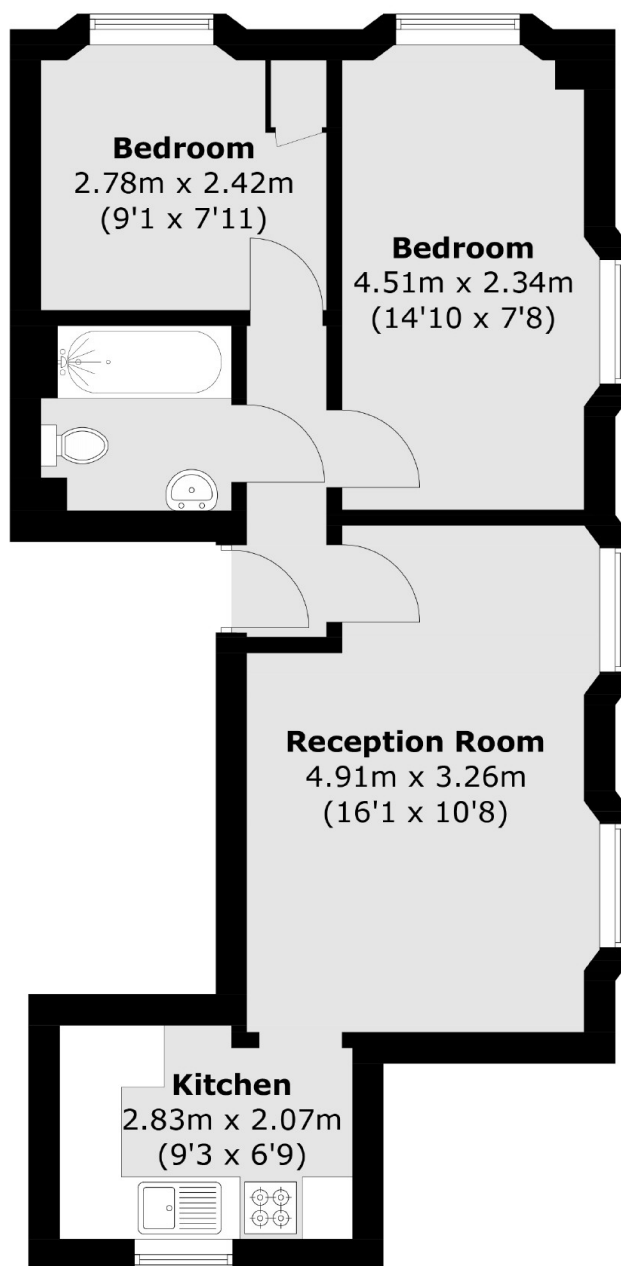

Total area (approx.): 46.3 sq. m (498.4 sq. ft)