



Gillingham Street, SW1V

£960,000

A spacious first floor apartment situated in a desired purpose built block, with access to Eccelston Square. This bright property benefits from two double bedrooms and separate reception room.

Sovereign Court is located within walking distance of Victoria station, offering mainline rail services including the Gatwick Express and underground service on the Victoria line and District and Circle Line; The Jubilee line is one stop from Victoria at Green Park.

Features

- Access To Eccelston Square
- Share Of Freehold
- Close To Transport Links
- Two Doubles Bedrooms
- Two Bathrooms
- No Onward Chain
- Lift

Gillingham Street, London, SW1V

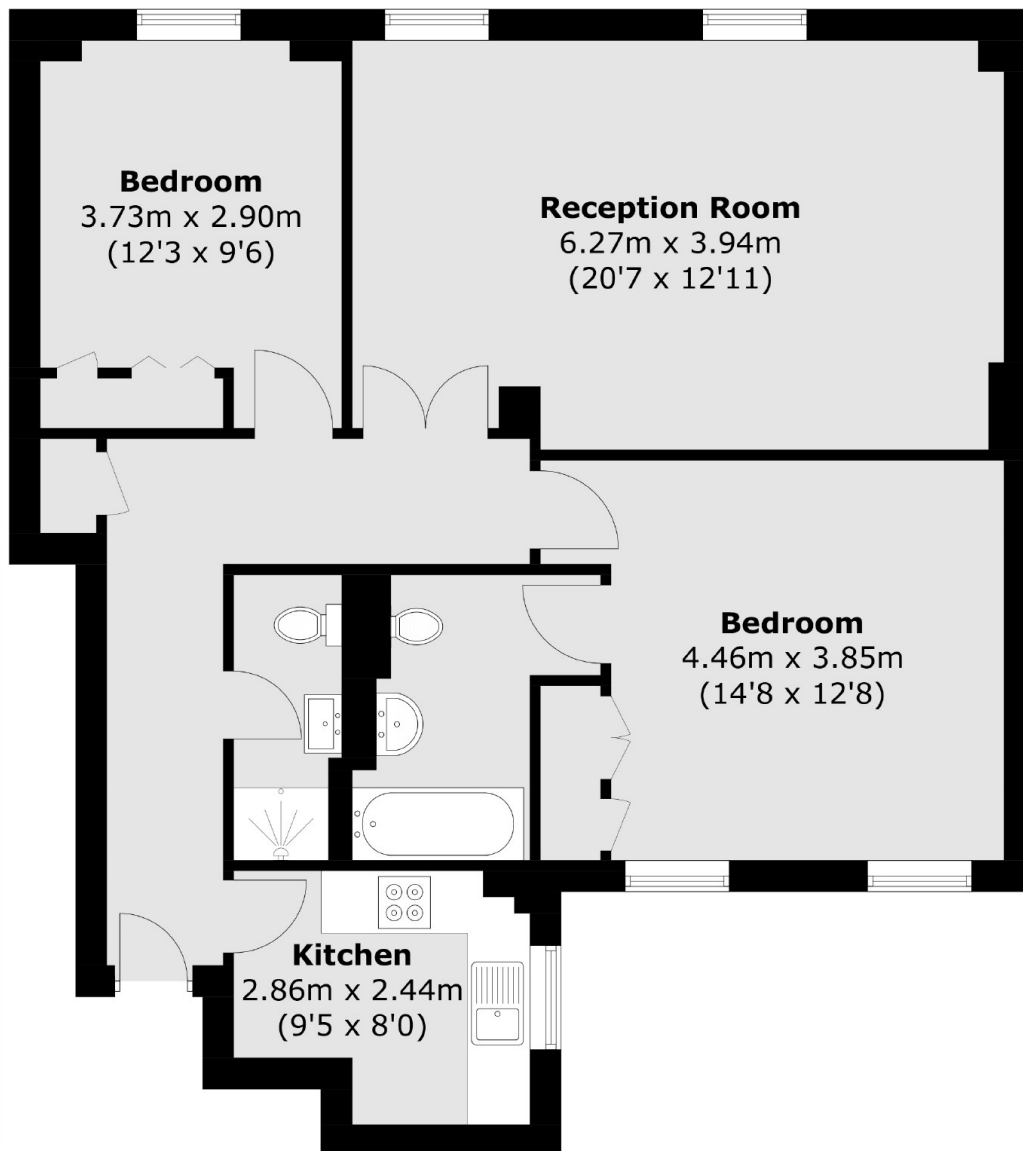

Total area (approx.): 79.0 sq. m (849.9 sq. ft)