



## Marsham Street, SW1P £600,000

Situated on the seventh floor of the prestigious St Johns Building. This flat has wonderful views over St Johns Gardens and the building benefits from 24 hour porter and gym facilities.

Located on Marsham Street just moments from The Tate Britain and within walking distance of the amenities of Victoria Street and the transport connections of Westminster, Pimlico and St James's Park Underground Stations.

### Features

- One Double Bedroom
- Seventh Floor
- Lift
- Gym & Sauna
- 24h Concierge
- Separate Kitchen

**Marsham Street,  
London, SW1P**

## **Seventh Floor**

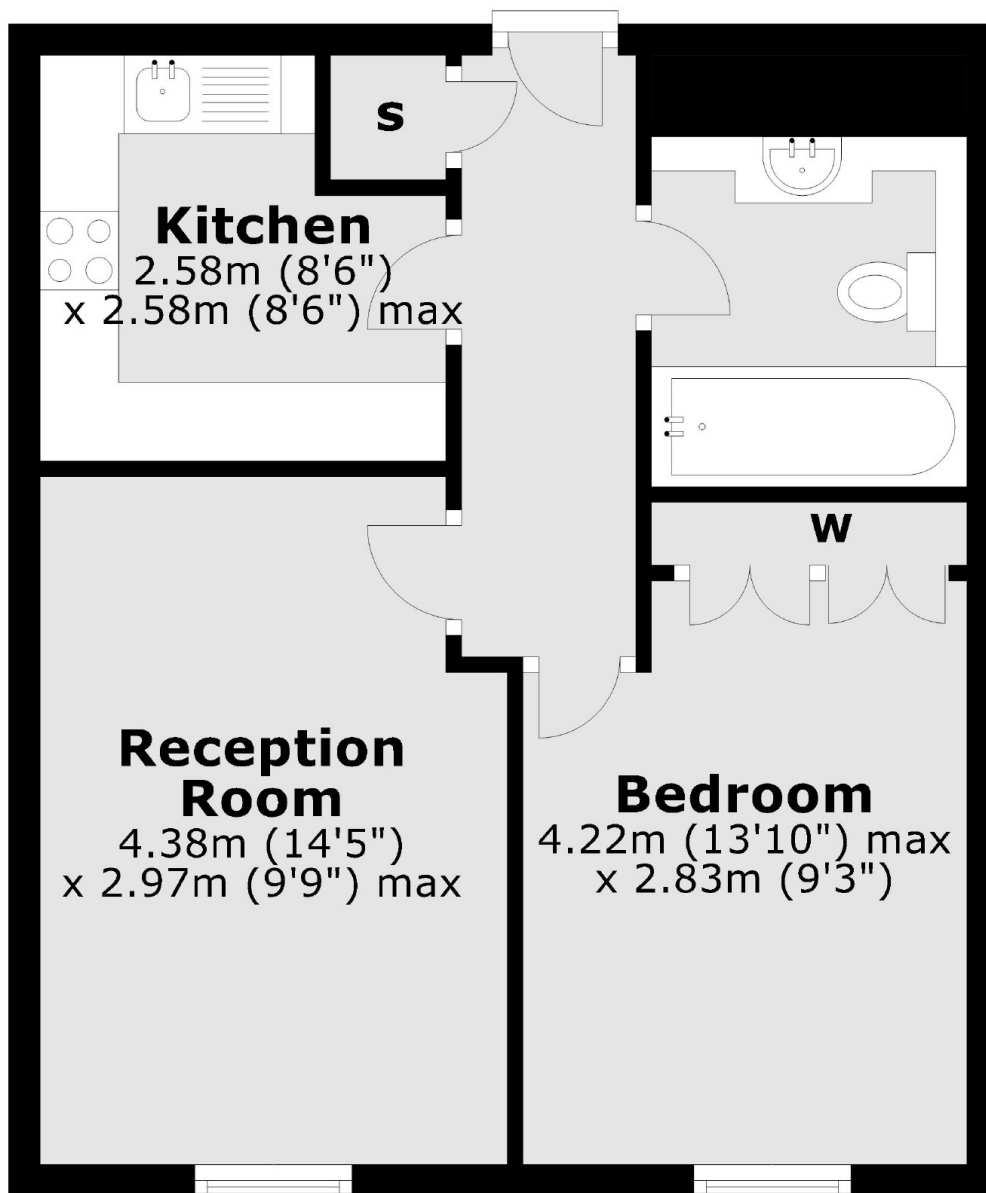

area: approx. 41.7 sq. metres (449.0 sq.