



## Churchill Gardens, SW1V

### £350,000

A newly refurbished studio property situated within Maitland House on the ground floor, with a private patio and access to communal gardens to the rear. The property also benefits from built in appliances in the kitchen (washing machine & fridge) and brand new bathroom.

Forming part of the Churchill Gardens Estate it is ideally located for the amenities of Lupus Street and Battersea Park as well as the transport connections of Victoria & Pimlico Stations and Sloane Square.

### Features

- Ground Floor
- Impeccable Finish
- Private Patio
- Shared Garden
- Brand New Kitchen/Bathroom
- No Chain

# Churchill Gardens, London, SW1V

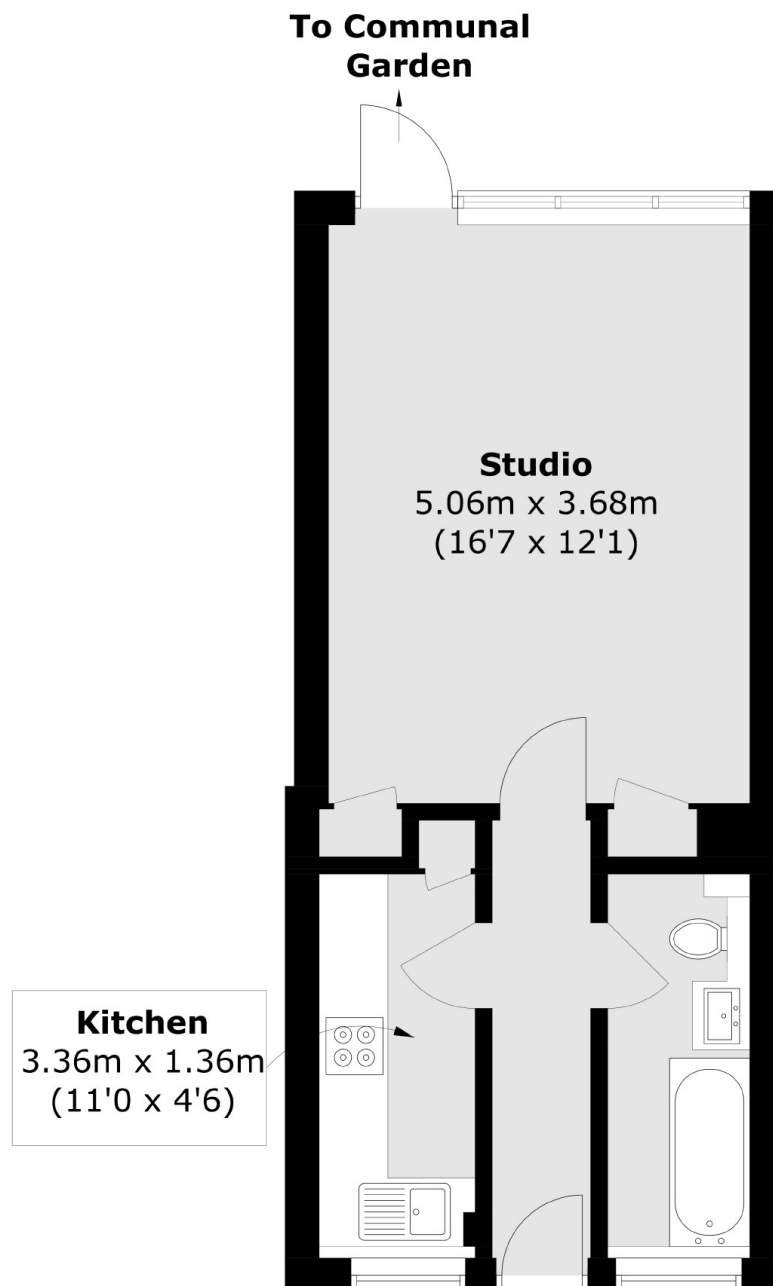

Total area (approx.): 33.8 sq. m (363.8 sq. ft)