



## Moreton Street, SW1V

£299,000

A well proportioned studio apartment on the raised ground floor of this purpose built block. This apartment benefits from views over the communal gardens and a large reception room with a drop- down bed to maximise space.

Moreton Street is positioned within a sought-after location in the heart of Pimlico, close to the public gardens of St. George's Square and a variety shops, bars and restaurants. Transport links are excellent with Pimlico Tube and Victoria transport hub nearby.

### Features

- Excellent Transport Links
- Communal Roof Terrace
- Raised Ground Floor
- No Onward Chain
- Gated Entrance
- Studio

Moreton Street,  
London, SW1V

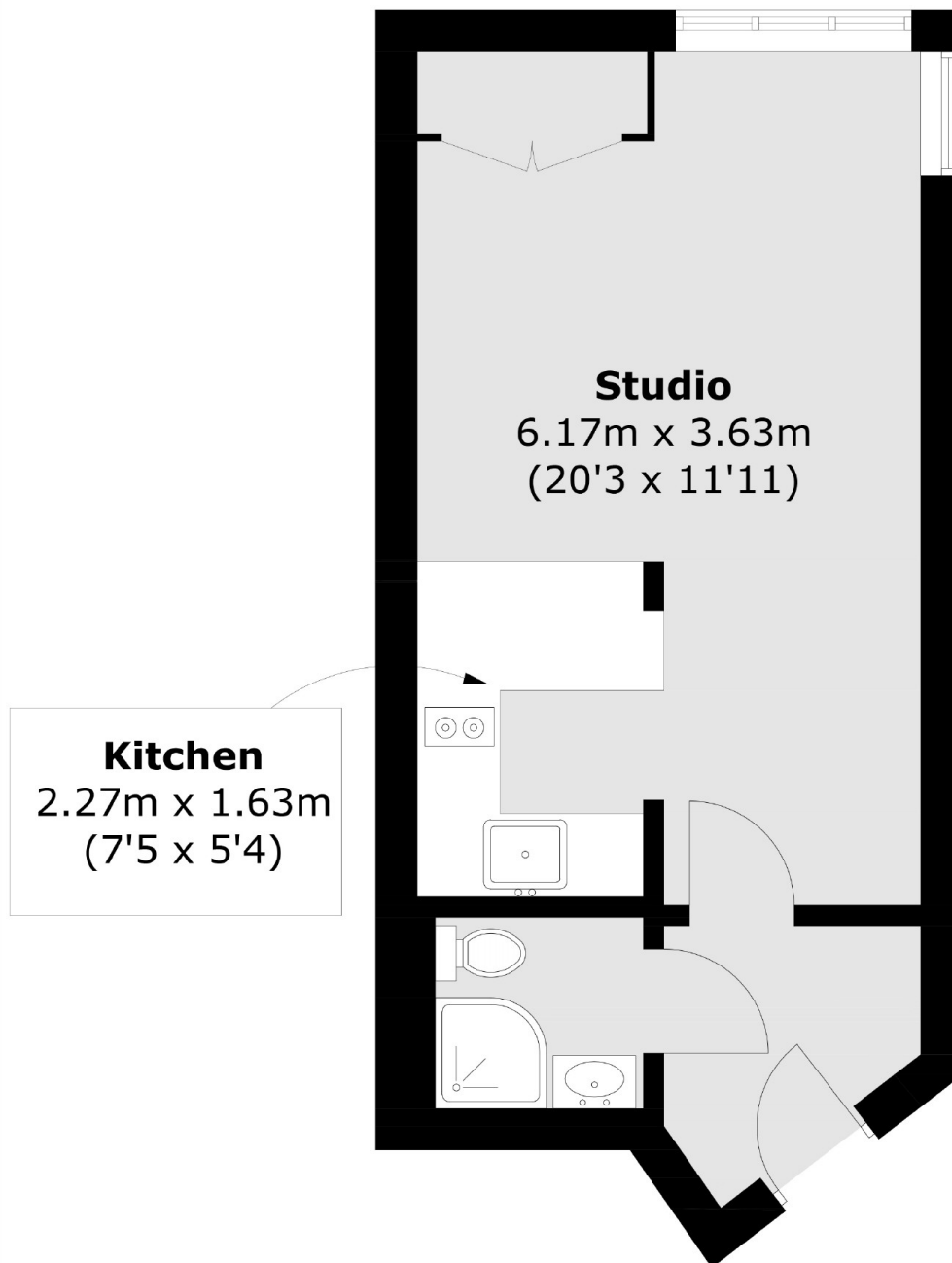

Total area (approx.): 28.3 sq. m (304.6 sq. ft)

**Dexters**

Westminster  
50 Churton Street  
London  
SW1V 2LP  
Sales  
020 7590 9570

Energy Rating: D. We aim to make our particulars both accurate and reliable. However they are not guaranteed; nor do they form part of an offer or contract. If you require clarification on any points then please contact us, especially if you're traveling some distance to view. Please note that appliances and heating systems have not been tested and therefore no warranties can be given as to their good working order.

 **RICS** | Regulated  
Estate Agent  
and Letting Agent

[dexters.co.uk](http://dexters.co.uk)