

Ambrosden Avenue, SW1P

£500,000

This bright and spacious lower ground floor apartment is situated in a well-run purpose-built block, with high ceilings, large windows and good storage, this is a delightful property in a wonderful location.

Ambrosden Avenue is positioned within the Westminster Cathedral Conservation Area, minutes from Victoria Street. Transport links are excellent with Victoria transport hub nearby with trains to the South East and the Gatwick Express.

Features

- High Ceilings
- Large Windows
- Purpose Built Block
- Share of Freehold
- Superb Location
- Conservation Area

Ambrosden Avenue, London, SW1P

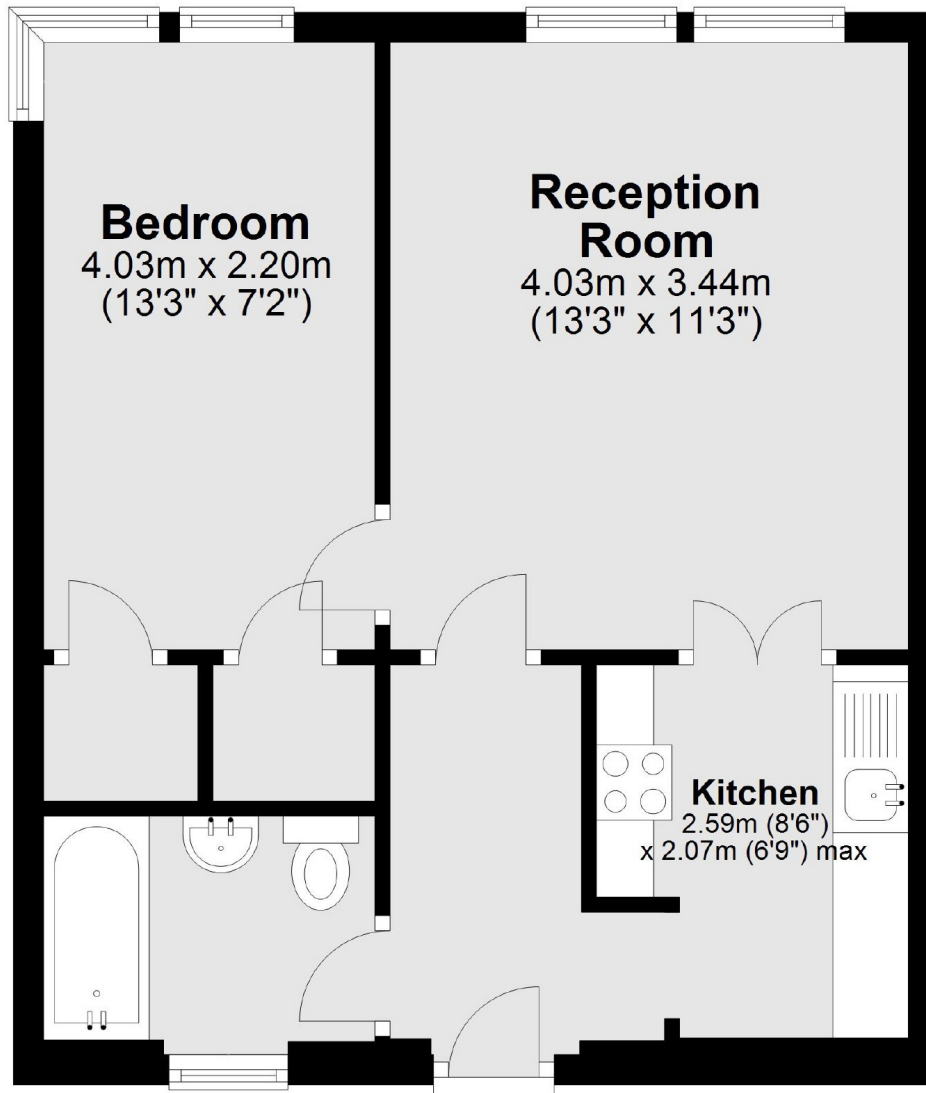

Total area: approx. 38.5 sq. metres (414.4 sq. feet)