

## Ambrosden Avenue, SW1P

£525,000

This charming one bedroom apartment is located on the lower ground floor within an impressive period mansion block. This property benefits from no onward chain, share of freehold and fantastic high ceilings.

The location is very convenient as it is just a five-minute walk to both Victoria underground and mainline station, as well as St. James's Park underground. Additionally, there are plenty of amenities located nearby on Victoria Street.

### Features

- High Ceilings
- Mansion Block
- No Onward Chain
- Share Of Freehold
- Lower Ground Floor
- Close To Transport Links

# Ambrosden Avenue, London, SW1P

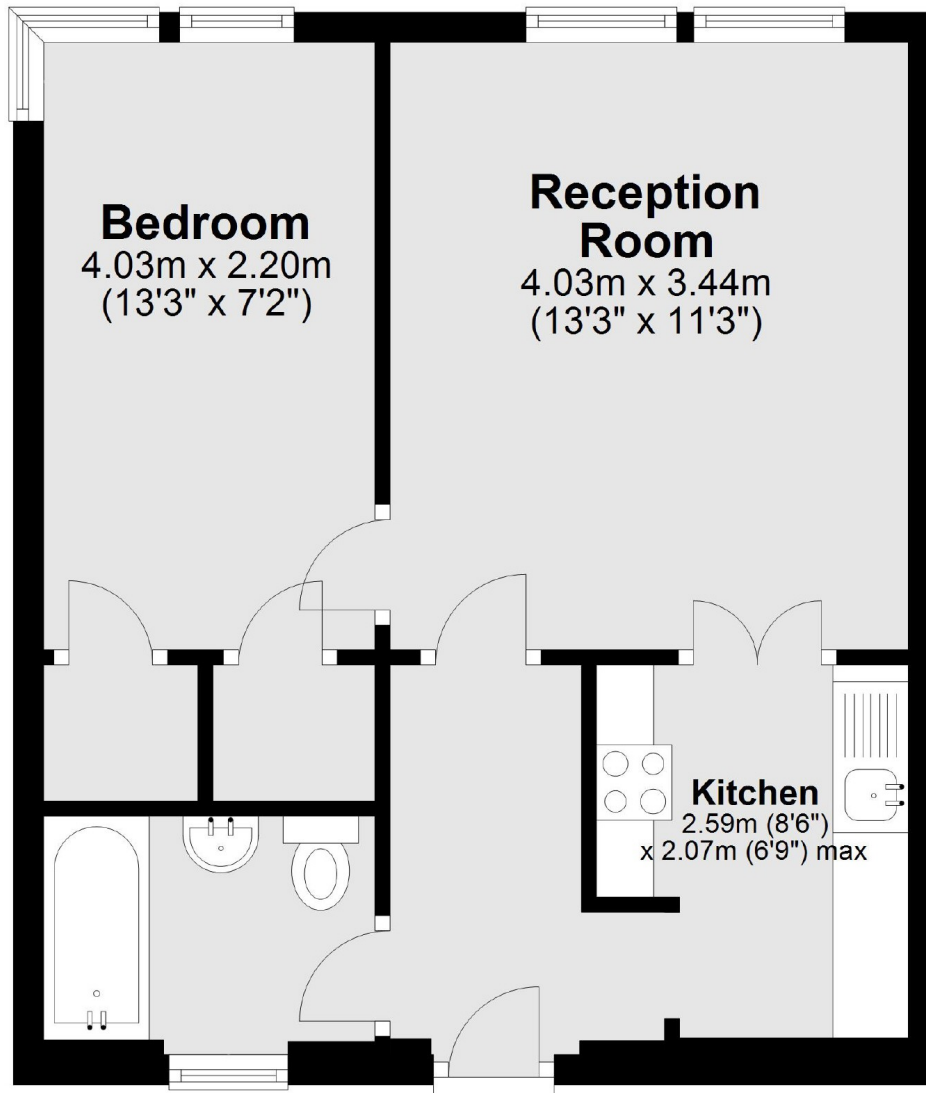

Total area: approx. 38.5 sq. metres (414.4 sq. feet)