



Catherine Place, SW1E

£610,000

Located on the ground floor, this property features a bright and spacious living/dining room, a modern fitted kitchen, a double bedroom with built-in wardrobes, and a bathroom suite. The property is presented in good condition throughout. The building offers a large communal courtyard garden, basement storage space, and a phone entry system. This flat would be perfect as a pied-a-terre.

This is an excellent location equidistant from St James's Park tube station and Victoria train, tube and bus terminals. A host of restaurants, cafés, shops and other amenities are in the vicinity making this an ideal area for a family.

Features

- No Chain
- Ground Floor
- St. James Ward
- Communal Courtyard
- Storage Unit
- Lease Extended in 2022

Catherine Place, London, SW1E

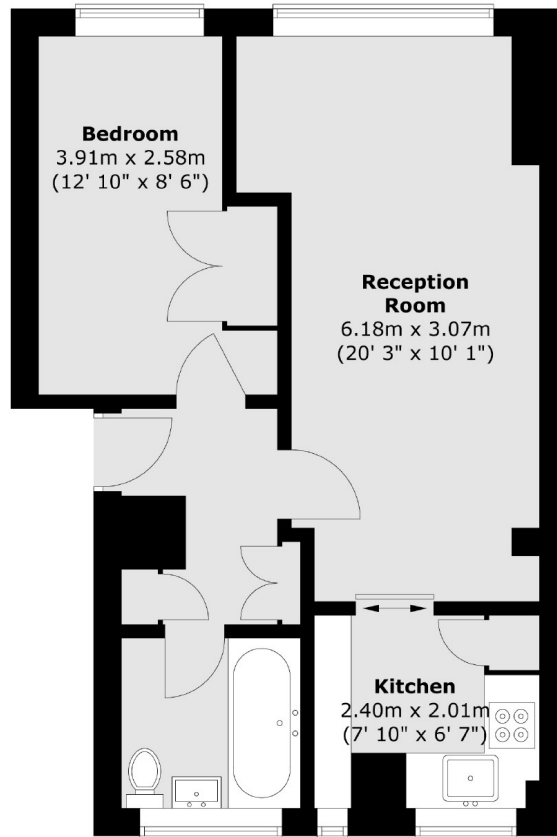

Total area (approx.) : 41.9 sq. m (451 sq. ft)