



Tachbrook Street, SW1V

£565,000

Situated on the first floor and presented in excellent condition throughout, this flat has a generous sized open plan kitchen reception room and bedroom with walk in wardrobe.

Tachbrook Street is ideally located and is a short walk from both Pimlico and Victoria Stations, along with the shops, bars and restaurants available in the wider area.

Features

- First Floor
- One Bedroom
- Balcony
- Period Conversion
- Open Plan Kitchen
- Close Transport

Tachbrook Street, London, SW1V

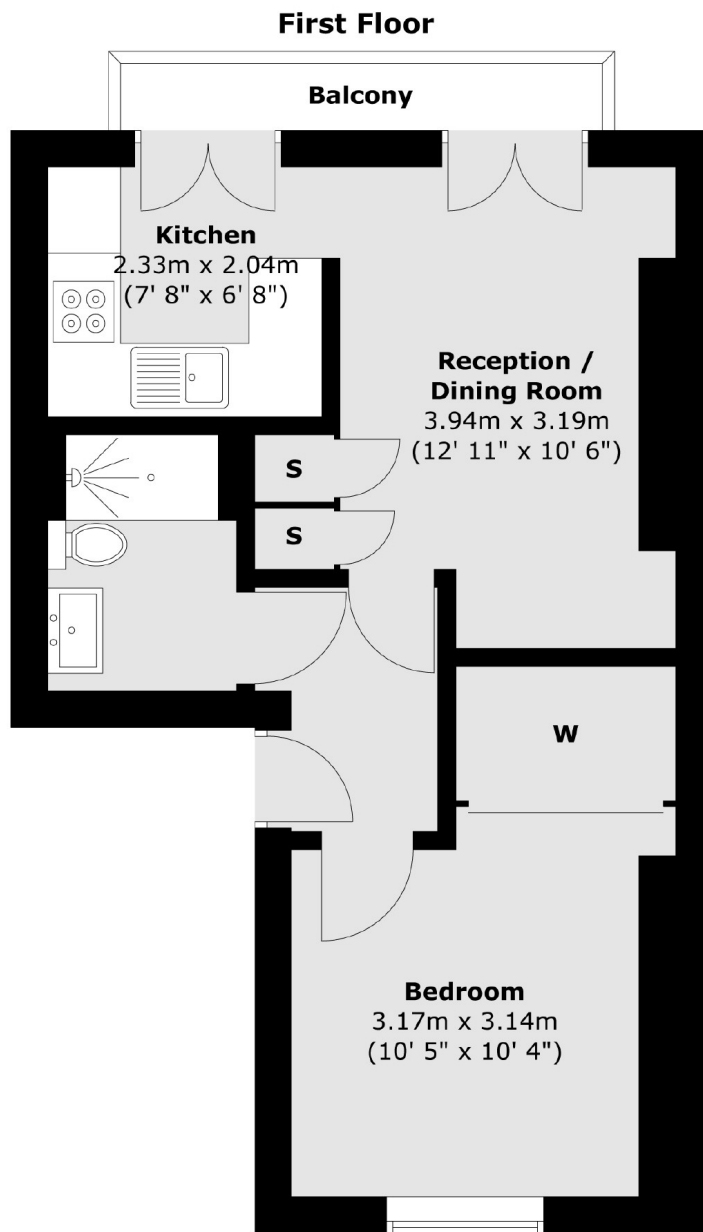

Total area (approx.) : 35.8 sq. m (385 sq. ft)
Total balcony area (approx.) : 2.2 sq. m (24 sq. ft)