



Rochester Row, SW1P

£550,000

A well presented one bedroom flat located in a desirable block in Westminster. The property benefits from a porter and secure underground parking

Rochester Row is located just north of the attractive Vincent Square and is conveniently situated for all the amenities of Pimlico & Victoria.

Features

- Lift
- Porter
- No Chain
- Long Lease
- Convenient Location
- Secure Underground Parking

Rochester Row, London, SW1P

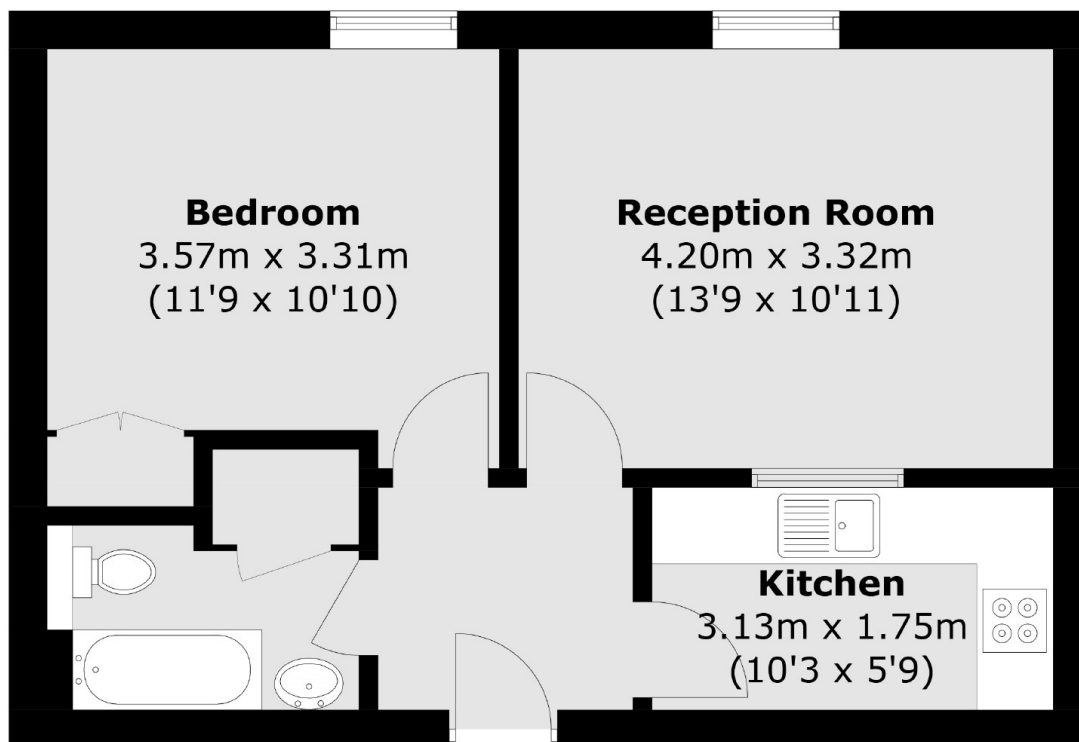

Total area (approx.): 41.2 sq. m (443.5 sq. ft)