

18 Hastings Drive, Newcastle Upon Tyne, NE27 0FL

Offers Over £130,000

Hive Estates are delighted to present this beautifully refurbished top floor apartment with two bedrooms and two bathrooms, set within the popular Hastings Drive development in Shiremoor. Finished to a high standard, this stylish home is completely turnkey and ready to move into.

The spacious open-plan living and kitchen area is flooded with natural light, featuring wood effect laminate flooring and a contemporary neutral decor. With plenty of room for both living and dining, it's the perfect space to relax or entertain. The kitchen has been designed with both style and practicality in mind, offering sleek high gloss grey handleless units, white marble-effect worktops, and a classic metro-tiled splashback. A full range of integrated appliances is included oven, hob, fridge, freezer, and dishwasher making this a truly modern setup.

The impressive master bedroom is generously proportioned and benefits from built-in wardrobe storage. Its en-suite bathroom has a luxury feel, complete with marble effect wall and floor tiles, a walk in waterfall shower, vanity basin with storage, WC, illuminated mirror, and on-trend black fittings. A versatile second bedroom, finished with wood-effect flooring and neutral décor, provides an ideal space for a guest room, home office, or dressing room. The main bathroom mirrors the high quality finish of the en-suite, offering a bath with overhead shower, vanity basin, WC, illuminated mirror, towel rail, and sleek black fittings.

Externally, the development is well maintained and this apartment comes with the added benefit of allocated parking. Perfectly positioned, it offers excellent access to the coast while also being within easy reach of Newcastle city centre.

Lounge/Diner 13'9" x 13'5" (4.20 x 4.10)

Kitchen Area 7'0" x 8'0" (2.15 x 2.45)

Bedroom 1 17'6" x 9'4" (5.35 x 2.85)

Shower Room 6'10" x 6'6" (2.10 x 2.00)

Bedroom 2 8'8" x 11'3" (2.65 x 3.45)

Bathroom 6'10" x 6'6" (2.10 x 2.00)

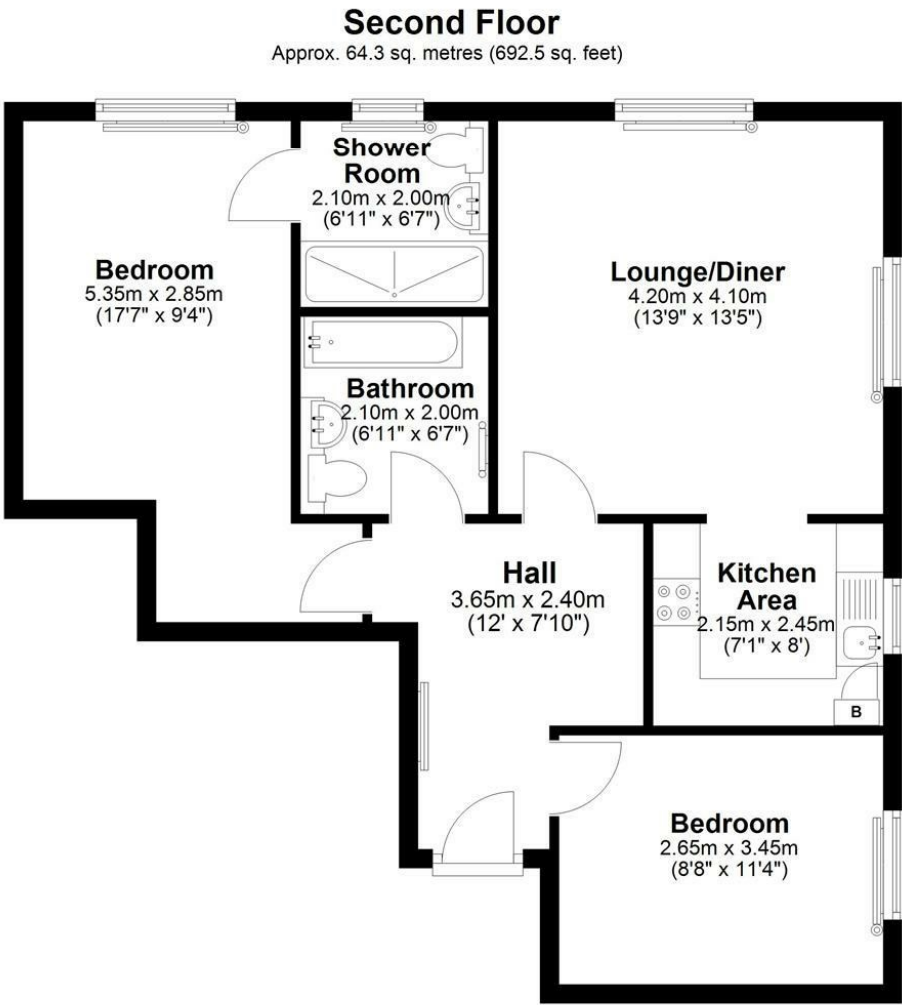

Total area: approx. 64.3 sq. metres (692.5 sq. feet)

Area Map



Energy Efficiency Graph

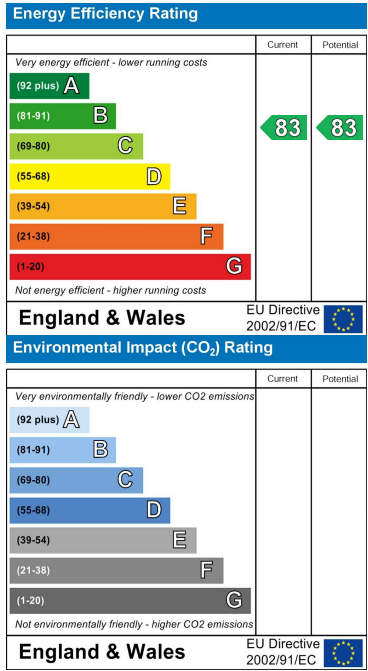

These particulars, whilst believed to be accurate are set out as a general outline only for guidance and do not constitute any part of an offer or contract. Intending purchasers should not rely on them as statements of representation of fact, but must satisfy themselves by inspection or otherwise as to their accuracy. No person in this firms employment has the authority to make or give any representation or warranty in respect of the property.