



53 Chirton Green, North Shields, NE29 0JR

Offers Over £165,000

Hive Estates presents to the market this beautifully presented three bedroom terraced family home in the heart of North Shields. With a charming front garden, a generous rear yard, and stylish interiors throughout.

Stepping inside, you are welcomed into a spacious living room with soft grey carpet, neutral decor, and a striking feature fireplace. Large windows flood the space with natural light, creating a bright and airy atmosphere. The kitchen and dining area is equally impressive, featuring wood effect herringbone flooring, sleek black cabinets, white marble effect worktops, and classic white tiled splashbacks. A breakfast bar provides the perfect spot for casual dining, while the integrated oven and five ring gas hob make this a true cook's kitchen. On the opposite side of the room, a generous dining space with a bold feature wall is ideal for family meals or entertaining guests.

Upstairs, the master bedroom is a bright and spacious retreat, enhanced by stylish wall panelling and large windows. The second bedroom offers a vibrant focal point with bold wall art, while the third is full of charm with colourful decor both are generous in size and finished with grey carpets for a cohesive, modern feel. The bathroom is finished to a high standard, with floor to ceiling grey marble effect tiling, a shower over the bath, a vanity basin unit, and sleek black fittings.

To the rear of the property is a large yard, perfect for outdoor entertaining, with access to the back lane. At the front, a small garden with flower beds adds to the home's curb appeal. Situated in a fantastic location close to local shops, amenities, and the popular Fish Quay, and just a short distance from Tynemouth and Whitley Bay beaches, this home is perfectly positioned to enjoy the best of coastal and community living.

Lounge 14'8" x 11'9" (4.48 x 3.60)

Kitchen/Diner 9'6" x 18'4" (2.90 x 5.60)

Bedroom 1 13'1" x 8'2" (4.00 x 2.51)

Bedroom 2 11'1" x 10'5" (3.40 x 3.20)

Bedroom 3 8'8" x 8'8" (2.65 x 2.65)

Bathroom 5'1" x 7'6" (1.55 x 2.30)

Ground Floor

Approx. 41.3 sq. metres (444.7 sq. feet)

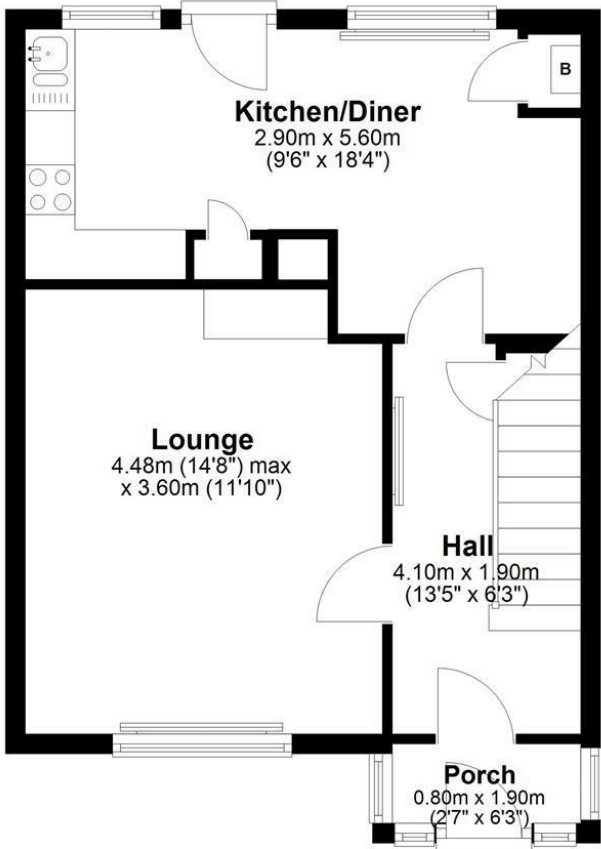

First Floor

Approx. 41.1 sq. metres (442.3 sq. feet)

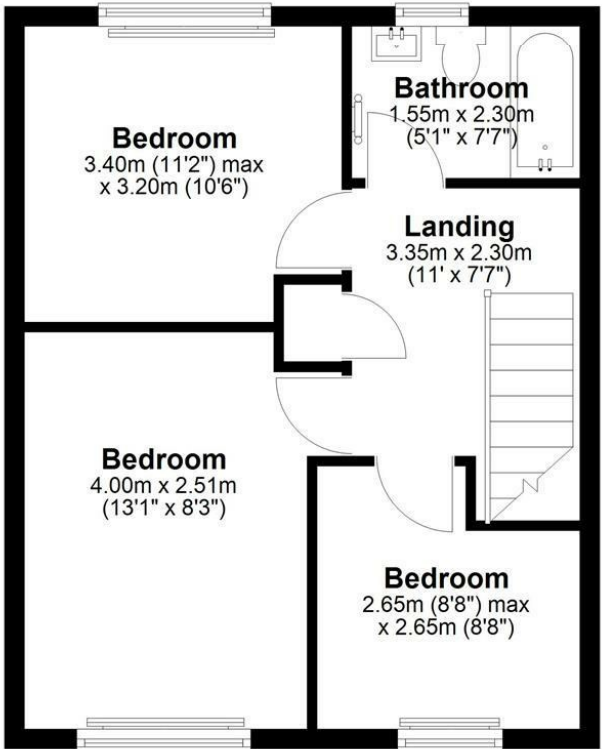

Total area: approx. 82.4 sq. metres (887.0 sq. feet)

Area Map



Energy Efficiency Graph

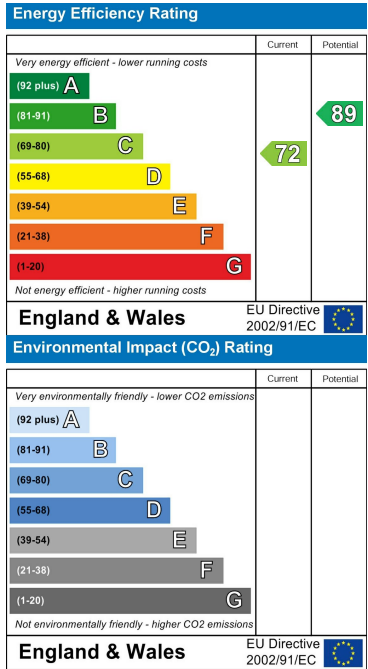

These particulars, whilst believed to be accurate are set out as a general outline only for guidance and do not constitute any part of an offer or contract. Intending purchasers should not rely on them as statements of representation of fact, but must satisfy themselves by inspection or otherwise as to their accuracy. No person in this firms employment has the authority to make or give any representation or warranty in respect of the property.