



HIVE ESTATES



13 Monkridge Court, Gosforth, NE3 1YW

Offers Over £115,000

Hive Estates presents this stylish top floor two-bedroom apartment in South Gosforth.

Situated equidistant between Ilford Road and South Gosforth Metros, this property is walking distance to Gosforth high-street and the amenities of West Jesmond. The apartment has a large lounge with floor to ceiling glazing, looking out over the surrounding greenery.

From the lounge there is a smart kitchen with wooden cabinetry, granite effect worktops and beautiful natural light.

The two bedrooms are spacious, both easily fitting a double bed and storage. Each bedroom has durable carpet, large windows and neutral decor. There is a bright family bathroom with a bath, shower, WC and pedestal basin, white tiled walls contrasted by the colourful tiling on the floor. Comes with a garage and lease has been extended to 150 yrs from 2012 with no ground rent, which cost over £7,000.



Floor Plan

4TH FLOOR
556 sq.ft. (51.7 sq.m.) approx.

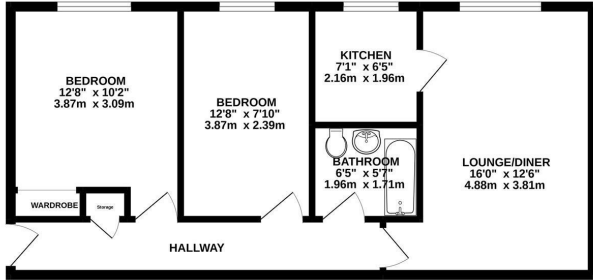

MONKBRIDGE COURT, NE3 1YW
TOTAL FLOOR AREA: 556 sq.ft. (51.7 sq.m.) approx.
We do not accept any liability for the accuracy of the information contained herein. Measurements of doors, windows, rooms and any other items are approximate and no responsibility is taken for any error, omission or misstatement. This plan is for general guidance only and should be used as such by any prospective purchaser. The services, fixtures and fittings shown here are not guaranteed and no guarantee as to their quality or efficiency can be given.
Home-visit ref: 10222



Area Map



Energy Efficiency Graph

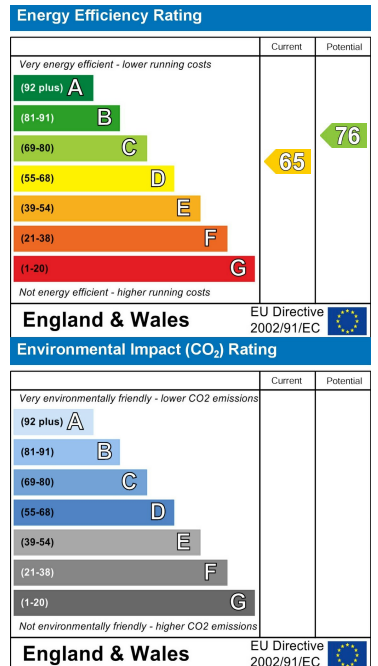

These particulars, whilst believed to be accurate are set out as a general outline only for guidance and do not constitute any part of an offer or contract. Intending purchasers should not rely on them as statements of representation of fact, but must satisfy themselves by inspection or otherwise as to their accuracy. No person in this firm's employment has the authority to make or give any representation or warranty in respect of the property.