



COURT LODGE

Sowton, Exeter, Devon, EX5 2AE

complete.
thoroughly good property agents



COURT LODGE

Sowton, Exeter, Devon, EX5 2AE

The property is located in Sowton Village, just a short distance from the new town of Cranbrook, with local shops, amenities, schools, supermarkets and a train station with links to Exeter and London Waterloo. The area is surrounded by East Devon countryside and Sidmouth, Budleigh Salterton and Exmouth beaches are all a short drive away.

The A30 & M5 are also close by, giving easy access to Exeter and Plymouth & Northwards to Bristol.

- Detached Victorian Lodge House
- Village location - close to Exeter and A30/M5
- Two bedrooms
- Two reception rooms and a kitchen
- First floor bathroom
- IN NEED OF REFURBISHMENT
- Circa 0.17 acre plot - with wrap-around gardens
- Double garage and off-road parking
- Grade II Listed
- Individual characterful home with architectural importance



Detached
Home



Village
Location



2
Bedrooms



4
Bathrooms



2 Reception
rooms



Garage,
off-road parking



Large
garden



Council
tax band: D

E
P
C
Rating:
G

STEP INSIDE

Set off Sowton Lane with a large hedgerow offering complete visual privacy, the Lodge House is accessed just off the side lane through the gate pillars, where the gabled porch with its characterful “gabled with wavy barge boarding” greets you. Here, you walk into the main Living Room with a central log burner fireplace and bay window overlooking the gardens. From this room, you walk on to the dining room, again with a bay window overlooking the Sowton Lane hedgerow, stairs to the first-floor accommodation and access directly into the kitchen. The central internal wall is characteristically dressed limestone. The kitchen has a range of cupboards, work surfaces, sink/drain, space for fridge/freezer, electric cooker point, plumbing for a dishwasher and a large window overlooking the gardens. A barn-style door leads to the side. Here, just off the kitchen, is a utility area, giving extra space.

The first floor has two spacious bedrooms, lovely views and a modern shower room, all with plenty of natural light.

The gardens wrap around the property. Private enclosed offering a blank canvas to be re-modelled, designed and landscaped. A double garage with storage above sits to the rear of the plot and off-road parking is in front.





AGENTS NOTE

The property is Grade II listed (see below details) & needs refurbishment throughout. Buyers are advised to conduct their own due diligence regarding refurbishment & improvement works. Heating is currently via the log burner in the Living Room & standalone electric radiators. We have been advised that there is a boiler, however we do not know that any central heating or hot water system is working.

Buyers are welcome to arrange for suitably qualified professionals to visit & inspect the property whilst conducting a viewing.

For any further information or questions prior to viewing, please contact Stuart Sealey, stuart.sealey@completeproperty.co.uk



GRADE II LISTING DETAILS

SOWTON SOWTON LANE (east side) SX 99 SE 1/50 Court Lodge with gatepiers - and gate 19.12.74 - II

Former lodge to Bishop's Court. 1834. Snecked limestone; gabled end slate roof. Single-depth plan cottage, with 2 rooms, with an entrance lobby with large porch set right of centre; central axial stack with C20 brick shaft. 1 1/2 storeys. Front: (facing drive) : porch to right, gabled with wavy barge boarding, with an elliptical chamfered stone arch; to the left of this is a 2-light casement window with transom, and a separately gabled half dormer with traceried triangular head to the 2-light casement window. Left-hand end faces the road with a 2:4:2 pane canted bay, with single lancet window to gable wall; prominent barge boarding. Right-hand end : 2-light casement window to gable wall, with hood mould; ground floor with canted bay, as to the other end. A C20 rear wing has been added, of 2 storeys, reconstituted stone to ground floor, slate-hung above. The associated gate piers, of limestone, square section, with pyramidal caps, and the wooden gate, traceried, with fleur-de-lis to upper rail, are included in this listing.



COURT LODGE

Sowton, Exeter, Devon, EX5 2AE

TOTAL APPROXIMATE FLOOR AREA
1073 SQ FT/ 99.6 SQ M

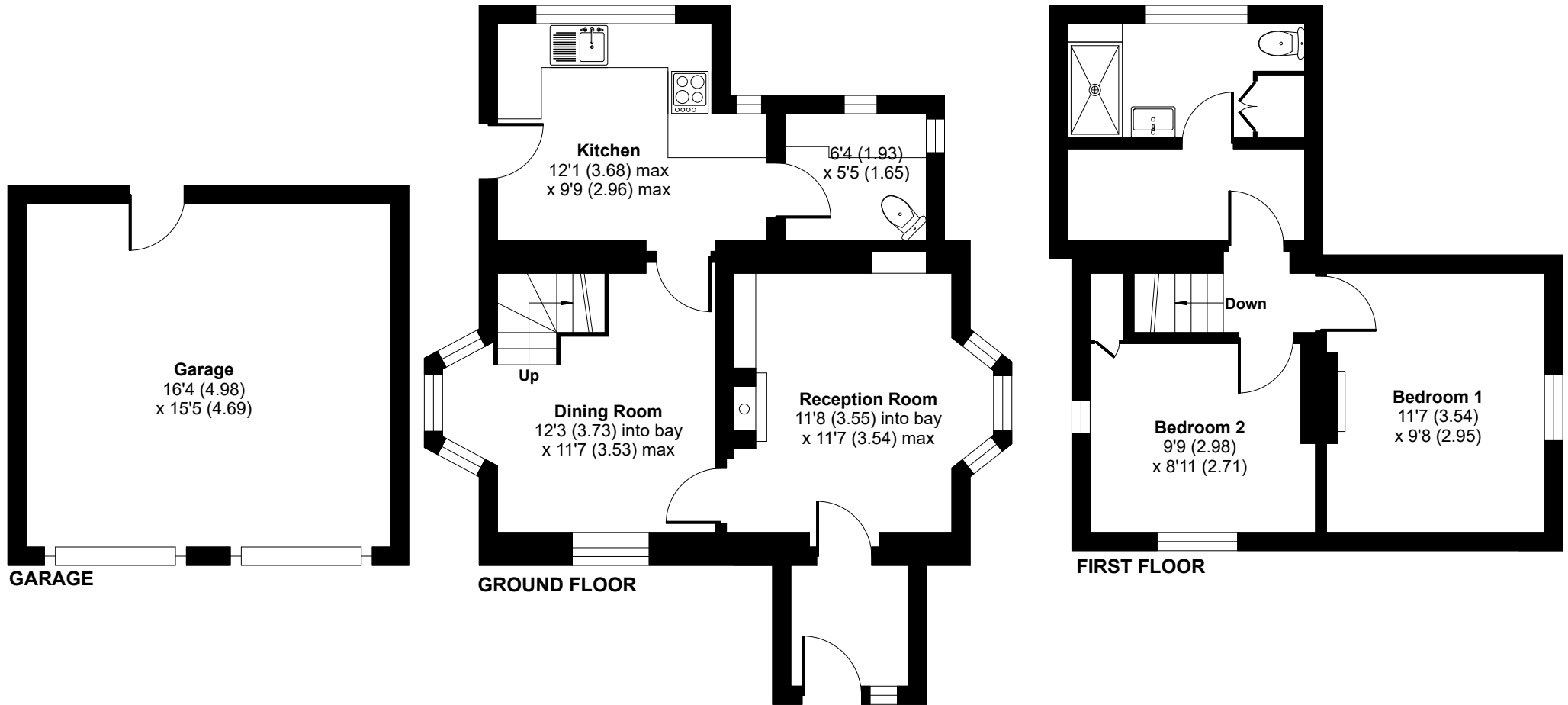

Whilst every attempt has been made to ensure the accuracy of the floor plans contained here, measurements of doors windows, rooms, and any other items are approximate and no responsibility is taken for any error, omission or mis-statement. This plan is for illustrative purposes only and should be used as such by any prospective purchaser. The services, systems and appliances shown have not been tested and no guarantee as to their operability or efficiency can be given.

Get in touch with Complete Exeter to find out more and to book your viewing:

01392 422 500

exeter@completeproperty.co.uk

141 Younghayes Road, Cranbrook, Exeter EX5 7DR

Our note. For clarification we have prepared these sales particulars as a general guide and have not carried out a detailed survey nor tested the services, appliances or fittings. Room sizes should not be relied upon for carpets or furnishings. If there are any important matters which are likely to affect your decision to buy, please contact us before viewing this property. These particulars, whilst believed to be accurate, are set out as a general outline only for guidance and do not constitute any part of an offer or contract. Intending purchasers should not rely on them as statements of representation of fact, but must satisfy themselves by inspection or otherwise as to their accuracy. No person in the employment of Complete Property Services has the authority to make or give any representation or warranty in respect of the property. SKETCH PLAN FOR ILLUSTRATIVE PURPOSES ONLY. All measurements and sizes and locations of walls, doors, window fittings and appliances are shown conventionally and are approximate only and cannot be regarded as being a representation either by the Seller or his Agent. We hope that these plans will assist you by providing you with a general impression of the layout of the accommodation. The plans are not to scale nor accurate in detail. © Unauthorised reproduction prohibited. As part of the service we offer we may recommend ancillary services to you which we believe will help with your property transaction. We wish to make you aware that should you decide to proceed we will receive a referral fee. This could be a fee, commission, payment or other reward. We will not refer your details unless you have provided consent for us to do so. You are not under any obligation to provide us with your consent or to use any of these services, but where you do you should be aware of the following referral fee information. You are also free to choose an alternative provider. To find out more about this, please speak to a member of the team.



complete.

thoroughly good property agents