

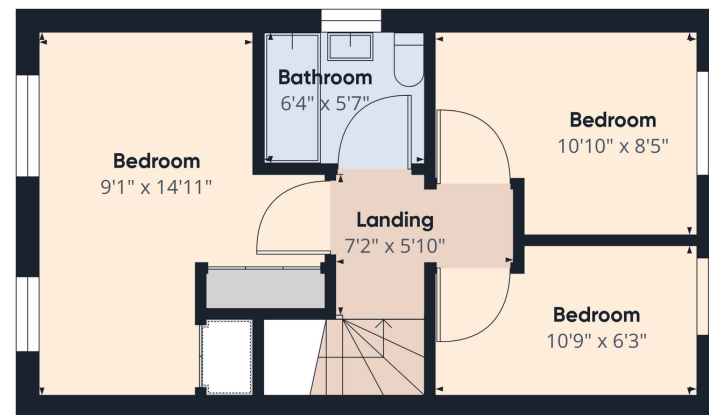

Floor 0



Floor 1



DESCRIPTION

Introducing this stunningly decorated 3-bedroom semi-detached home, which is sure to leave you impressed. This property boasts an elegant interior design that is tastefully done to complement modern living. The large patio doors allow for natural light to flood into the living area, creating a bright and welcoming atmosphere. As you step outside, a large private garden awaits you, perfect for outdoor entertainment or relaxation. This is a rare opportunity to acquire a stylish and well-maintained property that is ideal for families or anyone seeking a comfortable and modern living space. Don't miss out on this amazing opportunity!

The property comprises of:

- Welcoming hallway
- Modern fitted kitchen with integrated appliances
- Bright and spacious lounge/diner
- Ground WC
- Master bedroom with fitted wardrobes
- Two further bedrooms
- Family bathroom
- Private rear garden
- Driveway

Viewing by appointment with Gibson Estate Agents 0131 297 3177



LOCATION

Situated approximately seven miles south of Edinburgh city centre, the village of Roslin is loved by locals and visitors alike for its rich heritage. Local amenities include a choice of shops, a post office, a library, a medical centre and a dental practice, as well as a selection of traditional pubs, restaurants and hotels. More shopping facilities are available at nearby Straiton Retail Park, which has a variety of highstreet stores, major supermarkets and family restaurants. Roslin is the perfect base for exploring the great Scottish outdoors thanks to its scenic setting on the river North Esk, Roslin Glen Country Park and a wooded glen in the North Esk Valley. It also offers woodland trails and walks to historic Rosslyn Chapel, Rosslyn Castle and Wallace's Cave. Primary schooling is provided locally at Roslin Primary School, followed by secondary education at nearby Beeslack Community High School. Popular with commuters, Roslin enjoys easy access to Edinburgh City Bypass, as well as Edinburgh Airport, the Forth Road Bridge and the M8/M9 motorway network. The village is also served by fast and frequent public transport links travelling into the capital.

