



Park Road  
Sandhurst, GU47 9AA  
£475,000 Guide Price

## Property Details

 3 bedrooms

 1 baths

 EPC Rating TBC

 1,408 sq ft

 Station Name (0.0 miles)

- NO ONWARD CHAIN
- Three bedrooms
- Living room
- Dining room
- Kitchen and Utility room
- Mature rear garden
- Driveway parking and garage
- Located near to the hub of Sandhurst
- Attractive open countryside at Sandhurst memorial park and Shepherds Meadow

Brought to the market with no onward chain this three bedroom chalet bungalow is in this very sought after road near to the hub of Sandhurst and benefiting from a mature rear garden as well as driveway parking leading to a garage. The property has a living room and dining room as well as a galley kitchen and a utility room. There are two double bedrooms on the ground floor as well as a bathroom. The stairs lead to the main bedroom on the first floor. Sandhurst itself benefits from a range of shops and amenities as well as railway station and beautiful open countryside at Sandhurst memorial park and Shepherds Meadow.



## Property Details

### Park Road

Approximate Gross Internal Area = 130.8 sq m / 1408 sq ft (excludes garage)

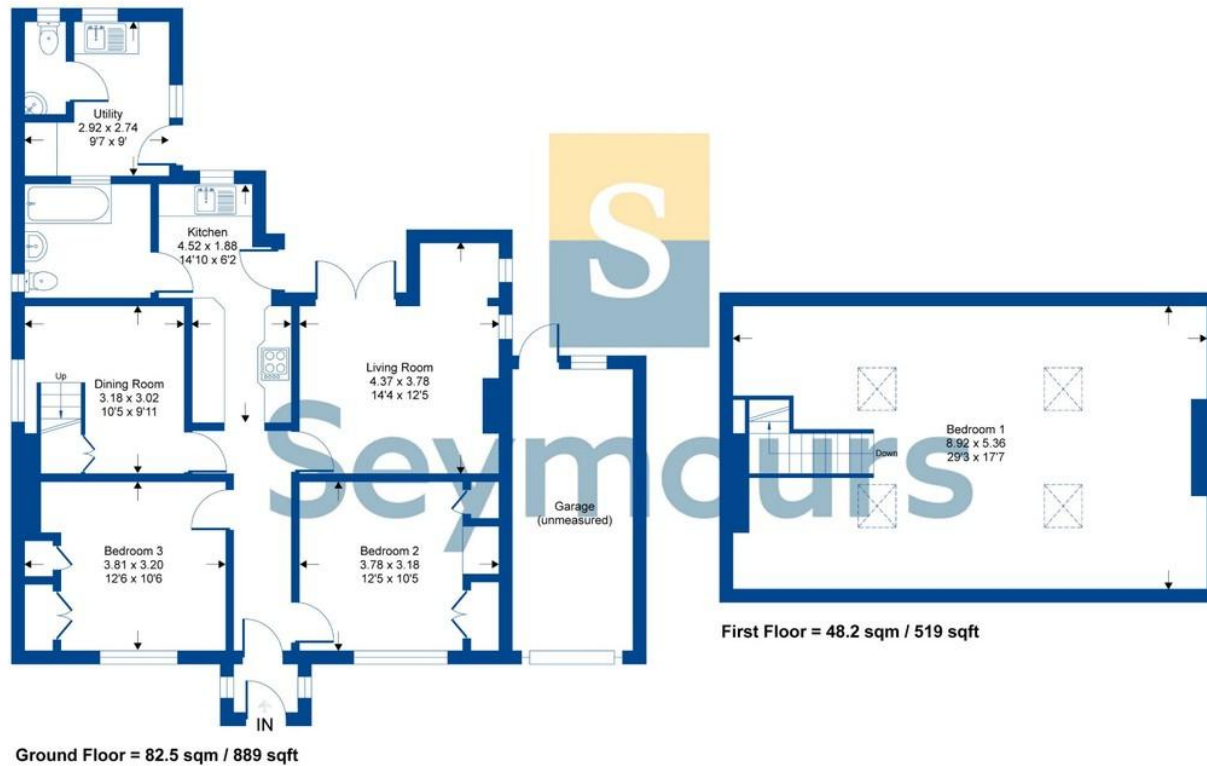

Whilst every attempt has been made to ensure the accuracy of the floor plan contained here, measurements of doors, windows, rooms and any other items are approximate and no responsibility is taken for any error, omission or mis-statement. This plan is for illustrative purposes only and should be used as such by any prospective purchaser.



Seymours Blackwater Office 6 Kings Parade, 34 London Road, Blackwater, Camberley, Surrey, GU17 9AA

01276 534100 / james@seymours-blackwater.co.uk / seymours-estates.co.uk

The information contained in these Sales Particulars does not form part of any contract neither is any warranty given or implied by Seymours or their clients as to the accuracy of measurements of details stated. Every effort is made to ensure that our Sales Particulars are correct and reliable. We do not test service, systems and appliances and we are unable to verify they are in working order.