





Woodville Close
Camberley, GU17 0BN
£540,000

Property Details

 4 bedrooms

 Bathroom and cloakroom

 EPC Rating C

 1669 sq feet inc garage

 Station Blackwater 1 mile

- Four double bedrooms
- Two reception rooms and kitchen
- Private rear garden
- Select close in Darby Green between Blackwater and Yateley
- Garage and driveway parking for several cars
- Good local schools close by
- Excellent transport links
- Attractive countryside at Blackwater nature reserve and Hawley woods
- Council tax band E currently £2331.86 per annum

A detached family home which is ideally situated in Darby Green located between Blackwater and Yateley. The property offers a well proportioned home to the incoming purchaser which is also tucked away in this small close offering a private and enclosed garden as well as a garage and driveway parking for several cars. The property has been well maintained by the current owners with downstairs space incorporating a spacious living room as well as a dining room, kitchen and downstairs cloakroom. All four bedrooms can be classed as double bedrooms and there is also a modern family bathroom. A particular feature of the area is the good schools as well as attractive countryside at Hawley Woods and Blackwater nature reserve. There are also good transport links with a station at Blackwater as well as excellent road links and an abundance of local shops and amenities at Blackwater and Yateley.



Property Details

Woodville Close

Approximate Gross Internal Area = 137.4 sq m / 1480 sq ft
 Approximate Garage Internal Area = 17.5 sq m / 189 sq ft
 Approximate Total Internal Area = 154.9 sq m / 1669 sq ft

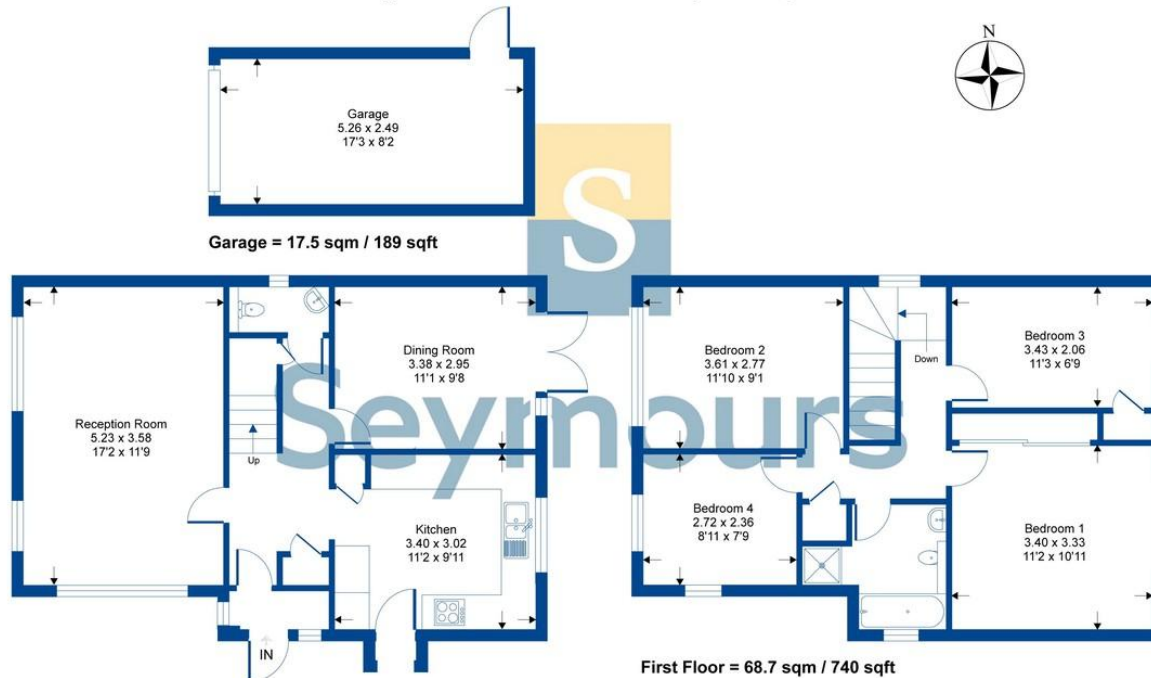

Whilst every attempt has been made to ensure the accuracy of the floor plan contained here, measurements of doors, windows, rooms and any other items are approximate and no responsibility is taken for any error, omission or mis-statement. This plan is for illustrative purposes only and should be used as such by any prospective purchaser.



Seymours Blackwater Office 6 Kings Parade, 34 London Road, Blackwater, Camberley, Surrey, GU17 9AA

01276 534100 / james@seymours-blackwater.co.uk / seymours-estates.co.uk

The information contained in these Sales Particulars does not form part of any contract neither is any warranty given or implied by Seymours or their clients as to the accuracy of measurements of details stated. Every effort is made to ensure that our Sales Particulars are correct and reliable. We do not test service, systems and appliances and we are unable to verify they are in working order.