



Seymours



Ryecroft Gardens Camberley, GU17 0JA £350,000

Arrange a viewing: 01276 534100

Property Details

 3 bedrooms

 1 baths

 EPC Rating TBC

 732 sqft

 Blackwater (0.4 miles)

- Very convenient location.
- Three bedrooms
- Kitchen breakfast room
- Living room
- Modern bathroom
- Rear garden
- Garage in a block
- Conveniently located for Blackwater shops and amenities
- Near to Blackwater nature reserve

A three bedroom home which benefits from a kitchen/breakfast room and a good living room with access onto the mature rear garden. The property also benefits from a garage in a nearby block. The situation of the house is particularly convenient for Blackwater and the local shops ,amenities and railway station as well as good local schools and attractive countryside at Blackwater nature reserve nearby.

[01276 534100](tel:01276534100) / james@seymours-blackwater.co.uk



Ryecroft Gardens

Approximate Gross Internal Area = 68 sq m / 732 sq ft

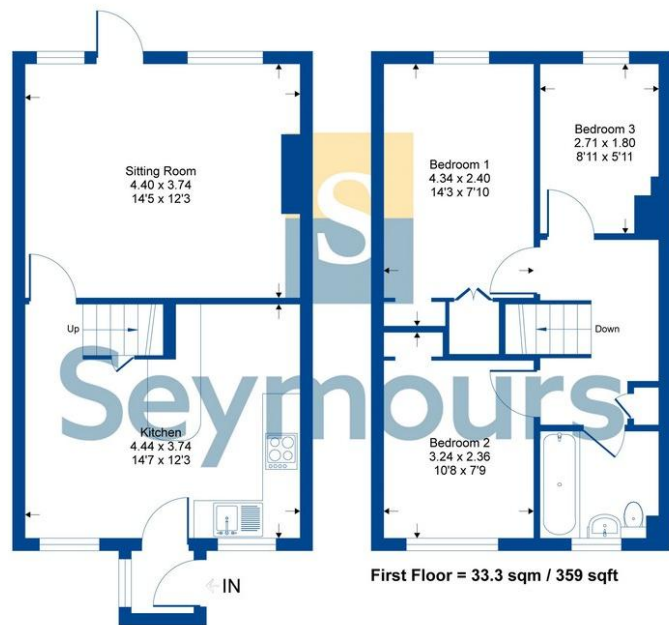

First Floor = 33.3 sqm / 359 sqft

Ground Floor = 34.5 sqm / 372 sqft

Whilst every attempt has been made to ensure the accuracy of the floor plan contained here, measurements of doors, windows, rooms and any other items are approximate and no responsibility is taken for any error, omission or mis-statement. This plan is for illustrative purposes only and should be used as such by any prospective purchaser.