



Seymours



Lower Moor Yateley, GU46 6HF £395,000

Arrange a viewing: 01276 534100

Property Details

- 3 bedrooms
- 1 baths
- EPC Rating TBC
- 760 sqft
- Sandhurst Station (2.3 miles)

- Three bedrooms
- Modern kitchen
- Living room with access to lovely garden
- Cloakroom
- Parking and garage
- Situated close to Yateley village and hub
- Attractive open countryside close by
- Good local schools
- Council tax band D

An attractive three bedroom home ideally situated and tucked away in this popular close in Yateley. The property benefits from a modern kitchen as well as a downstairs cloakroom with a living room having access out onto the beautiful cottage garden. Upstairs benefits from two good double bedrooms as well as a third bedroom and a modern bathroom. To the front of the house is allocated parking for one car as well as to the side of the property through the archway is a garage as well.

[01276 534100](tel:01276534100) / james@seymours-blackwater.co.uk



Lower Moor

Approximate Gross Internal Area = 70.6 sq m / 760 sq ft
Approximate Outbuilding Internal Area = 0.5 sq m / 6 sq ft
Approximate Total Internal Area = 71.1 sq m / 766 sq ft
(excludes garage)

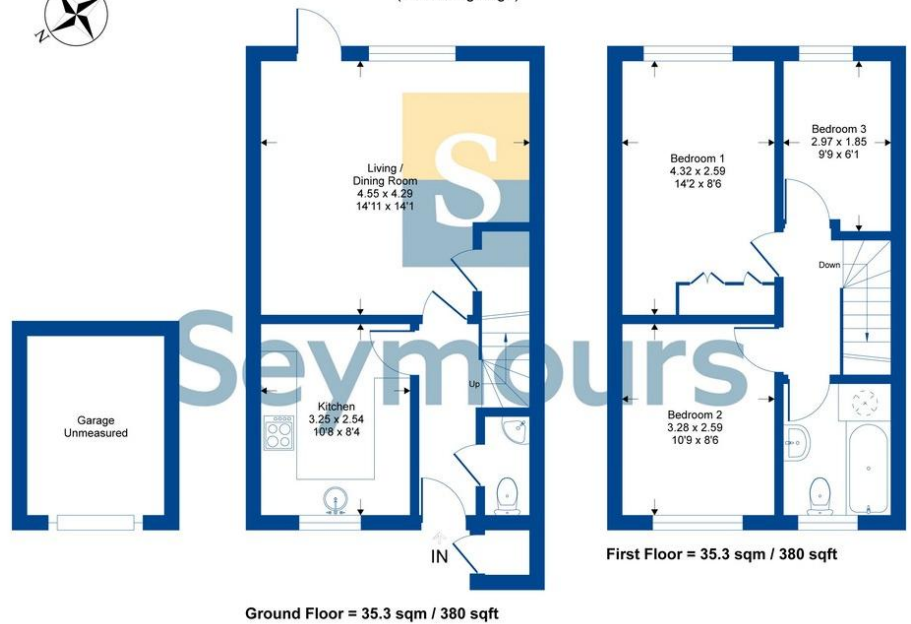

Whilst every attempt has been made to ensure the accuracy of the floor plan contained here, measurements of doors, windows, rooms and any other items are approximate and no responsibility is taken for any error, omission or mis-statement. This plan is for illustrative purposes only and should be used as such by any prospective purchaser.